

SOUTH MEADOW

AMBROSDEN

South Meadow

Ambrosden

This beautifully presented four-bedroom home offers a versatile layout over two floors, ideal for modern family living. Tucked away off a quiet one-way street in the popular village of Ambrosden, the property enjoys close proximity to excellent local amenities and schools. Early viewing is highly recommended.

The welcoming entrance hallway leads to a well-proportioned sitting room, filled with natural light from a large bay window. A separate formal dining room with double doors opens onto the private rear garden, perfect for entertaining. The spacious kitchen provides ample storage and worktop space, complemented by a utility room with side access and a convenient downstairs cloakroom.

Upstairs are four bedrooms, including a luxurious master with vaulted ceiling and en-suite, alongside a modern family bathroom. Outside, there is a garage, driveway parking, and a generous garden with patio and gated rear access.



4



2



2



Private Garden

GUIDE PRICE

£495,000





Approximate Gross Internal Area = 119.2 sq m / 1283 sq ft

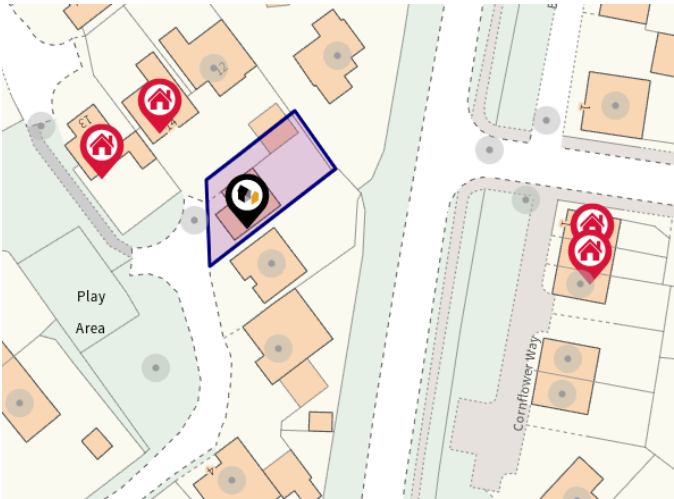
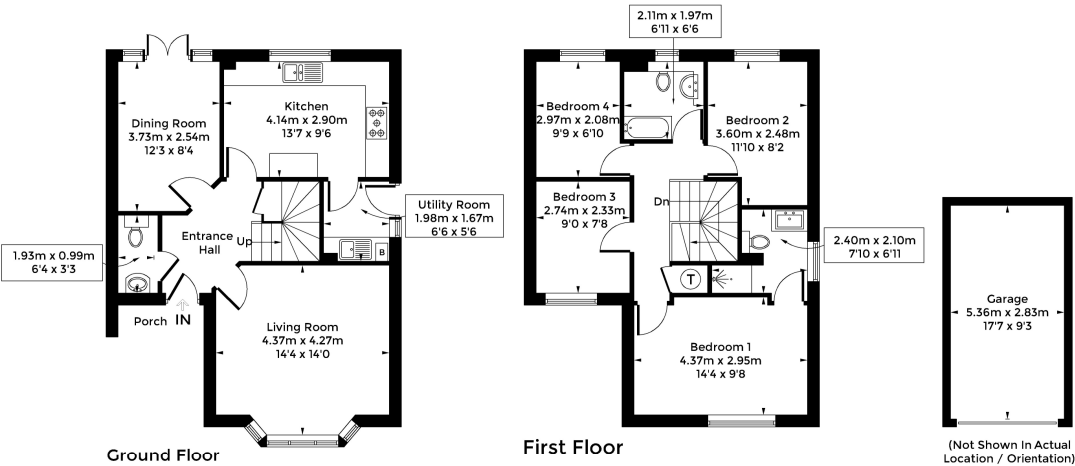

Council Tax:
Band E - £3,011.40

Parking:
Driveway

Local Authority:
Cherwell District Council

Score	Energy rating	Current	Potential
92+	A		
81-91	B		85 B
69-80	C	71 C	
55-68	D		
39-54	E		
21-38	F		
1-20	G		

LOCATION COMMENT

Ambrosden is a small, peaceful village located in the Cherwell district of North Oxfordshire, 3 miles south of Bicester and 13 miles north of Oxford.

Surrounded by rolling fields, the village offers convenient local amenities, including The Turner Arms Pub, a post office, hair salon, and Five Acres Primary School. Good transport links into London via Bicester North railway station and Bicester Village station mean you can be at Marylebone Station in just under an hour. Bicester town centre offers a great choice of restaurants, a cinema and Sainsbury's supermarket. Internationally acclaimed Bicester Village designer outlet, and Bicester Shopping Park including an M&S Food Hall, and David Lloyd health club can all be found on the edge of the town.



OUR NETWORK OF OFFICES ACROSS OXFORDSHIRE

Breckon & Breckon
est.1947



Every office has access to
every buyer registered across
our network of seven offices.

Sharing a single database of
buyers ensures maximum
exposure for our clients.

Bicester Sales & Lettings

30 Market Square
Bicester
Oxfordshire
OX26 6AG

t: 01869 24 24 23
e: bicester@breckon.co.uk



FROM LEFT:
Laura Conaty, Maxine Reynolds,
Ken Cunha Lin

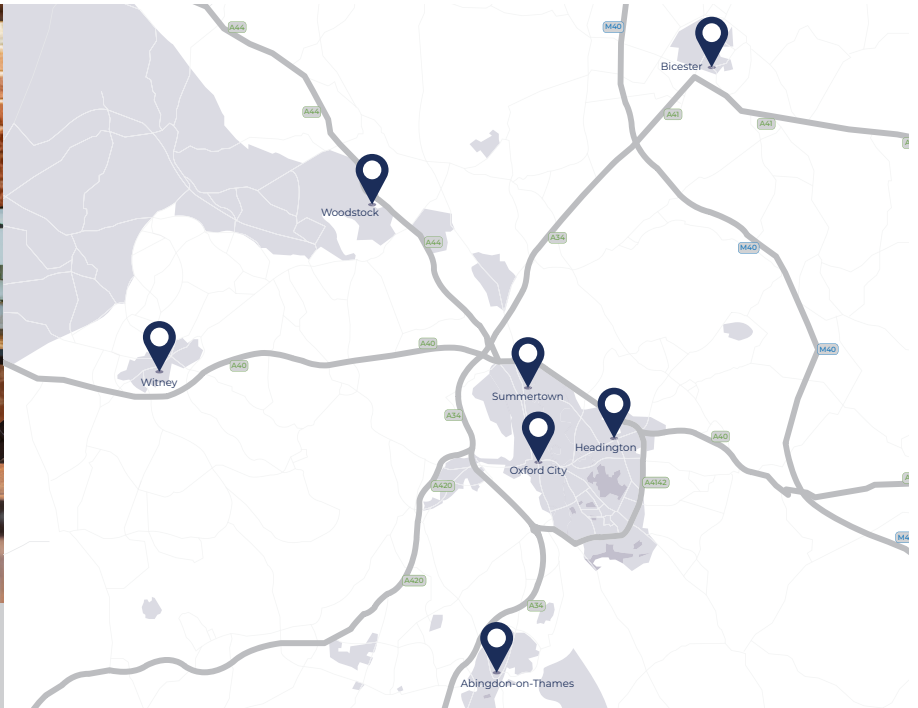

Summertown

t: 01865 310 300 (sales)
t: 01865 20 1111 (letting)
e: summertown@breckon.co.uk

Oxford City Centre

t: 01865 244 735 (sales)
t: 01865 20 1111 (letting)
e: post@breckon.co.uk

Headington

t: 01865 750 200 (sales)
t: 01865 763 999 (letting)
e: headington@breckon.co.uk

Abingdon-on-Thames

t: 01235 550 550 (sales)
t: 01235 554 040 (letting)
e: abingdon@breckon.co.uk

Woodstock

t: 01993 811881 (sales)
t: 01993 810 100 (letting)
e: woodstock@breckon.co.uk

Witney

t: 01993 776 775 (sales)
t: 01993 899 972 (letting)
e: witney@breckon.co.uk

New Homes

t: 01865 261 222
e: newhomes@breckon.co.uk

Land Team

t: 01865 558 999
e: land@breckon.co.uk

Letting and Property Management

t: 01865 20 1111
e: lettings@breckon.co.uk

Creative Department

t: 01865 310 300
e: creative@breckon.co.uk

Bespoke by Breckon

t: 01865 765 555
e: bespoke@breckon.co.uk



IMPORTANT NOTICE: These particulars are for information purposes only and do not in whole or in part constitute or form part of any offer or contract, nor should any statement obtained herein be relied upon as a statement or representation of fact. Breckon & Breckon do not test whether the services connected to the property, heating systems and domestic appliances are in working order. We therefore recommend that the purchaser obtains verification from their surveyor or solicitor. Whilst every attempt has been made to ensure the accuracy of the floor plans contained here, measurements of doors, windows and rooms are approximate and no responsibility is taken for any error, omission or mis-statement. These plans are for representation purposes only as defined by the RICS code of measuring practice and should be used as such by any possible purchaser.