

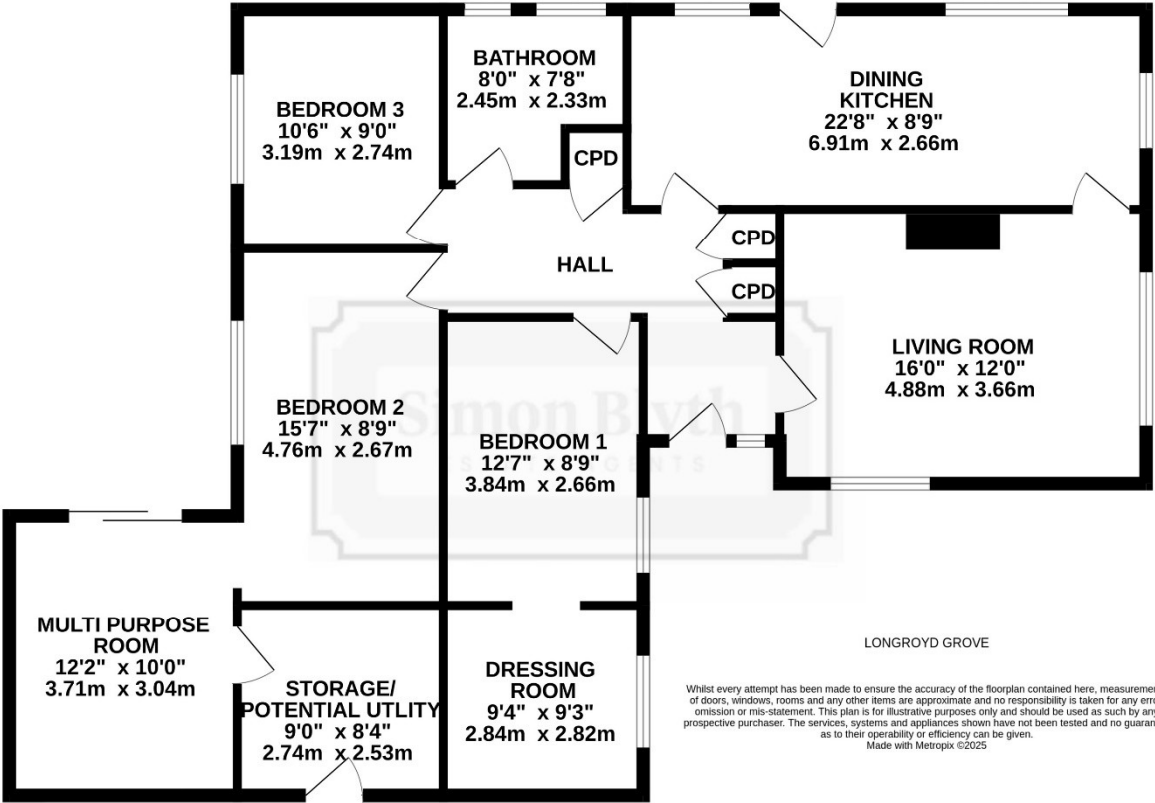

**10 LONGROYDE GROVE, BRIGHOUSE, HD6 3US**







## PROPERTY DESCRIPTION

Situated within a small Cul de sac and occupying a corner plot, a spacious detached three bedroomed true bungalow with attractively presented and well-appointed accommodation.

The bungalow was rewired with certificate in 2025 along with a new kitchen and bathroom in 2024/25. There is pvcu double glazing, gas central heating with boiler replaced in 2023 and accommodation briefly comprising entrance hall, living room, dining kitchen, bathroom, storeroom/utility, master bedroom with dressing room and two further bedrooms one of which has a multipurpose room off with patio doors opening onto the garden, this could be utilised as a study, snug, games room etc.

There is a herringbone block paved drive and further flagged driveway which provides off road parking together with gardens to front side and rear. There are local shops and supermarkets in Brighouse Town Centre, together with a railway station, good schools and accessible for junctions 24/25 of the m62.

**OFFERS AROUND £325,000**

### ENTRANCE HALL

This has Pvcu frosted and leaded stained-glass door with adjacent Pvcu frosted and leaded double-glazed window, there are two ceiling light points, loft access, central heating radiator, cupboard housing a Worcester gas fired combination central heating boiler fitted in 2023, adjacent to this there is a useful storage cupboard and a cloaks cupboard with cloaks rail and shelving. From the hallway access can be gained to the following rooms: -



### LIVING ROOM

*Measurements – 16'0" x 12'0"*

As the dimensions indicate this is a spacious and well-proportioned reception room which has dual aspect, Pvcu double glazed windows which provide plenty of natural light, access to the living room is from the hallway or dining kitchen through timber and bevelled glass doors. There is a ceiling light point, two central heating radiators and as the main focal point of the room housed within the chimney breast there is a coal effect gas fire with marble surround and raised marble hearth.





## DINING KITCHEN

*Measurements – 22'8" x 8'9"*

Another well proportioned room which once again has a dual aspect Pvcu double glazed windows to the front and side elevations, in addition there is a pvcu and frosted double glazed door giving access to the side of the bungalow. There are two ceiling light points, central heating radiator, oak effect laminate flooring and having a range of shaker style base and wall cupboards, pan drawers, contrasting over lying oak effect worktops with inset one and a half bowl single drainer stainless steel sink with chrome mixer tap, four ring stainless steel gas hob with stainless steel extractor hood over, integrated stainless steel electric fan assisted oven and combi oven, housing for fridge freezer, integrated dishwasher and breakfast bar.







## BEDROOM ONE

Measurements- 12'7" x 8'9"

A double room which has pvcu double glazed window, ceiling light point, central heating radiator and to one side a doorway provides access to a dressing room.

## DRESSING ROOM

Measurements- 9'4" X 8'3"

With pvcu double glazed window, ceiling light point, loft access and having fitted floor to ceiling cupboards.





## BEDROOM TWO

Measurements-15'7" x 8'9"

Another good sized double room which has pvcu double glazed window looking out over the rear garden, there is a ceiling light point, central heating radiator and to one side a doorway gives access to a multipurpose room.



### BEDROOM THREE

Measurements- 10'6" x 9'0"

Double room with pvcu double glazed window looking out over the rear garden. There is a ceiling light point and central heating radiator.







### **MULTIPURPOSE ROOM**

*Measurements- 12'2" x 10'0"*

This could be used as a sitting room, study, games room etc and has pvcu double glazed sliding patio doors which provide access to the rear garden. There is a central heating radiator, ceiling light point and to one side a door gives access to a storeroom or potential utility room.

### **STOREROOM**

*Measurements- 8'4" x 9'0"*

This has a pvcu frosted double glazed door giving access to the side of the property there is a ceiling light point and plumbing for automatic washing machine.

## BATHROOM

*Measurements- 8'0" x 7'8"*

With two frosted pvcu double glazed windows, ceiling light point, extractor fan, part tiled walls, tiled floor, chrome ladder style heated towel rail and fitted with a suite comprising vanity unit incorporating wash basin with chrome mono block tap, low flush wc and panelled bath with glazed shower screen and chrome mixer tap together with chrome shower fitting including fixed shower rose and separate hand spray.





## OUTSIDE

### PARKING

To the left hand side of the bungalow there is a herringbone block paved driveway and further flagged driveway which provides off road parking for four cars.





## GARDENS

These are laid out to three sides. To the front there is a lawn with planted shrubs to the borders. To the far left hand side of the driveway there is a further lawned area with planted trees and shrubs together with an outside cold water tap. A pathway leads across the rear giving access to a flagged patio which can be accessed from the multipurpose room and this has raised borders. To the far side of the property there is a flagged pathway with planted shrubs to the borders and from here there is a door giving access to the dining kitchen.







### **ADDITIONAL INFORMATION**

EPC rating – D

Property tenure – Freehold

Local authority – Calderdale Council

Council tax band – D

Double glazing- The property has pvcu double glazing

Central heating- Property has a gas fired central heating system with a new boiler replaced in 2023.

Wiring- The property was rewired along with a certificate in February 2025.

Kitchen- The kitchen was refitted in March 2025.

Bathroom- This was refitted in December 2024.

Carpets- These were replaced in December 2024.

### **BOUNDARY OWNERSHIP**

The boundary ownerships and tenure of the property have not been checked on the title deeds for any discrepancies or rights of way if any (This is a standard statement on all our brochures due to the Property Misdescription's Act)

### **COPYRIGHT**

Unauthorised reproduction prohibited.

### **FREE VALUATIONS**

If you are thinking of a move then take advantage of our FREE valuation service, telephone our nearest office for a prompt and efficient service.

### **CONSUMER PROTECTION FROM UNFAIR TRADING REGULATIONS 2008**

Simon Blyth for themselves and for the vendors or lessors of this property, whose agent they are, have made every effort to ensure the details given have been prepared in accordance with the above act and to the best of our knowledge give a fair and reasonable representation of the property. Please note:

1. There is a six inch measurement tolerance or metric equivalent and the measurements given should not be entirely relied upon and purchasers must make their own measurements if ordering carpets, curtains or other equipment.

2. None of the main services, i.e. gas, water, electricity, drainage or central heating system (if any) have been tested in any way whatsoever. This also includes appliances which are to be left in situ by the vendors.

PURCHASERS MUST SATISFY THEMSELVES AS TO THE CONDITION AND EFFECTIVENESS OF ANY SUCH APPLIANCES OR SERVICES

FLOOR PLANS NOT TO SCALE - FOR IDENTIFICATION PURPOSES ONLY

### **MAILING LIST**

---



Keep up to date with all our new properties. Let us know your price range, the area and type of home you require by registering on our mailing list.

### **MORTGAGE ADVICE**

Simon Blyth Estate Agents understand that getting appropriate mortgage advice is a crucial part of the home buying process. Finding a suitable mortgage has always been something of a daunting experience which is why we would like to introduce you to our independent mortgage advisors. They provide tailored mortgage solutions through a wealth of experience in the mortgage and property market and offer access to the full unrestricted range of products available.

Our advisors are dedicated to providing ongoing guidance and advice throughout the entire house purchase process keeping you, your estate agent and solicitor involved with continual updates on the progress. Once in your new home they will be available for ongoing support to build a long-term relationship for your future mortgage planning. Your home may be repossessed if you do not keep up repayments on your mortgage.

For friendly expert advice on your mortgage requirements, or to discuss the potential of making your ideas a reality then please call in or phone for a chat.

### **OFFICE OPENING TIME 7 DAYS A WEEK**

Monday to Friday - 8.45 to 17:30

Saturday - 9:00 to 16:30

Sunday - 11:00 to 16:00

---



### MAIN CONTACTS

T: 01484 651878

W: [www.simonblyth.co.uk](http://www.simonblyth.co.uk)

E: [huddersfield@simonblyth.co.uk](mailto:huddersfield@simonblyth.co.uk)

### OFFICE OPENING TIMES

#### 7 DAYS A WEEK

Monday to Friday - 8.45 to 17:30

Saturday - 9:00 to 16:00

Sunday - 11:00 to 14:00



**[WWW.SIMONBLYTH.CO.UK](http://WWW.SIMONBLYTH.CO.UK)**

Wakefield  
01924 361631

Huddersfield  
01484 651878

Holmfirth  
01484 689689

Kirkburton  
01484 603399

Penistone  
01226 762400

Sheffield  
01143 216 590

Barnsley  
01226 731730

Pontefract  
01977 800259