



# 4 MILL STREET

WITNEY OX28 6DG



# 4 Mill Street

Witney OX28 6DG

Breckon & Breckon  
est.1947

**GUIDE PRICE £280,000**



Located within easy reach of the town's amenities and bus links this period home is being sold with no onward chain. The spacious accommodation includes an entrance hall, sitting room to the front and super second reception that overlooks the garden. A modern kitchen to the rear offers a range of units, built-in oven, hob and space for white goods. Two good size light and airy bedrooms plus a contemporary fitted bathroom sit on the first floor.

Externally, the property enjoys a patio area ideal for sunny alfresco entertaining and leads to an enclosed garden laid mainly to lawn. There is pedestrian right of way across the rear of the terrace. This lovely home has been well looked after over the years and is ready for a fresh look from the new owner. A great opportunity to enjoy period living within minutes of the bustling town centre.

## AGENTS COMMENT

*An easy stroll to the town centre and with no onward chain, this is a fabulous opportunity for a first home or investment purchase. A viewing is recommended.*

 **2**     **2**     **1**

 **Delightful**



Approximate Gross Internal Area 76.50 sq.m / 823 sq.ft



Every office has access to every buyer registered across our network of seven offices.

Sharing a single database of buyers ensures maximum exposure for our clients.

## Witney Sales

10 Market Square  
Witney Oxfordshire  
OX28 6BB

t: 01993 776 775  
e: witney@breckon.co.uk

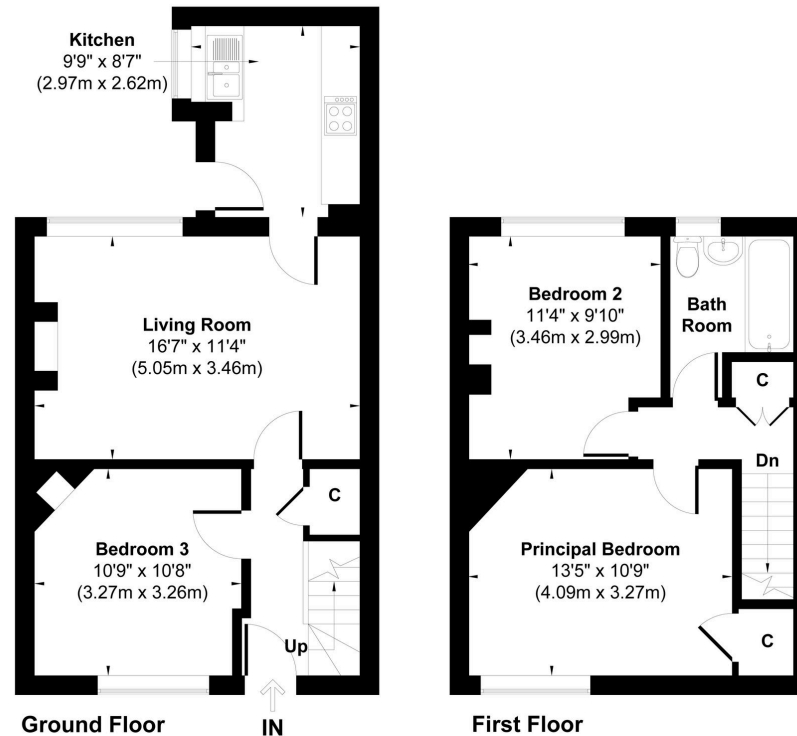

Illustration for identification purpose only, measurements approximate and not to scale.

**Summertown**  
t: 01865 310 300 (sales)  
t: 01865 20 1111 (letting)  
e: summertown@breckon.co.uk

**Oxford City Centre**  
t: 01865 244 735 (sales)  
t: 01865 20 1111 (letting)  
e: post@breckon.co.uk

**Headington**  
t: 01865 750 200 (sales)  
t: 01865 763 999 (letting)  
e: headington@breckon.co.uk

**Abingdon-on-Thames**  
t: 01235 550 550 (sales)  
t: 01235 554 040 (letting)  
e: abingdon@breckon.co.uk

**Woodstock**  
t: 01993 811 881 (sales)  
t: 01993 810 100 (letting)  
e: woodstock@breckon.co.uk

**Bicester**  
t: 01869 242 423 (sales & letting)  
e: bicester@breckon.co.uk

**New Homes**  
t: 01865 261 222  
e: newhomes@breckon.co.uk

**Land Team**  
t: 01865 558 999  
e: land@breckon.co.uk

**Letting and Property Management**  
t: 01865 20 1111  
e: lettings@breckon.co.uk

**Creative Department**  
t: 01865 310 300  
e: creative@breckon.co.uk

**Bespoke by Breckon**  
t: 01865 765 555  
e: bespoke@breckon.co.uk



John Bower Local Director

For an **up-to-date** valuation, please call me, I'd love to **help** you move.

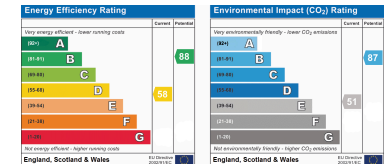

**Council Tax**  
Band C - £2,358.03

IMPORTANT NOTICE: These particulars are for information purposes only and do not in whole or in part constitute or form part of any offer or contract, nor should any statement domestic appliances are in working order. We therefore recommend that the purchaser obtains verification from their surveyor with property, heating systems to ensure the accuracy of the floor plans contained here. Measurements of doors, windows and rooms are approximate and no responsibility is taken for any error, omission or mis-statement. These plans are for representation purposes only as defined by the RICS code of measuring practice and should be used as such by any possible purchaser.