



# UPPER BARN

CANAL ROAD, THRUPP OX5 1JQ



# Upper Barn

Canal Road, Thrupp OX5 1JQ

Nestled in the heart of Thrupp, a desirable canal side hamlet renowned for its towpath walks, two popular public houses and a traditional tea shop. This quintessential characterful home combines perfectly charm, stylish decor and modern comfort with the additional benefit of approx. 5.29 acre plot. Upper Barn offers 2,496 sq ft of light-filled living space set across two floors with the welcoming hall just the beginning of the delights that follow.

Outside, the truly lovely garden has been well-tended over the years and is home to an expanse of lawn, and a host of mature shrubs and trees. The gardens enjoy a high degree of privacy and provide a fine space to unwind and enjoy some alfresco entertaining on the large patio. In addition to the delightful garden there is a paddock, in all approximately 5.29 acres.

## GUIDE PRICE

**£1,250,000**



**5**



**3**



**2**



**5.29 ACRE  
PLOT**





Approximate Gross Internal Area  
 Main House = 231.88 sq.m / 2496 sq.ft  
 Garage = 30.82 sq.m / 332 sq.ft  
**Total = 262.70 sq.m / 2828 sq.ft**

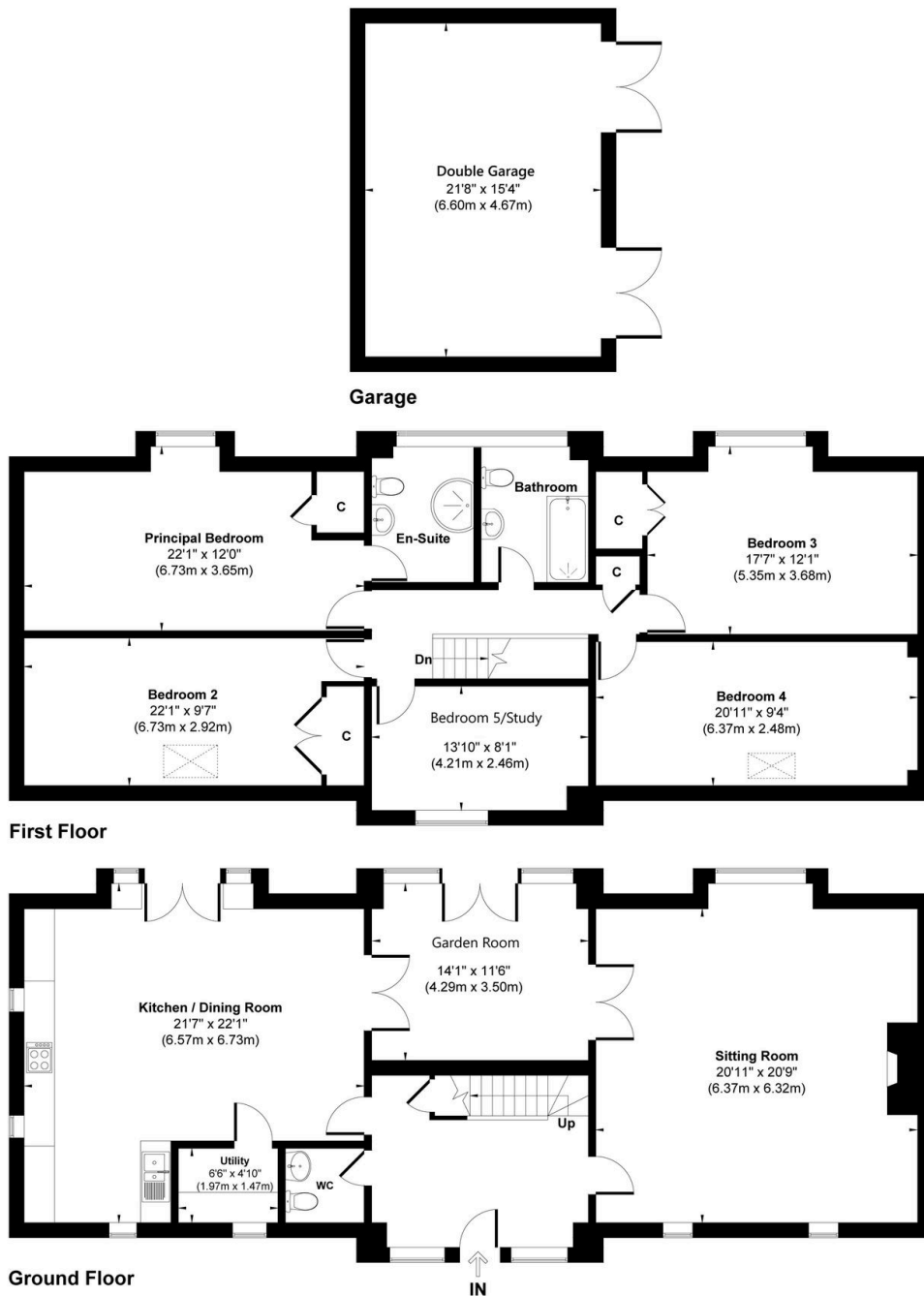

Illustration for identification purpose only, measurements approximate and not to scale.

### Council Tax:

Band G - £4,413.43

### Parking:

Two Garages & Three Parking Spaces

### Local Authority:

Cherwell District Council



# LOCATION

*Thrupp is a picturesque village with two public houses, a popular tea room and scenic canal and countryside walks on the doorstep. Nearby Kidlington offers excellent amenities, and there are regular bus services into Oxford, and Oxford Parkway station provides rapid access to London Marylebone. Kidlington has a thriving community with a variety of pubs, restaurants, shops and supermarkets. There are several local schools in Kidlington with well regarded independent schools six miles away in Oxford. There is also excellent access to the A34 and M40 to London and Birmingham.*

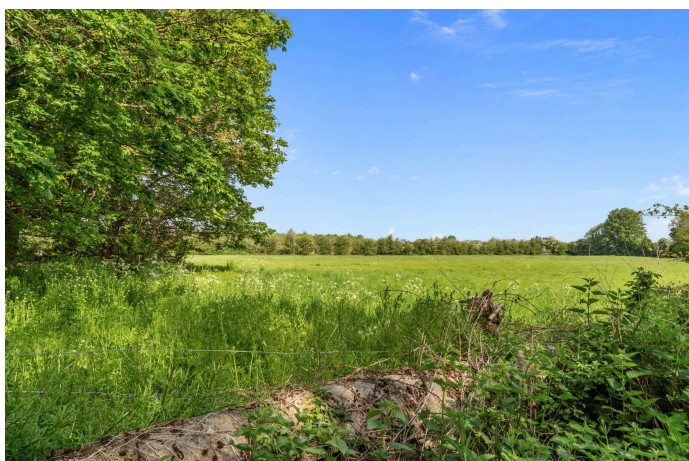

# OUR NETWORK OF OFFICES ACROSS OXFORDSHIRE

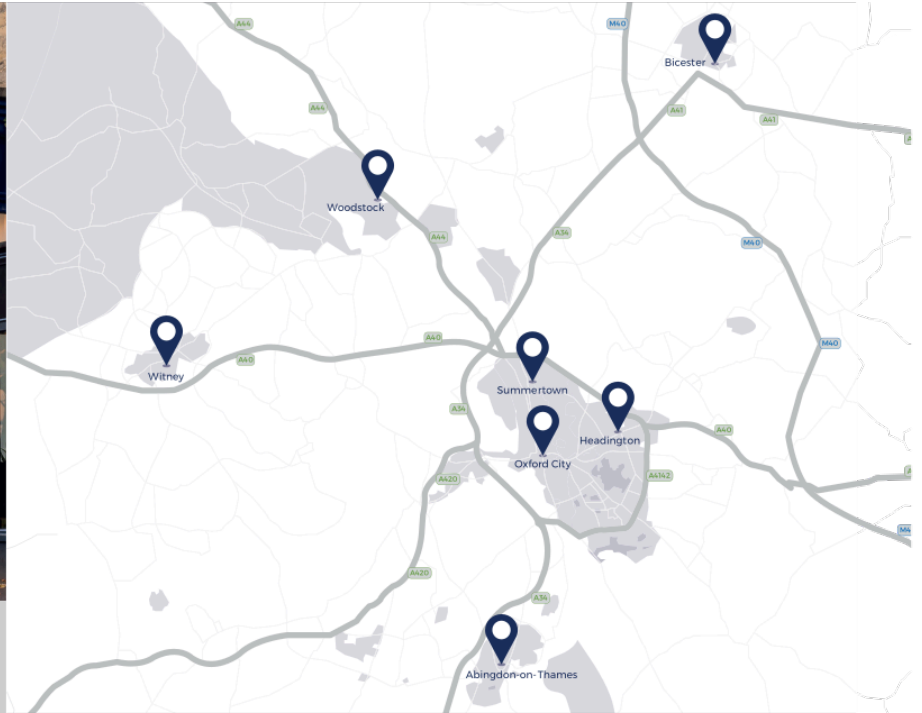

**Every office** has access to **every buyer** registered across our network of seven offices.

Sharing a single database of buyers ensures maximum exposure for our clients.

## Witney Sales

10 Market Square  
Witney  
Oxfordshire  
OX28 6BB

t: 01993 776 775  
e: [witney@breckon.co.uk](mailto:witney@breckon.co.uk)



FROM LEFT: Alex Chappell,  
Sarah Thomas, Julia Briggs,  
Rose McDermott and John Bouwer

## Summertown

t: 01865 310 300 (sales)  
t: 01865 20 1111 (letting)  
e: [summertown@breckon.co.uk](mailto:summertown@breckon.co.uk)

## Oxford City Centre

t: 01865 244 735 (sales)  
t: 01865 20 1111 (letting)  
e: [post@breckon.co.uk](mailto:post@breckon.co.uk)

## Headington

t: 01865 750 200 (sales)  
t: 01865 763 999 (letting)  
e: [headington@breckon.co.uk](mailto:headington@breckon.co.uk)

## Abingdon-on-Thames

t: 01235 550 550 (sales)  
t: 01235 554 040 (letting)  
e: [abingdon@breckon.co.uk](mailto:abingdon@breckon.co.uk)

## Woodstock

t: 01993 811 881 (sales)  
t: 01993 810 100 (letting)  
e: [woodstock@breckon.co.uk](mailto:woodstock@breckon.co.uk)

## Bicester

t: 01869 242 423 (sales & letting)  
e: [bicester@breckon.co.uk](mailto:bicester@breckon.co.uk)

## New Homes

t: 01865 261 222  
e: [newhomes@breckon.co.uk](mailto:newhomes@breckon.co.uk)

## Land Team

t: 01865 558 999  
e: [land@breckon.co.uk](mailto:land@breckon.co.uk)

## Letting and Property Management

t: 01865 20 1111  
e: [lettings@breckon.co.uk](mailto:lettings@breckon.co.uk)

## Creative Department

t: 01865 310 300  
e: [creative@breckon.co.uk](mailto:creative@breckon.co.uk)

## Bespoke by Breckon

t: 01865 765 555  
e: [bespoke@breckon.co.uk](mailto:bespoke@breckon.co.uk)



**IMPORTANT NOTICE:** These particulars are for information purposes only and do not in whole or in part constitute or form part of any offer or contract, nor should any statement obtained herein be relied upon as a statement or representation of fact. Breckon & Breckon do not test whether the services connected to the property, heating systems and domestic appliances are in working order. We therefore recommend that the purchaser obtains verification from their surveyor or solicitor. Whilst every attempt has been made to ensure the accuracy of the floor plans contained here, measurements of doors, windows and rooms are approximate and no responsibility is taken for any error, omission or mis-statement. These plans are for representation purposes only as defined by the RICS code of measuring practice and should be used as such by any possible purchaser.