



**GASCOIGNE
HALMAN**

20 BUCKINGHAM ROAD, WILMSLOW SK9 5LB

THE AREAS LEADING ESTATE AGENT



20 BUCKINGHAM ROAD, WILMSLOW SK9 5LB

£560,000

Occupying a generous corner plot, this attractive Cheshire Brick semi-detached property has been thoughtfully extended (1440 Sq Ft) boasting three double bedrooms, two bathrooms and a superb central position moments from Wilmslow town centre and Gorsey Bank Primary School. Sold with no vendor chain.



- Attractive Cheshire Brick Property
- Generous Corner Plot
- Thoughtfully Extended To Both Floors
- Three Double Bedrooms
- Two Bathrooms Including En-Suite To Main Bedroom
- Off-Road Parking And Detached Garage
- Excellent Scope To Enhance And Add-Value
- Sought-After Central Position Moments From Wilmslow Town Centre And Gorsey Bank Primary School



Buckingham Road is a sought-after residential road which enjoys a highly convenient location only a short stroll to Wilmslow town centre, Lindow Common and Gorse Bank Primary school as well as easy access to Manchester airport and useful transport links.

The property itself boasts attractive Cheshire Brick elevations and has been extended to both floors to create a spacious, light and airy property with plenty of scope to enhance further and add-value subject to the relevant permissions.

The accommodation comprises: entrance porch opening to a large entrance hallway with wood effect flooring, balustrade staircase leading to the first floor and useful storage facilities. To the front of the ground floor is a spacious living room with feature fireplace and attractive bay-window, sliding doors lead through to a separate dining room which offers sliding doors opening to the rear patio. A fully fitted kitchen is accessed via the dining room and leads through to the rear utility room, downstairs wc, private workshop and 21ft integral garage.

To the first floor the landing gives access to the three double bedrooms, bedrooms one and two both have their own range of fitted furniture/wardrobes whilst the main bedroom boasts it's own refitted en-suite shower room. A further separate family bathroom serves the remaining two bedrooms.

Externally the property enjoys a generous corner plot, with a driveway providing ample off-road parking, lawned garden, well-stocked borders and gated side access leading through to the integral garage.

In addition the property also comes with a large private garden to the side/rear with two separate private patio areas, perfect for Al fresco dining and summer BBQ's with well-stocked mature borders and hedged boundaries.

Sold with no chain.

LOCATION

Conveniently situated within easy reach of Wilmslow town centre with its excellent range of shops and general services, restaurants and cafes. There are good schools in the area, both State and Private, for children of all ages. Wilmslow railway station is on the main line to London Euston and also provides a regular service to Manchester and surrounding districts. The North West motorway network is within a short drive as is Manchester Airport and the A34 Wilmslow by-pass which provides access to the large stores at Handforth Dean and Cheadle including Marks & Spencer, Tesco, John Lewis and Sainsburys. Wilmslow has a leisure centre and there are also a number of private sporting clubs in the area.

DIRECTIONS

Sat-Nav: SK9 5LB

TENURE

Freehold. Subject to verification by solicitors.

SERVICES (NOT TESTED)

Services have not been tested and you are advised to make your own enquiries and/or inspections.

LOCAL AUTHORITY

Cheshire East. Property Band: D

VIEWING

Viewing strictly by appointment through the Agents.

FLOORPLAN & EPC

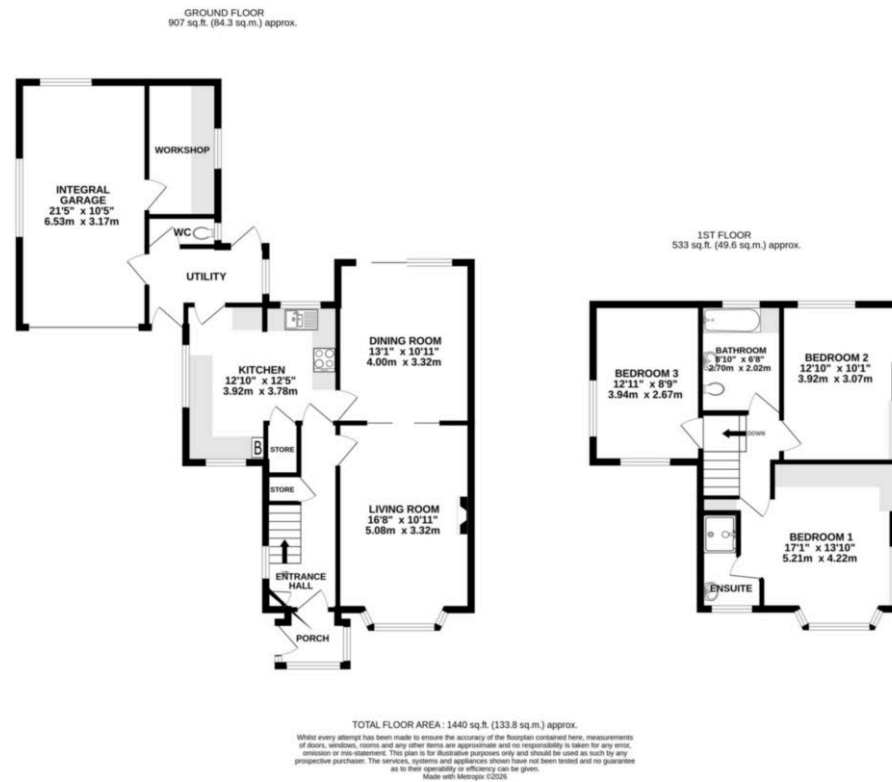

NOTICE Gascoigne Halman for themselves and for the vendors or lessors of this property whose agents they are give notice that: (i) the particulars are set out as a general outline only for the guidance of intending purchasers or lessees, and do not constitute, nor constitute part of, an offer or contract; (ii) all descriptions, dimensions, references to condition and necessary permissions for use and occupation, and other details are given in good faith and are believed to be correct but any intending purchasers or tenants should not rely on them as statements or representations of fact but must satisfy themselves by inspection or otherwise as to the correctness of each of them; (iii) no person in the employment of Gascoigne Halman has any authority to make or give any representation or warranty whatever in relation to this property.



WILMSLOW OFFICE

01625 536 434

wilmslow@gascoignehalman.co.uk

40 Alderley Road, Wilmslow, Cheshire, Wilmslow, SK9 1NY

**GASCOIGNE
HALMAN**