



PETERMANS
LOCAL PROPERTY EXPERTS



Eaton Court,
Edgware Way
Edgware
£215,000
Share Of Freehold

- One Bedroom, First Floor Apartment
- Bright Reception Room With Access To Balcony
- Fitted Kitchen
- New Shower Room
- Chain Free
- Warden Assisted
- 537 Sq Ft

8 THE PROMENADE, EDGWAREBURY LANE, EDGWARE, MIDDLESEX HA8 7JZ
t: 020 8958 5040 e: edgware@petermans.co.uk w: www.petermans.co.uk



Petermans for themselves and for the vendors or lessors of this property for whom they act, give notice that i) these particulars are a general outline only, for the guidance or prospective purchasers or tenants, and do not constitute the whole or any part of an offer or contract. ii) Petermans cannot guarantee the accuracy of any description, dimensions, references to condition, necessary permissions for use and occupation, and other details contained herein, and prospective purchasers or tenants must not rely on them as statements of fact, and must satisfy themselves as to their accuracy. iii) no employee of Petermans has any authority to make or give any or representation or warranty or enter into any contract whatever in relation to the property. iv) rents, prices, premiums and service charge quoted in these particulars may be subject to VAT in addition, and v) Petermans will not be liable, in negligence or otherwise, for any loss arising from the use of these particulars.



We are pleased to offer this Warden assisted block, one bedroom, first floor apartment. Situated in this sought after location, providing easy access to central Edgware, local shops, and places of worship. The property is offered chain free.



Energy Efficiency Rating		
	Current	Potential
Very energy efficient - lower running costs		
(92+) A		
(81-91) B	83	83
(69-80) C		
(55-68) D		
(39-54) E		
(21-38) F		
(1-20) G		
Not energy efficient - higher running costs		
England, Scotland & Wales	EU Directive 2002/91/EC	

The property comprises a reception room with access to own balcony at the front of the block, fitted kitchen, shower room. There is also communal lounge, kitchen, gardens and 24 hour warden assistance.

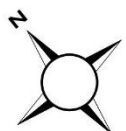

First Floor

Approx. 49.9 sq. metres (537.6 sq. feet)

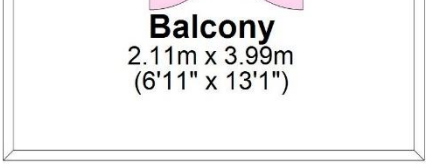
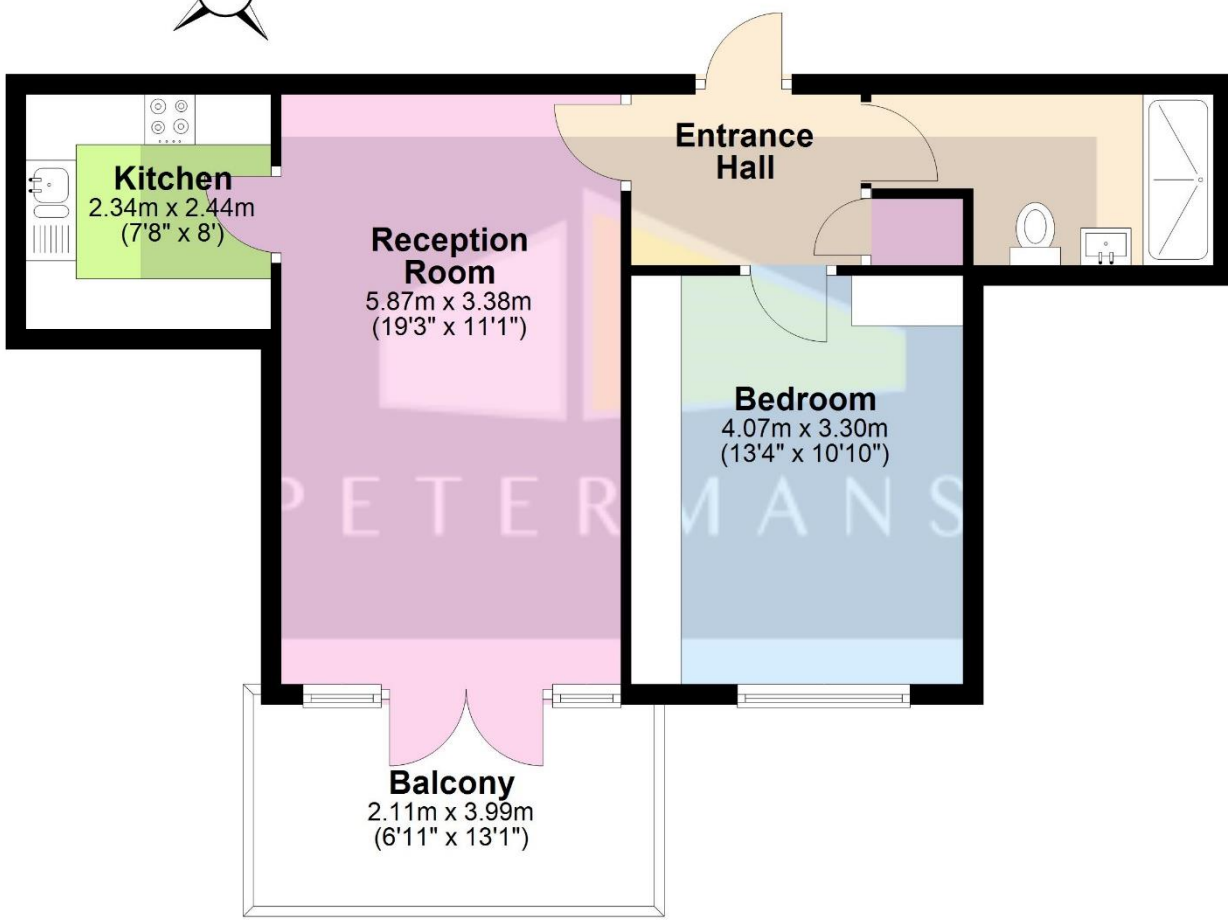

Total area: approx. 49.9 sq. metres (537.6 sq. feet)

VIEWING STRICTLY BY APPOINTMENT ONLY.

PETERMANS TEL: 020 8958 5040 Please Note That The Gas And Electric Appliances Have Not Been Tested To Ensure That They Are In Working Order. All Measurements Are Taken With A Laser Tape Measure And Therefore Subject To Some Variation. We Recommend Any Potential Purchaser Checks These For Themselves To Confirm Their Accuracy

- Guide Price: £215,000
- Tenure: share of freehold
- Beds: 1
- Baths: 1
- Reception Rooms: 1
- Total Sq Ft: 537
- Council Tax Band: Band D in Barnet
- EPC Rating: Band B
- Service Charge: £2,400 per annum
- Ground Rent: NA
- Distance to:
 Edgware Station: 0.7 Miles
 Stanmore Station: 1.1 Miles

