

PETERMANS
LOCAL PROPERTY EXPERTS



Heronsgate, Edgware £349,500 Leasehold

- Two Bedroom, Ground Floor Maisonette
- Bright Reception Room
- Fitted Kitchen/Breakfast Room
- Bathroom
- Highly Sought After Location With Easy Access To Local Shops & Edgware Station
- Direct Access To Own Section Of Rear Garden
- 703 Sq Ft

8 THE PROMENADE, EDGWAREBURY LANE, EDGWARE, MIDDLESEX HA8 7JZ
t: 020 8958 5040 e: edgware@petermans.co.uk w: www.petermans.co.uk



Petermans for themselves and for the vendors or lessors of this property for whom they act, give notice that i) these particulars are a general outline only, for the guidance or prospective purchasers or tenants, and do not constitute the whole or any part of an offer or contract, ii) Petermans cannot guarantee the accuracy of any description, dimensions, references to condition, necessary permissions for use and occupation; and other details contained herein, and prospective purchasers or tenants must not rely on them as statements of fact, and must satisfy themselves as to their accuracy, iii) no employee of Petermans has any authority to make or give any or representation or warranty or enter into any contract whatever in relation to the property, iv) rents, prices, premiums and service charge quoted in these particulars may be subject to VAT in addition, and v) Petermans will not be liable, in negligence or otherwise, for any loss arising from the use of these particulars.



We are delighted to offer this purpose built 2 bedroom ground floor maisonette, which is situated in central Edgware with Edgware Station and shops being only a few minutes walk away. The property also benefits from having direct access to its own section of rear garden.



The property comprises its own front door, reception room, fitted kitchen/breakfast room with a door leading to garden at the rear, two double bedrooms, bathroom. The property is ideal for first time buyers or as a buy to let.

Ground Floor

Approx. 65.3 sq. metres (703.3 sq. feet)

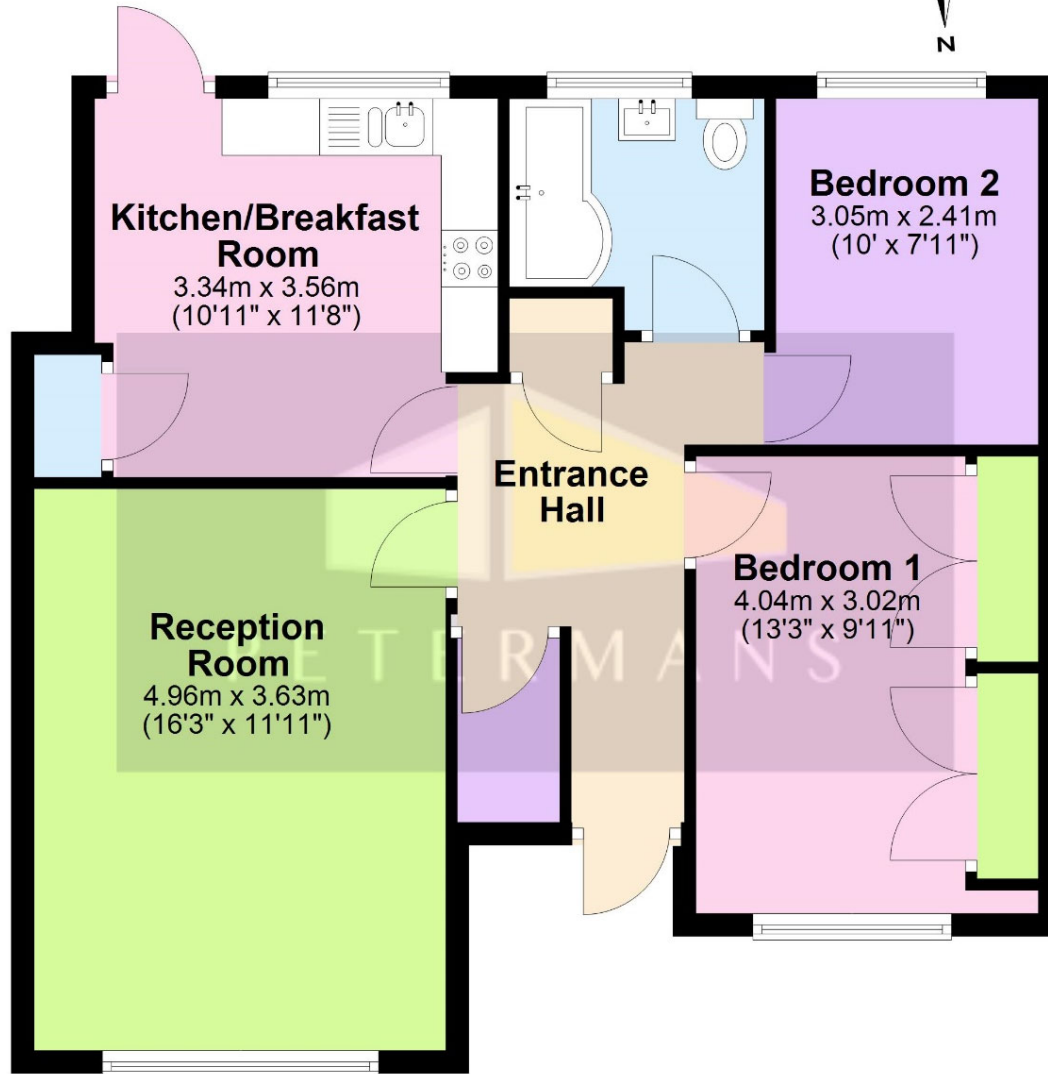

Total area: approx. 65.3 sq. metres (703.3 sq. feet)

VIEWING STRICTLY BY APPOINTMENT ONLY.

PETERMANS TEL: 020 8958 5040 Please Note That The Gas And Electric Appliances Have Not Been Tested To Ensure That They Are In Working Order. All Measurements Are Taken With A Laser Tape Measure And Therefore Subject To Some Variation. We Recommend Any Potential Purchaser Checks These For Themselves To Confirm Their Accuracy

Price:	£349,500
Tenure:	Leasehold
Beds:	2
Baths:	1
Reception Rooms:	1
Total Sq Ft:	703
Council Tax Band:	Band D in Barnet
EPC Rating:	C
Service Charge:	£246.62 per annum
Ground Rent:	NA
Lease Length:	120 Years
Distance to:	
Edgware Station:	0.2 Miles
Stanmore Station:	1.8 Miles

