

WILDERVANK
Healdwood Road, Romiley
GUIDE PRICE
£1.0 MILLION

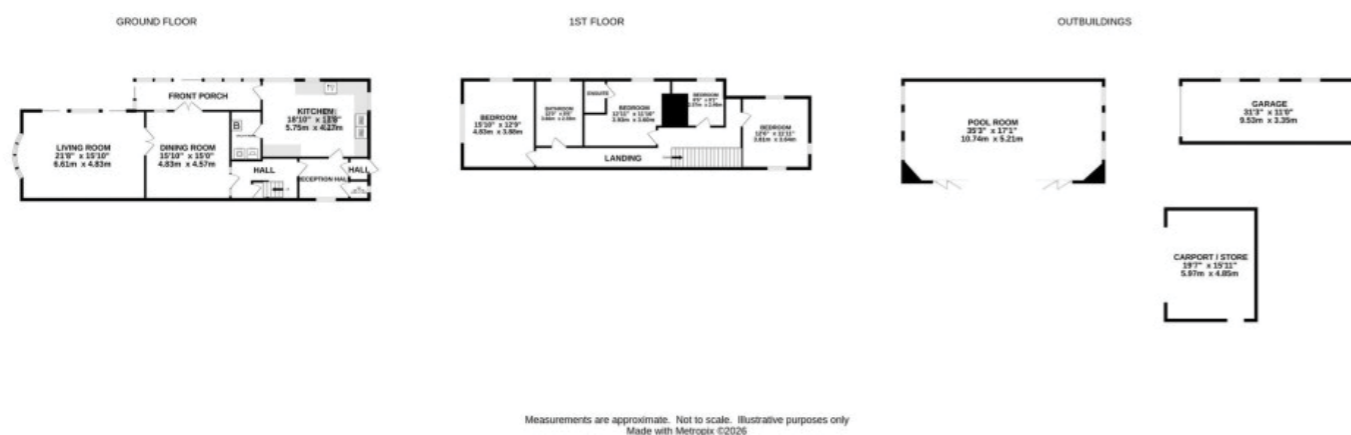

NOTICE
Gascoigne Halman for themselves and for the vendors or lessors of this property whose agents they are give notice that: (i) the particulars are set out as a general outline only for the guidance of intending purchasers or lessees, and do not constitute, nor constitute part of, an offer or contract; (ii) all descriptions, dimensions, references to condition and necessary permissions for use and occupation, and other details are given in good faith and are believed to be correct but any intending purchasers or tenants should not rely on them as statements or representations of fact but must satisfy themselves by inspection or otherwise as to the correctness of each of them; (iii) no person in the employment of Gascoigne Halman has any authority to make or give any representation or warranty whatever in relation to this property.

THE AREAS LEADING ESTATE AGENCY

Marple Bridge
10, Town Street, MARPLE BRIDGE SK6 5DS
0161 427 2488 marple@gascoignehalman.co.uk

gascoignehalman.co.uk



Luxurious four-bed, two-bath detached home with THE BEST panoramic views, landscaped gardens, magnificent swimming pool, stylish kitchen, two reception rooms, and gated driveway. Perfect blend of modern comfort and character.
NO ONWARD CHAIN

GASCOIGNE HALMAN

- No Onward Chain
- Extensive landscaped garden
- Indoor heated swimming pool
- Amazing Panoramic views towards Manchester City Centre
- Modern kitchen with island and integrated appliances

- Four good sized bedrooms
- Peaceful location towards the end of a no through road
- Very high specification and extremely well maintained
- Private gated entrance with stone carport and separate detached garage
- Open plan living areas with wood flooring and fireplaces

**GUIDE PRICE
£1.0 MILLION**

WILDERVANK
Healdwood Road, Romiley



This exceptional four-bedroom, two-bathroom detached house offers a luxurious blend of modern living whilst still making the most of its stunning surroundings and breathtaking panoramic views towards Manchester City Centre.

The spacious accommodation includes two inviting reception rooms, each flooded with natural light from large windows and glazed doors that open onto the beautifully landscaped gardens, providing seamless indoor-outdoor entertaining - a focal point of the home. Classic features such as hardwood flooring and stylish fireplaces - including a cosy wood burning stove - create a warm and welcoming atmosphere throughout. The large kitchen boasts a contemporary dining island, integrated appliances, sleek high-gloss cabinetry, and a breakfast bar,

all complemented by views across the garden.

Downstairs also features an additional utility space and downstairs toilet.

When ascending the stairs, the property benefits from three large double bedrooms, with an additional nursery/office space. There is an en-suite, and modern family bathroom both featuring a walk-in showers, and the latter a large bath-tub, as well as thoughtfully designed storage solutions, ensuring the home is as practical as it is beautiful.

This property also benefits from a luxurious indoor swimming pool, enhanced by bi-fold doors that open to the expansive garden, inviting the outdoors in and providing the perfect setting for relaxation. The property's extensive landscaped gardens are a true highlight, featuring vibrant flower beds, mature trees and shrubs, tranquil pond features,

and picturesque patio and seating areas ideal for alfresco dining. Gardening enthusiasts will delight in the presence of greenhouses and a practical garden shed, as well as detached stone garage, while the secure gated entrance leading to a large, stone-built vehicle store, offer both convenience and peace of mind.

Breathtaking panoramic views over the city and countryside, combined with the serene rural setting and a harmonious blend of indoor and outdoor living spaces, create a truly special retreat - perfect for families and anyone seeking a private, elegant haven to call home. A magnificent home not to be missed.

LOCATION

Romiley offers a wide range of shops, restaurants, educational and recreational facilities including a golf course, cricket

club and swimming pool/leisure centre. For the commuter Romiley station offers services to Manchester city centre and the access points to the Northwest motorway network can be found at Stockport East and Bredbury junctions.

DIRECTIONS

Sat-Nav: SK6 4AX

TENURE

Leasehold for . (Subject to verification by solicitors).

SERVICES (NOT TESTED)

Services have not been tested and you are advised to make your own enquiries and/or inspections.

LOCAL AUTHORITY

Stockport MBC

VIEWING

Viewing strictly by appointment through the Agents.

TWENTY NETWORKED OFFICES THROUGHOUT CHESHIRE, SOUTH MANCHESTER & THE HIGH PEAK



gascoignealman.co.uk

GASCOIGNE HALMAN