



## 3 Town House Farm, Town House Road

£1,250 pcm Freehold

Newly renovated cottage • Breath-taking location • On the outskirts of Littleborough • Highly exclusive hamlet • Two bedrooms • Electric heating throughout • Off road parking • Available NOW!

Set within a highly exclusive and private hamlet on the outskirts of Littleborough. Marring a wonderful blend of countryside living and modern appliances, these newly renovated cottages having been internally finished to the highest of standards. Open plan lounge kitchen, utility room, two bedrooms and bathroom. Also with off road parking. Tenure: Freehold



- Newly renovated cottage
- Breath-taking location
- On the outskirts of Littleborough
- Highly exclusive hamlet
- Two bedrooms
- Electric heating throughout
- Off road parking
- Available NOW!



GROUND FLOOR  
398 sq.ft. (37.0 sq.m.) approx.

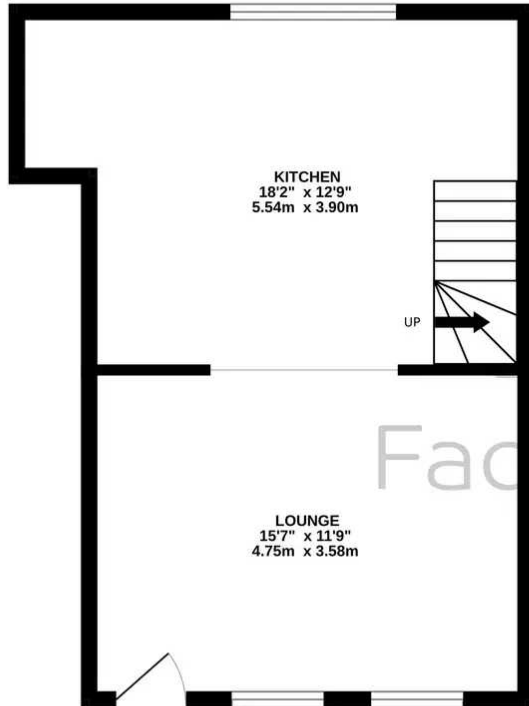

1ST FLOOR  
373 sq.ft. (34.6 sq.m.) approx.

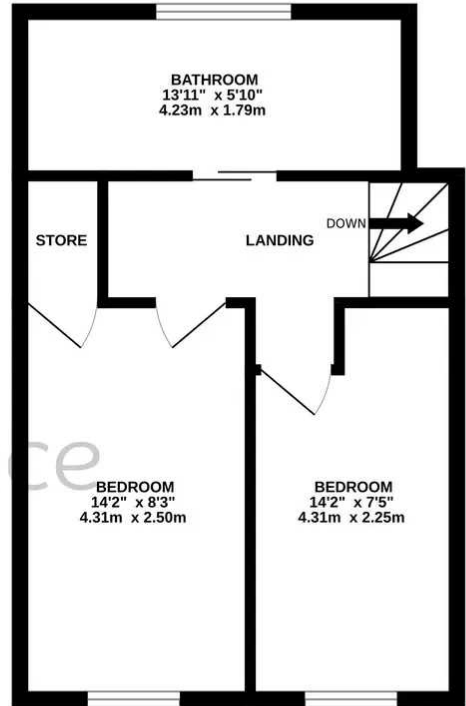

TOTAL FLOOR AREA: 771 sq.ft. (71.6 sq.m.) approx.

Whilst every attempt has been made to ensure the accuracy of the floorplan contained here, measurements of doors, windows, rooms and any other items are approximate and no responsibility is taken for any error, omission or mis-statement. This plan is for illustrative purposes only and should be used as such by any prospective purchaser. The services, systems and appliances shown have not been tested and no guarantee as to their operability or efficiency can be given.  
Made with Metropix ©2023

You can include any text here. The text can be modified upon generating your brochure.

