



Bayswater Road, Hyde Park, W2

£9,717,666 Fixed Price

Properly<sup>✓</sup>

## Property Description

This opulent three-bedroom Penthouse is located on the fourth and top floor and features a private roof terrace and balcony with unrivalled views of Hyde Park and Kensington Palace. The patio is around 180 square feet in size, while the inside space is somewhat less than 2000 square feet. The house features a big open-plan kitchen/diner that extends into the Great Room, which is decorated with Elie Saab accents. The interiors are designed in the trademark style of ELIE SAAB, giving it a distinct personality. The design, lighting, and furniture of ELIE SAAB can be found throughout the lobby. This Victorian-style building finished in 1893 and with double-height pilasters, Corinthian capitals, and an intricate cornice is a relic of London's glorious past. The classical façade has been painstakingly renovated to provide a timeless blend of historical and modern design.





## Key Features

- ✓ Penthouse
- ✓ Duplex
- ✓ Concierge service
- ✓ Three bathrooms, two en-suites
- ✓ Stunning roof terrace and balconies over two floors
- ✓ Views over Hyde Park and Kensington Palace
- ✓ Prime central location
- ✓ Elie Saab Residences offer chic, ultra-modern & desirable















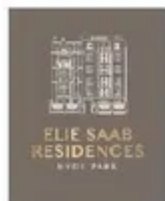

## SIXTH FLOOR 1 APARTMENT PENTHOUSE FLOOR

APARTMENT 501  
3 Bedrooms  
Duplex Penthouse  
(Upper Level)



OCTA Properties is the Exclusive Authorized Representative for the UK and Global Sales for ELIE SAAB RESIDENCES.

FLOOR PLAN : All dimensions are in Imperial and metric, and measured from finish to finish excluding construction tolerances. 2. All materials, dimensions, and drawings are approximate only. 3. Information is subject to change without notice, at developer's absolute discretion. 4. Actual area may vary from the stated area. 5. Drawings not to scale. 6. All images used are for illustrative purposes only and do not represent the actual size, features, specifications, fittings, and furnishings. 7. The developer reserves the right to make revisions/alterations, at its absolute discretion, without any liability whatsoever.

ELIE SAAB x GII



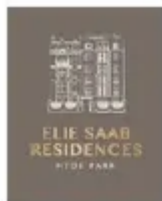

## FIFTH FLOOR 2 APARTMENTS PENTHOUSE FLOOR

APARTMENT 501  
3 Bedrooms  
Duplex Penthouse  
(Lower Level)

APARTMENT 401  
3 Bedrooms  
Duplex (Upper Level)



OCTA Properties is the exclusive Authorized Representative for the UK and Global Sales for ELIE SAAB RESIDENCES

FLOOR PLAN 1: All dimensions are in Imperial and metric, and measured from finish to finish excluding construction tolerances. 2: All materials, dimensions, and drawings are approximate only. 3: Information is subject to change without notice, at developer's absolute discretion. 4: Actual area may vary from the stated area. 5: Drawings not to scale. 6: All images used are for illustrative purposes only and do not represent the actual size, features, specifications, fittings, and furnishings. 7: The developer reserves the right to make revisions/alterations, at its absolute discretion, without any liability whatsoever.

ELIE SAAB x GII



## SIGNATURE PENTHOUSE

APARTMENT 501  
3 BEDROOMS  
DUPLEX PENTHOUSE

Total Area: 181 sq m | 1 952 sq ft  
Balcony Level 5: 4.3 sq m | 4 28 sq ft  
Terrace Level 6: 34.51 sq m | 371.5 sq ft

3 | 3 | 1 |



KEY PLAN

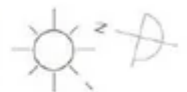

Views towards  
Hyde Park

LEVEL 5

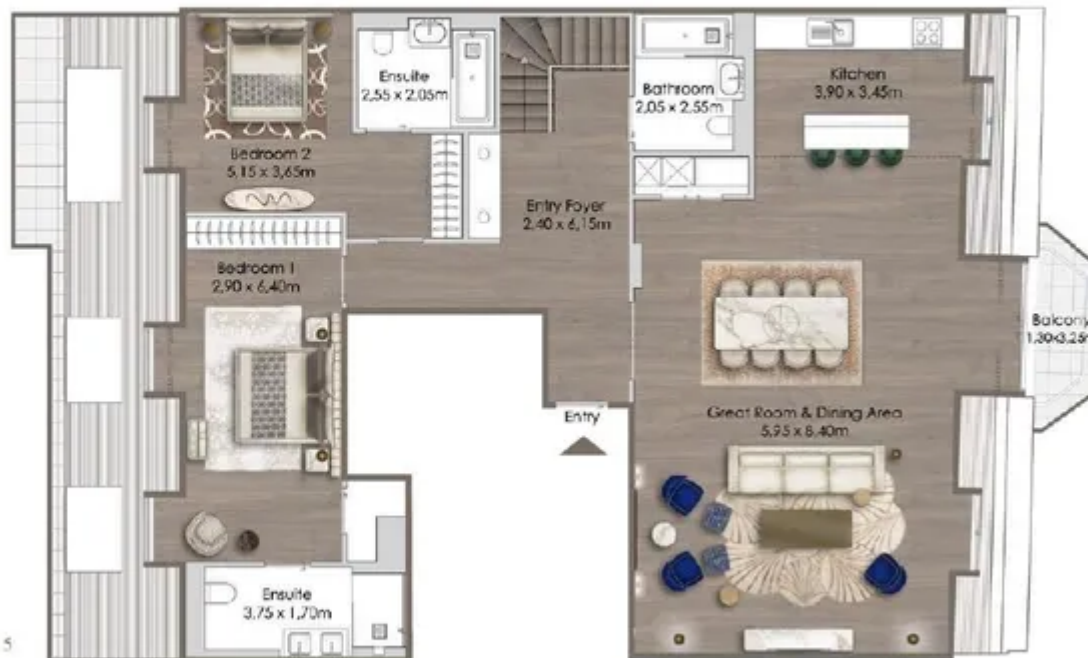

LEVEL 6



OCTA Properties is the Exclusive Authorized Representative for the UK and Global Sales for ELIE SAAB RESIDENCES

FLOOR PLAN 1: All dimensions are in Imperial and metric, and measured from finish to finish excluding construction tolerances. 2: All materials, dimensions, and drawings are approximate only. 3: Information is subject to change without notice, at developer's absolute discretion. 4: Actual area may vary from the stated area. 5: Drawings not to scale. 6: All images used are for illustrative purposes only and do not represent the actual size, features, specifications, fittings, and furnishings. 7: The developer reserves the right to make revisions / alterations, at its absolute discretion, without any liability whatsoever.

ELIE SAAB x GII



Properly

0207 459 4400

hello@properly.space

Properly<sup>✓</sup>