



Bartlams.

21 Manor Gardens High Street, Wombourne - WV5 9DG
£112,000



21 Manor Gardens High Street

Wombourne, Wolverhampton

Bartlams are delighted to offer this spacious and well-appointed two-bedroom ground-floor retirement apartment. Conveniently located close to shopping facilities, public transport links, and a range of local amenities, this property is perfectly positioned for ease and comfort. Offered with NO UPWARD CHAIN.

The spectacular interior at Manor Gardens briefly comprises: An entrance hall leading to the main inner hallway that stretches through the property supplying access to several rooms and provides generous built-in storage throughout. The living room is positioned to the rear offering dual-aspect windows; spacious fitted kitchen is placed adjacent to the living room with wall and base units with laminate worktops over, the kitchen has been re-fitted to a modern spec and presents space for a washing machine and fridge freezer. The two bedrooms are located towards the front of the apartment and both benefit from plenty of storage space. The re-fitted shower room showcases a fully tiled room with a walk-in shower, WC and a wash hand basin. Manor Gardens also benefits from pleasant communal gardens: Car Parking space: Drying area and Bin Store. Manor Gardens is a Leasehold scheme for the elderly, occupancy restricted to persons over 55 years. 70% Shared Ownership (no rental payable on remaining 30%); No Pets; Application to purchase subject to approval by Bromford Housing Group and Help to Buy. Further details from the agents (Council Tax: Band B - EPC: Band C - Service Charge: approx £127 per calendar month 2023/24 which includes building insurance only - New 60 year lease issued at each change of ownership)

- NO UPWARD CHAIN
- GROUND FLOOR APARTMENT
- ALLOCATED PARKING FOR ONE VEHICLE



Ground Floor

Approx. 56.7 sq. metres (610.5 sq. feet)

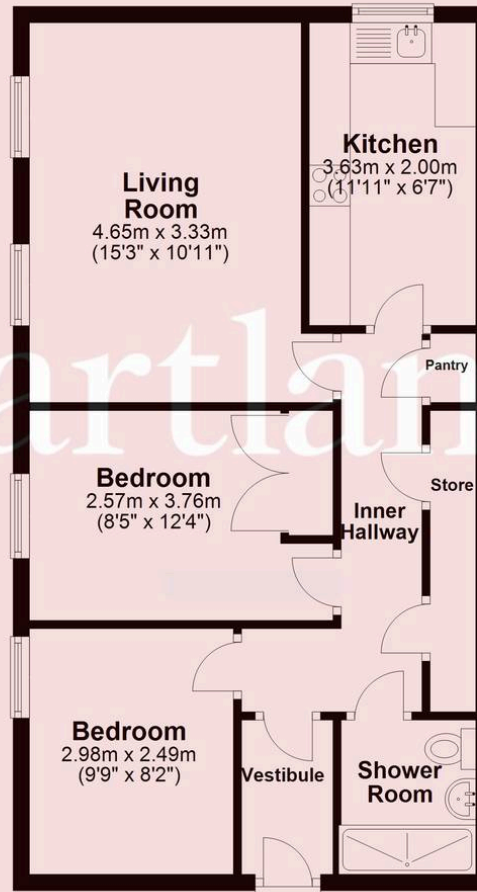

Total area: approx. 56.7 sq. metres (610.5 sq. feet)

Floor plan for illustration purposes. Not to scale and all measurements are approximate. Copyright Bartlams Limited.
Plan produced using PlanUp.

Bartlams

Bartlams Ltd, The House On The Green High Street - WV5 9DP

01902894141

wombourne@bartlams.co.uk

www.bartlams.co.uk/

NOTICE: These particulars, although believed to be correct, do not constitute any part of an offer or contract. All statements contained in these particulars as to this property are made without responsibility and are not to be relied upon as statements or representations of warranty whatsoever in relation to property. Any intending purchaser must satisfy themselves by inspection or otherwise as to the correctness each of the statements contained in these particulars. All measurements are approximate and for illustrative purposes only.

Photographs are produced for general information and it must not be inferred that any item shown is included in the sale.
DISCLOSURE: As a professional Estate Agency our clients employ us to look after their best interests. This includes providing them with full details of offers made to purchase their property. To ensure our obligations to our clients are met we need to check the status of all potential purchasers. If you make an offer on this property we will ask a member of The Finance Family to contact you to verify your status. They are a leading firm of Independent Financial Advisers and Mortgage Brokers. Should they transact any business resulting from our introduction then we may receive a commission.

