



22 Walthew House Lane Kitt Green, Wigan

In Excess of £90,000



22 Walthew House Lane Kitt Green

Wigan, Wigan

Recently refurbished 2nd-floor flat in Kitt Green. Modern, open-plan living space with contemporary kitchen. 2 bedrooms, en-suite. Allocated parking. Prime location near amenities. Council Tax band: B

Tenure: Leasehold

EPC Energy Efficiency Rating: C

EPC Environmental Impact Rating: C

- Recently refurbished
- Situated in close proximity to a range of local amenities including schools and Robin Park Retail Park
- Spacious open plan lounge and dining area
- Contemporary kitchen featuring sleek neutral cabinetry, transitioning seamlessly into lounge/dining area
- 3 piece bathroom with panelled bath, pedestal wash basin and low-level WC
- Main double bedroom with en-suite in white with sink, wc and glass enclosed shower
- Versatile neutral toned 2nd bedroom
- Allocated parking space to the rear of the property

Reception

Kitchen

Bedroom 1

En-suite

Bedroom 2

Bathroom





ALLOCATED PARKING

2 Parking Spaces





GROUND FLOOR
648 sq.ft. (60.2 sq.m.) approx.

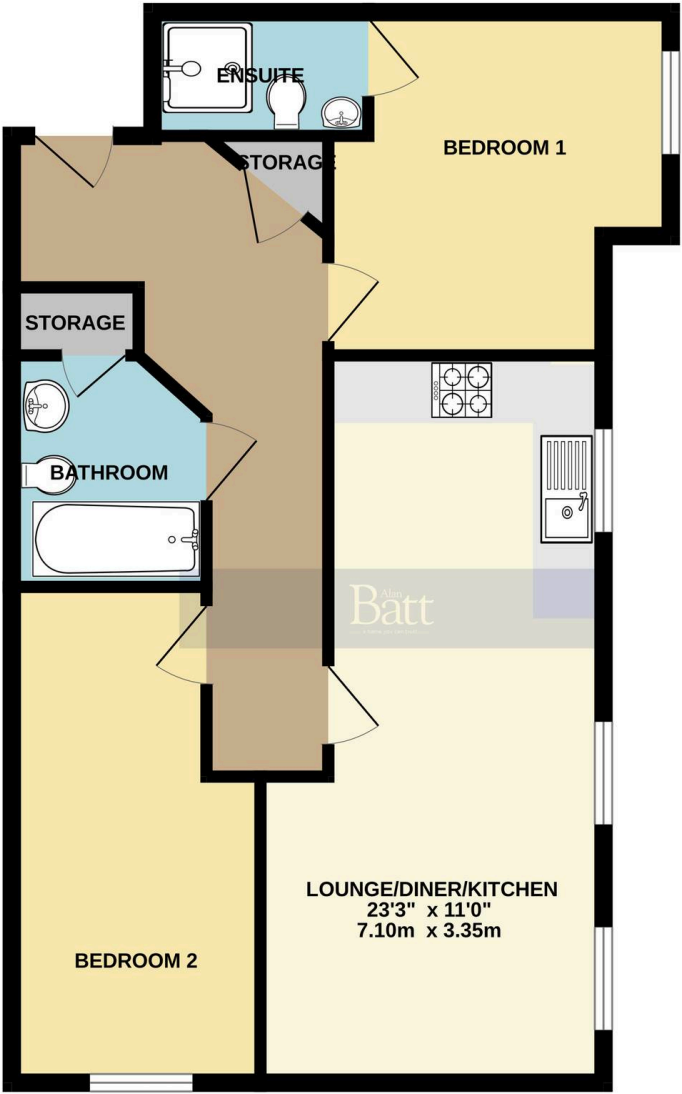

TOTAL FLOOR AREA : 648 sq.ft. (60.2 sq.m.) approx.

Whilst every attempt has been made to ensure the accuracy of the floorplan contained here, measurements of doors, windows, rooms and any other items are approximate and no responsibility is taken for any error, omission or mis-statement. This plan is for illustrative purposes only and should be used as such by any prospective purchaser. The services, systems and appliances shown have not been tested and no guarantee as to their operability or efficiency can be given.

Made with Metropix ©2025

Batt

Alan

You can include any text here. The text can be placed upon the image.

— SALES & LETTINGS —