



3 Wooburn Mead, Wooburn Green

Guide Price **£800,000**

Ashington Page

Located on a quiet private road in a sought-after part of Wooburn Green, this beautifully presented four-bedroom family home with parking offers a thoughtfully extended layout with a high specification throughout. Externally, the garden is landscaped with a lawn, mature trees, herbaceous borders, a garden shed, and side access via a secure gate.

EPC: C

Council Tax: F

Tenure: Freehold

These particulars are for guidance only. They are prepared and issued in good faith and are intended to give a fair summary of the property. Any description should not be relied on as a statement or representation of fact or that the property, or its services, are in good condition. The photographs show only certain parts of the property at the time they were taken. Any areas, measurements or distance given are approximate only. Any reference to alterations to, or use of, any part of the property is not a statement that any necessary planning, building regulations or other consent has been obtained. These matters must be verified by an intending purchaser. All statements contained in these particulars in relation to the property are made without responsibility of Ashington Page or its clients. Neither Ashington Page (nor any joint agents) nor any of their employees has any authority to make or give any representation or warranty whatsoever in relation to the property

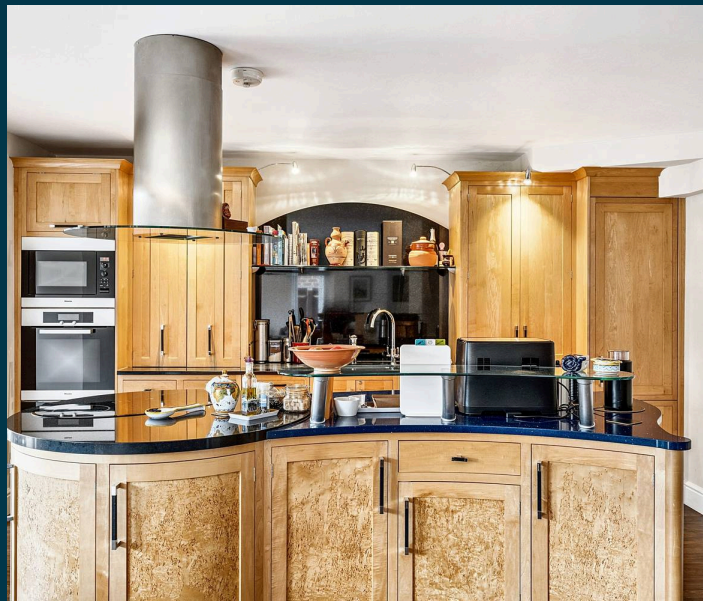
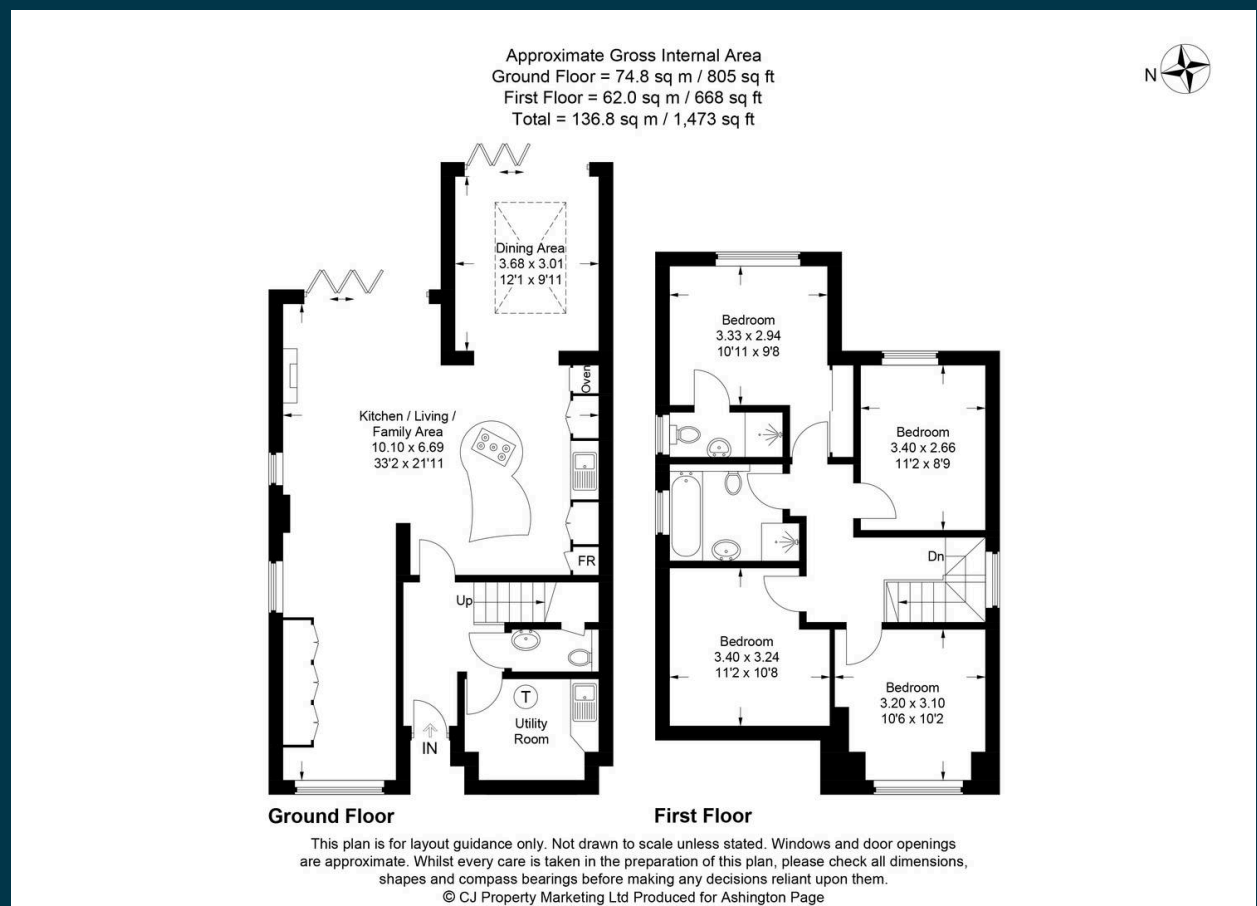

01494 680018
info@ashingtonpage.co.uk
www.AshingtonPage.co.uk

