



4 Beaconsfield Mews Holtspur Top Lane, Beaconsfield

Guide Price £275,000

Ashington Page

We are proud to present this exceptional 2-bedroom flat, located in a sought-after area. Boasting an ample living space exceeding 800 square feet, this well-maintained property offers a comfortable and inviting atmosphere for you to call home. The recently extended lease to an impressive 153 years, along with a share of freehold, provides peace of mind for prospective buyers.

- Tenure: Share of freehold
- Years on the Lease: 154 years
- Service charge: £2096.20 pa
- EPC: E
- Approx Sq Feet: 807 sqft
- Council Tax: E

These particulars are for guidance only. They are prepared and issued in good faith and are intended to give a fair summary of the property. Any description should not be relied on as a statement or representation of fact or that the property, or its services, are in good condition. The photographs show only certain parts of the property at the time they were taken. Any areas, measurements or distance given are approximate only. Any reference to alterations to, or use of, any part of the property is not a statement that any necessary planning, building regulations or other consent has been obtained. These matters must be verified by an intending purchaser. All statements contained in these particulars in relation to the property are made without responsibility of Ashington Page or its clients. Neither Ashington Page (nor any joint agents) nor any of their employees has any authority to make or give any representation or warranty whatsoever in relation to the property

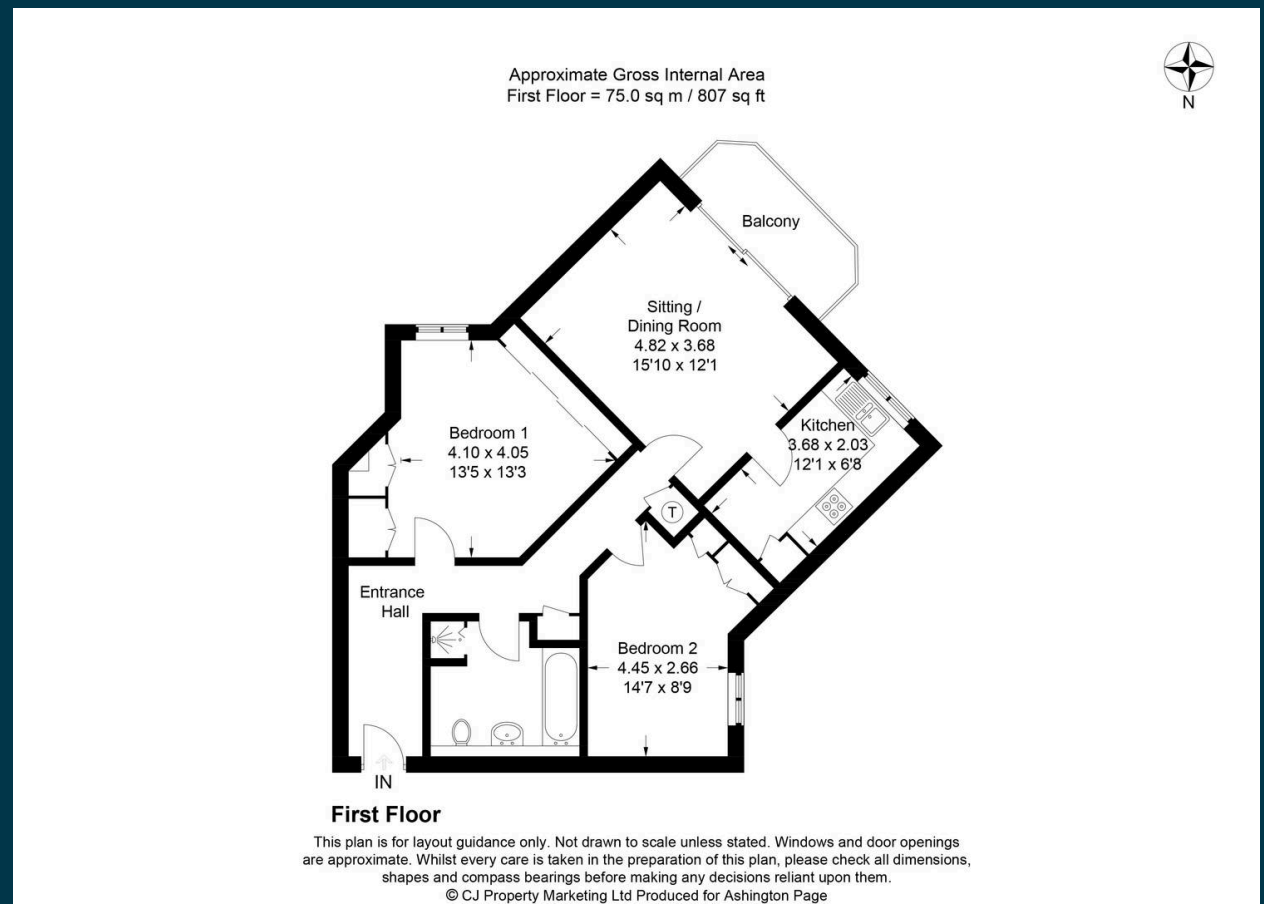

01494 680018
info@ashingtonpage.co.uk
www.AshingtonPage.co.uk