



17 Ermine Court Coronation Road, Ware

£260,000 Leasehold

1 Bedroom Apartment in Over 60s Development • Large Corner Plot • Separate Kitchen • Modern Shower Room
• Social Communal Lounge on Ground Floor With Kitchen Area • Communal Laundry Room • Lift Access • Guest Suite



Entrance Hallway

Lounge/ Diner

21' 6" x 10' 7" (6.55m x 3.23m)

21' 6" x 10' 7"

Kitchen

7' 4" x 6' 0" (2.24m x 1.83m)

7' 4" x 6' 0"

Bedroom

15' 6" x 8' 11" (4.72m x 2.72m)

15' 6" x 8' 11"

Shower Room

Communal Lounge/ Kitchen

Communal Laundry Room

Communal Garden







First Floor
599 sq.ft. (55.6 sq.m.) approx.

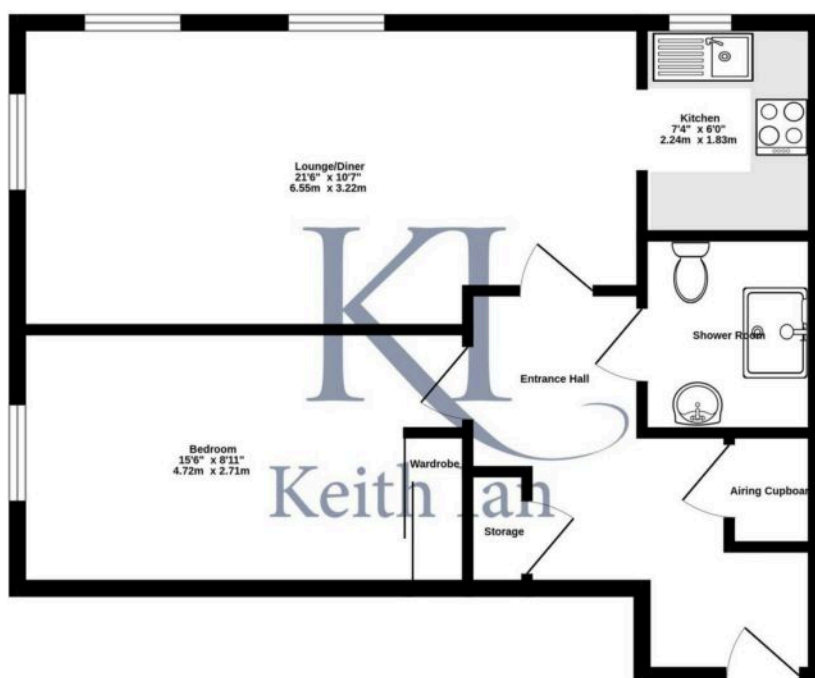

TOTAL FLOOR AREA : 599 sq.ft. (55.6 sq.m.) approx.

Whilst every attempt has been made to ensure the accuracy of the floorplan contained here, measurements of doors, windows, rooms and any other items are approximate and no responsibility is taken for any error, omission or mis-statement. This plan is for illustrative purposes only and should be used as such by any prospective purchaser. The services, systems and appliances shown have not been tested and no guarantee as to their operability or efficiency can be given.
Made with Metropix ©2025