



Annesley Walk, N19 5DR  
£1,850 pcm

**DAVID  
ANDREW**

your  
most  
valuable  
asset



Nestled in a purpose-built smart low rise block, this inviting 1-bedroom property presents an opportunity for comfortable urban living. With hard floors and plush carpets throughout, this residence offers a harmonious blend of style and functionality.

The bright living space, illuminated by natural light, seamlessly incorporates a dining area with a table and chairs, perfect for hosting intimate gatherings. The semi-open plan layout enhances the sense of space and connectivity, creating a welcoming environment for relaxation and entertainment. Further features include one double bedroom, ample storage, fitted kitchen, family-sized three-piece bathroom along with gas central heating and double glazed windows, ensuring warmth and comfort all year round.

The property is moments from Archway underground station (Northern line) as well as numerous regular bus routes providing unrivalled connections to the City, West End and the surrounding area. There are a variety of vibrant shops, bars and restaurants nearby, as well as the beautiful open spaces of Hampstead Heath, Parliament Hill Fields and Waterlow Park. Offered Part/Unfurnished. Available 7th September

Council Tax band: C EPC Energy Efficiency Rating: C

- Purpose Built Property
- One Double Bedroom
- Semi Open-Plan
- Bright Reception/Dining Room
- Fitted Kitchen
- Family Sized Bathroom
- Ample Storage Space
- Moments from Archway Tube (Northern Line)
- Offered Part/Unfurnished
- Available 7th September









## Annesley Walk, N19

Approximate Gross Internal Area = 490 sq ft / 45.5 sq m

**DAVID  
ANDREW** | your  
most  
valuable  
asset

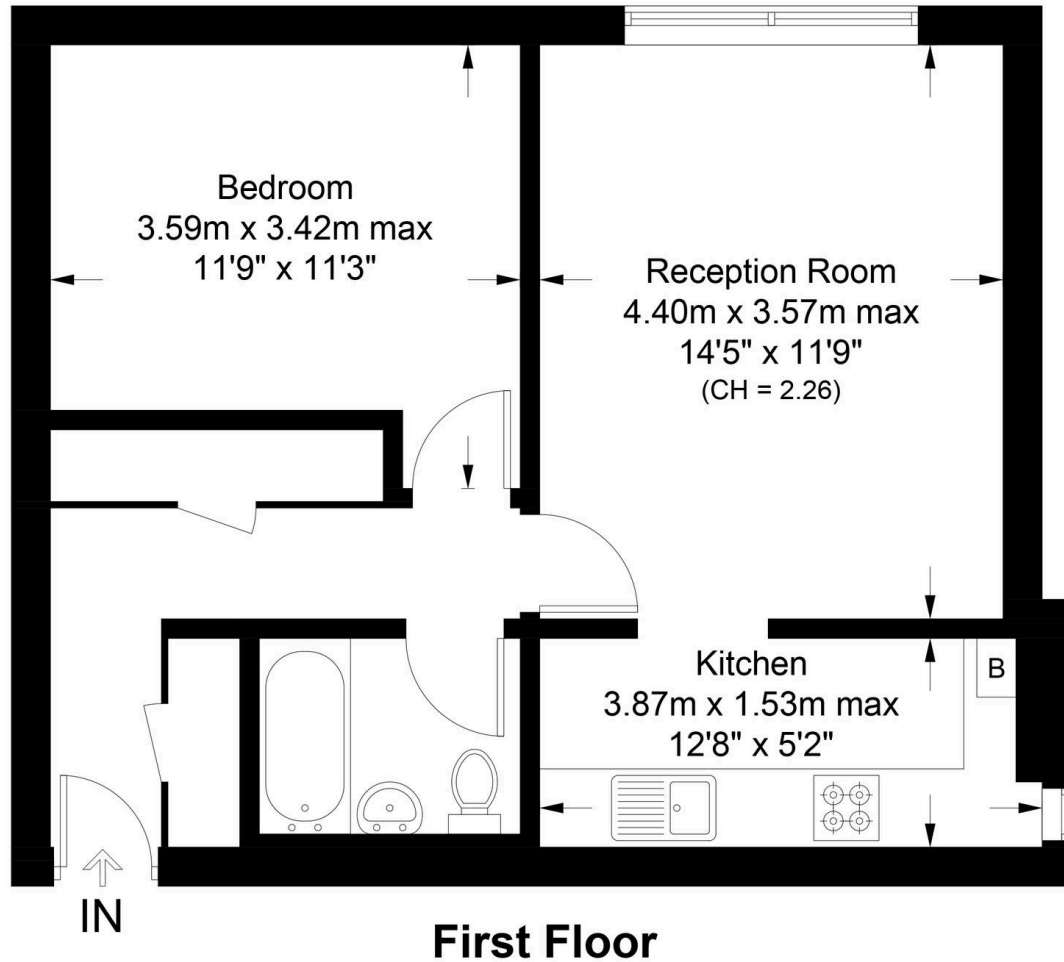

### Archway Office

671 Holloway Road  
London, N19 5SE

T (0)20 7619 3750

### Highbury Office

90 Highbury Park  
London, N5 2XE

T (0)20 7354 9111

### Finsbury Park Office

167 Stroud Green Road  
London, N4 3PZ

T (0)20 7281 2000

### Property Management Office

235 Blackstock Road  
London, N5 2LL

T (0)20 7354 9222

scan to book  
a viewing



**Certified  
Property  
Measurer**

This plan is for layout guidance only. Not drawn to scale unless stated. Windows and door openings are approximate. Whilst every care is taken in the preparation of this plan, please check all dimensions, shapes and compass bearings before making any decisions reliant upon them. (ID1222442)

**DAVID  
ANDREW** | your  
most  
valuable  
asset

as been exercised in the  
of these particulars,  
but the property must not be  
as representations of  
fact. Prospective applicants  
and rely upon their own  
those of professional  
s. David Andrew Estates  
ibility for any error contained  
in these particulars.



**safeagent**