



44 Russell Drive, Bathgate



44 Russell Drive

Bathgate, Bathgate

This beautifully presented 3 bedroom terraced townhouse is available immediately and CHAIN-FREE. This is an exceptional home that perfectly combines luxury and practicality in a convenient location.

Council Tax band: E

Tenure: Freehold

- • Beautifully Presented 3 Bed Terraced Townhouse in Desirable Bathgate
- • Available CHAIN-FREE and in Move-in Condition
- • Spacious Lounge / Diner Overlooking Private Rear Garden
- • Sleek Contemporary Kitchen
- • Primary Bedroom with Dressing Room and Ensuite
- • Two Further Double Bedrooms
- • Modern Family Bathroom and Downstairs WC
- • Attractive and Private Low Maintenance Rear Garden
- • Open Outlook to the Front
- • Convenient Resident's Communal Car Park





Kitchen

11' 7" x 8' 8" (3.53m x 2.65m)

The spacious and bright Kitchen overlooks the greenery at the front of the property. The beautiful cabinetry is comprised of a mix of wall and base units, offering ample storage space. Integral appliances include fridge/freezer, oven, gas hob and extractor hood. The dishwasher and washing machine are free-standing and are included in the sale price (without guarantees or warranties). Splash-back multi-coloured tiling thorough adds a lovely modern effect.

Lounge / Diner

16' 6" x 12' 10" (5.04m x 3.91m)

The expansive Lounge / Diner is full of natural light and boasts beautiful flooring. There is plenty of room for both relaxation in comfort and entertaining. There is space for a large dining table and chairs, with the Kitchen nearby. Facing the rear of the house, it has stunning views over the peaceful rear garden, which is accessed by French patio-style doors. The Lounge / Diner also has a useful cupboard and door, separating it from the entry hallway.

Entry Hall

10' 2" x 6' 6" (3.11m x 1.97m)

Immediately upon entering the property, you step into a most welcoming Foyer (1.80m x 1.15m), with stunning flooring. The Foyer leads to the Entry Hall (3.11m x 1.97m) with both the Kitchen and Downstairs WC along to the left. Neutrally carpeted stairs lead up to the 1st floor landing. The Lounge / Diner is at the end of the Hallway.

Ensuite Shower Room in Primary Bedroom

6' 11" x 6' 9" (2.10m x 2.07m)

The Primary Bedroom features this stunning and bright Ensuite Shower Room, including WC and sink, in addition to the spacious shower unit. The room has the additional attribute of a Velux window.

Dressing Room / Walk-in Closet in Primary Bedroom

10' 2" x 5' 8" (3.11m x 1.73m)

This Dressing Room is an extraordinary feature of the Primary Bedroom. Thanks to the ceiling Velux window it boasts outstanding light. The spacious sanctuary features a clothing rack, large mirror and shelving. The Ensuite



You can include any text here. The text can be modified upon generating your brochure.

You can include any text here. The text can be modified upon generating your brochure.



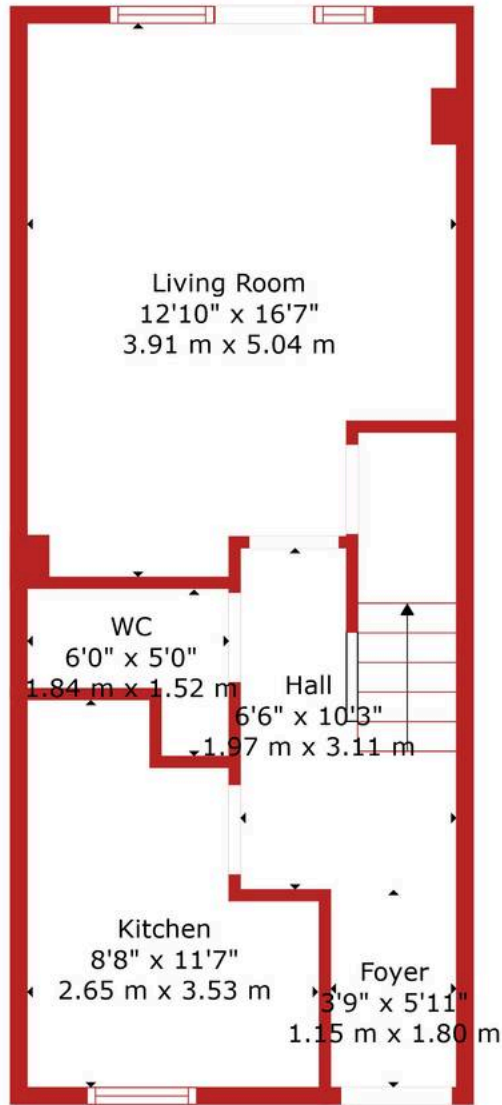

Floor 1

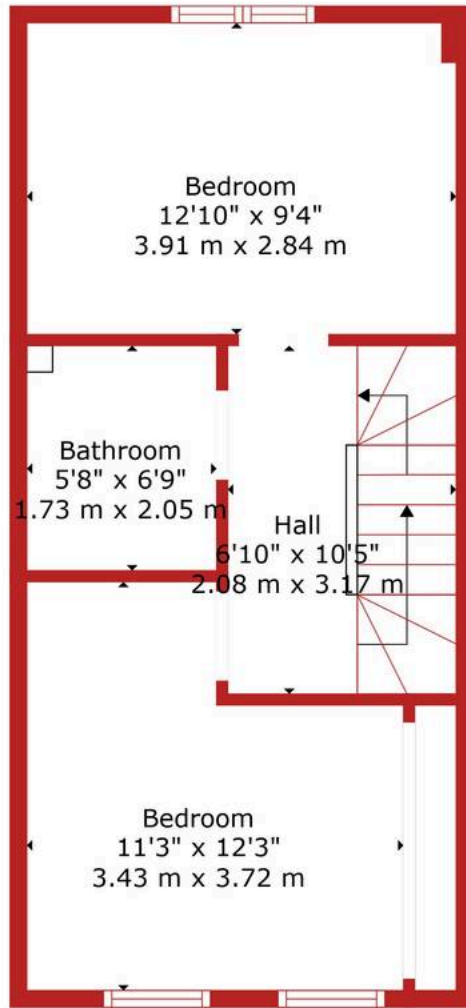

Floor 2

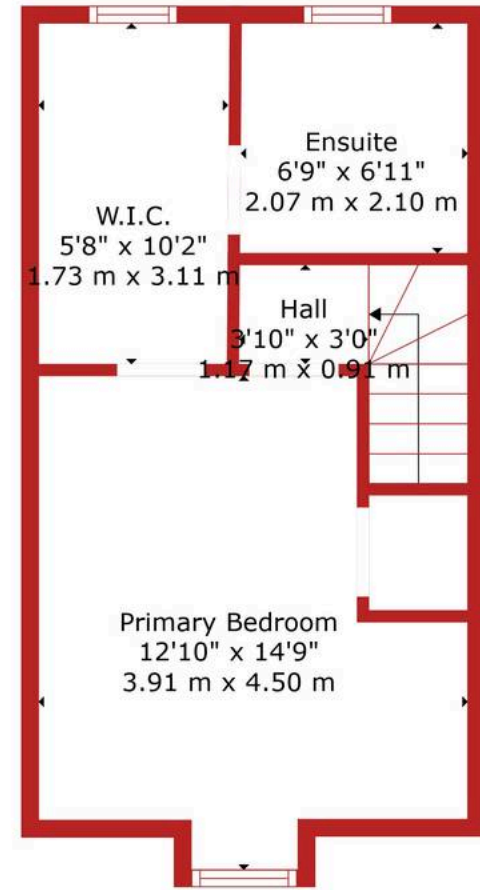

Floor 3



TOTAL: 1067 sq. ft, 99 m2
 FLOOR 1: 408 sq. ft, 38 m2, FLOOR 2: 371 sq. ft, 34 m2, FLOOR 3: 288 sq. ft, 27 m2
 EXCLUDED AREAS: LOW CEILING: 22 sq. ft, 2 m2
 WALLS: 126 sq. ft, 12 m2



KnightBain Estate Agents

Knightbain, 4 Greendykes Road, Broxburn - EH52 5AG

01506 852000

info@knightbain.co.uk

www.knightbain.co.uk/



KnightBain 