



131 Heath Road, Beaconsfield

Guide Price £600,000

Ashington Page

131 Heath Road is a much loved family home which has been extended over time to create spacious accommodation. Now in need of updating, it offers great scope to further extend if needed and to personalise this lovely home. This lovely home is situated in a sought after road, next to a quiet cul de sac and is ideally located with easy access to the M40 and the mainline Beaconsfield train station to London Marylebone. There are miles of beautiful countryside walks, right from your doorstep!

- Approx Sq Feet:1,379 sqft
- Property Age Bracket:1960 - 1970
- Council Tax Band:E
- EPC: D

These particulars are for guidance only. They are prepared and issued in good faith and are intended to give a fair summary of the property. Any description should not be relied on as a statement or representation of fact or that the property, or its services, are in good condition. The photographs show only certain parts of the property at the time they were taken. Any areas, measurements or distance given are approximate only. Any reference to alterations to, or use of, any part of the property is not a statement that any necessary planning, building regulations or other consent has been obtained. These matters must be verified by an intending purchaser. All statements contained in these particulars in relation to the property are made without responsibility of Ashington Page or its clients. Neither Ashington Page (nor any joint agents) nor any of their employees has any authority to make or give any representation or warranty whatsoever in relation to the property

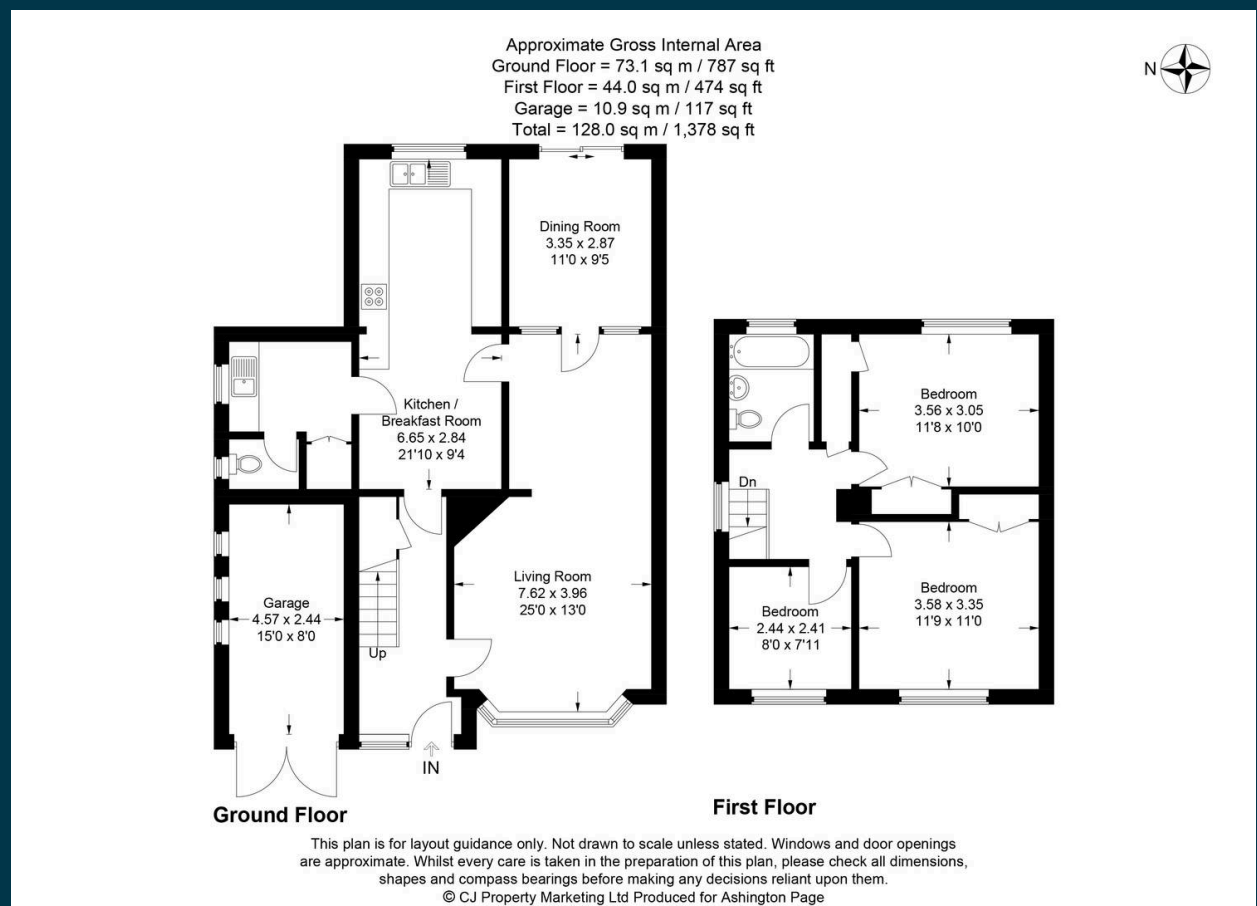

01494 680018
info@ashingtonpage.co.uk
www.AshingtonPage.co.uk