



SAB  
ESTATES

**Hadfield Close, Southall**

Offers in Region of **£215,000**

**SAB**  
ESTATES





## Hadfield Close

### Southall

- Option to Purchase Share of Freehold
- Assigned Parking Space
- Excellent Condition Throughout
- Close to Local Amenities
- Great Transport Links
- Fully Fitted Kitchen
- Recently Refurbished
- Leasehold: 93 Years Remaining
- Ground Rent: £100 pa
- Service Charge: £1,211 pa

Council Tax band: C

Tenure: Leasehold



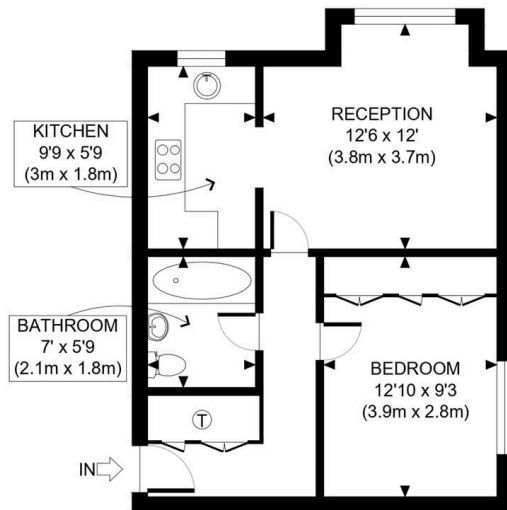

SECOND FLOOR  
GROSS INTERNAL  
FLOOR AREA 445 SQ FT



APPROX. GROSS INTERNAL FLOOR AREA: 445 SQ FT/ 41 SQM

**PROPERTY PHOTO PLANS**.CO.UK  
ONE STOP SHOP FOR PROPERTY MARKETING

This plan is for illustrative purposes only and should be used as such by any prospective client. Whilst every attempt has been made to ensure the accuracy of the Floor Plan contained here, measurements of the doors, windows, rooms and any other items are approximate and no responsibility is taken for any errors, omissions, or misstatement. The services, systems and appliances shown have not been tested and no guarantee as to the operability or efficiency can be given.







## SAB Estates

236-238 Ruislip Road, Greenford - UB6 9RS

020 8575 2929 • [info@sabestates.com](mailto:info@sabestates.com) • [www.sabestates.com/](http://www.sabestates.com/)