



SAB
ESTATES

Perceval Court Newmarket Avenue, Northolt
£235,000

SAB
ESTATES



Perceval Court Newmarket Avenue

Northolt

- Leasehold: 85 Years Remaining
- Great Condition Throughout
- Ample Parking
- Hot Water & Heating included in Service Charge
- Private Balcony
- Fifth Floor Flat – Lift Available
- Chain Free
- Ground Rent: £0 pa
- Service Charge: £330 pcm

Council Tax band: B

Tenure: Leasehold

EPC Energy Efficiency Rating: C

EPC Environmental Impact Rating: D



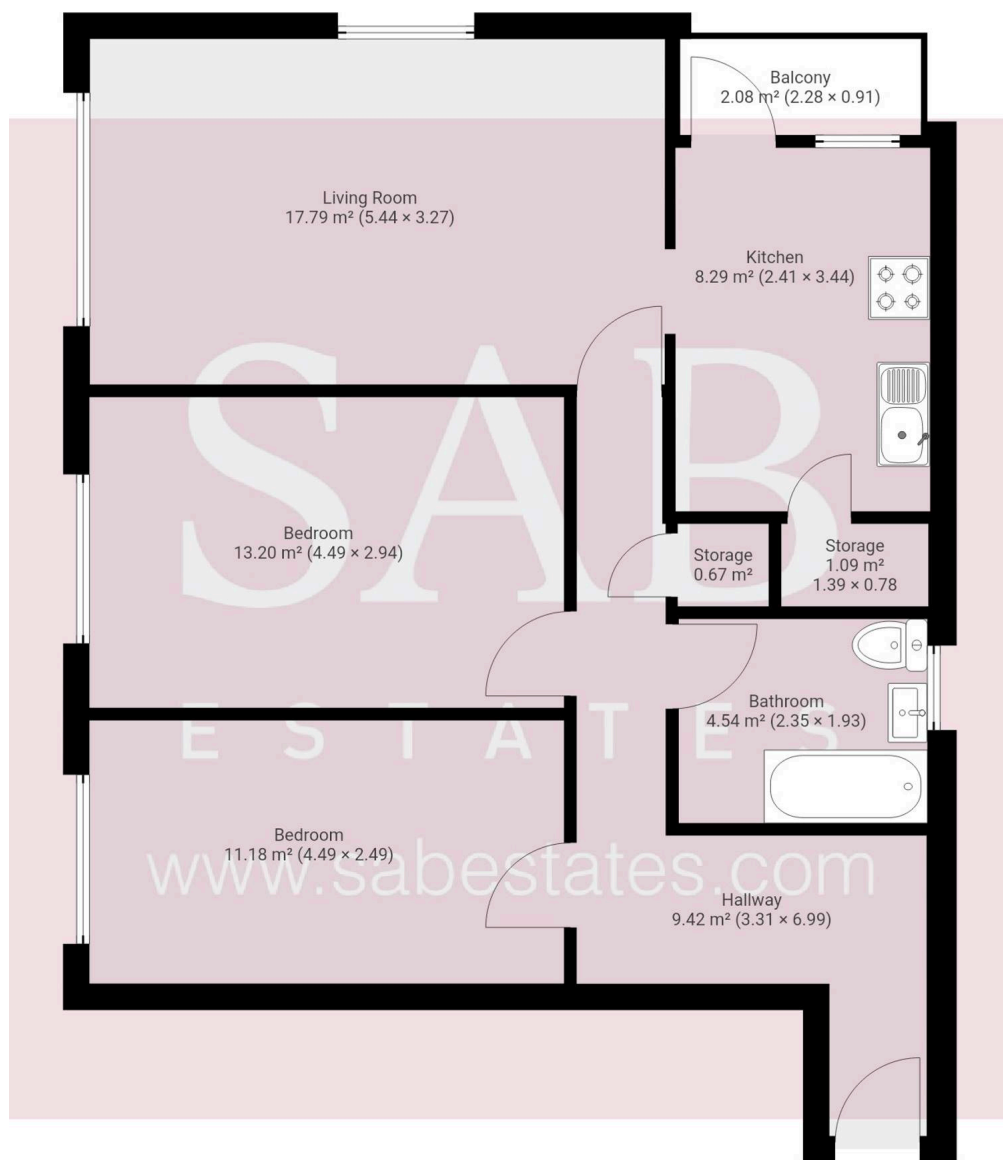



SAB Estates

236-238 Ruislip Road, Greenford - UB6 9RS

020 8575 2929 • info@sabestates.com • www.sabestates.com/