



22 Orchard Drive, Wooburn Green

Guide Price £415,000

Ashington Page

This beautifully presented two bedroom mid-terraced house offers a superb blend of comfort, style, and functional living spaces. Outside, the property enjoys a well-maintained front garden with a paved pathway and off-road parking. The peaceful cul-de-sac setting ensures privacy and a sense of community, while the spacious garage offers additional secure parking or storage. The delightful rear garden includes a patio area for outdoor seating.

EPC: C

Council Tax: D

Tenure: Freehold

These particulars are for guidance only. They are prepared and issued in good faith and are intended to give a fair summary of the property. Any description should not be relied on as a statement or representation of fact or that the property, or its services, are in good condition. The photographs show only certain parts of the property at the time they were taken. Any areas, measurements or distance given are approximate only. Any reference to alterations to, or use of, any part of the property is not a statement that any necessary planning, building regulations or other consent has been obtained. These matters must be verified by an intending purchaser. All statements contained in these particulars in relation to the property are made without responsibility of Ashington Page or its clients. Neither Ashington Page (nor any joint agents) nor any of their employees has any authority to make or give any representation or warranty whatsoever in relation to the property

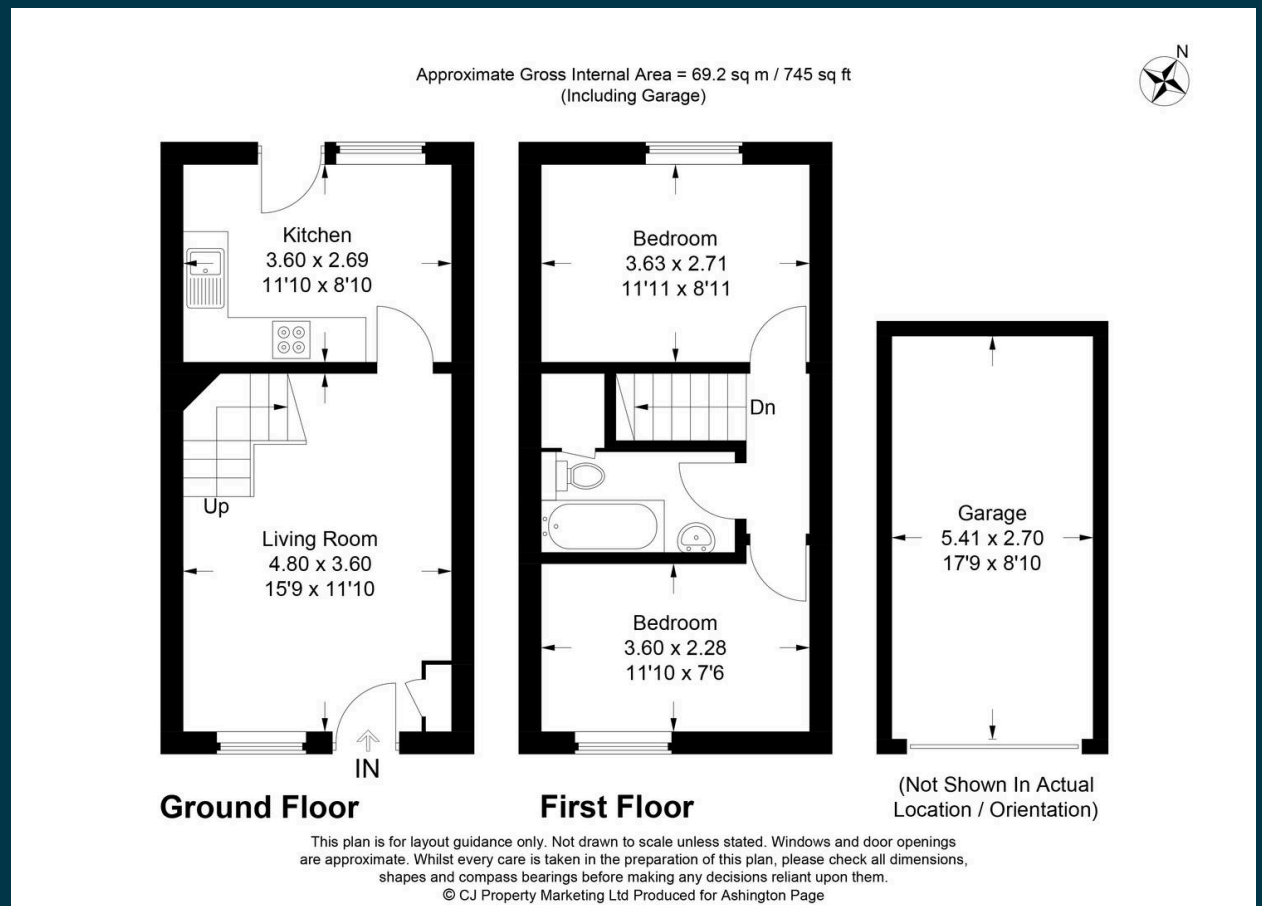

01494 680018
info@ashingtonpage.co.uk
www.AshingtonPage.co.uk

