



South House, Bath Road - GL53 7JX

CR
Guide Price £220,000



Flat 11

South House, Cheltenham

Cook Residential is delighted to present this beautiful top floor apartment, set within a stunning Grade II listed building. Located on the sought after Bath Road, this property is within close proximity to a range of local amenities, restaurants, and the town centre.

Council Tax band: B

Tenure: Share of Freehold

EPC Energy Efficiency Rating: D

EPC Environmental Impact Rating: D



- Impressive Top Floor Apartment In Grade II Listed Building
- Spacious Kitchen Diner
- Two Bedrooms
- Built In Storage
- Large Communal Garden
- Town Centre Location



Cook Residential is delighted to present this beautiful top floor apartment, set within a stunning Grade II listed building. Located on the sought after Bath Road, this property is within close proximity to a range of local amenities, restaurants, and the town centre. Offering a blend of character and modern convenience, this charming home features a bright living room, a separate kitchen/dining area, and access to a communal garden.

Living Room: The spacious and bright living room boasts wood flooring and a stunning feature fireplace, creating a warm and inviting atmosphere.

Kitchen/Dining Area: Separate from the living room, the kitchen/dining area provides ample space for cooking and entertaining. The layout allows for a functional yet stylish space to enjoy meals and social gatherings.

Bedrooms: The main bedroom is a generous double, featuring built-in storage for added convenience. The second bedroom is ideal as a single room, nursery, or home office, offering versatility to suit different needs.

Bathroom: The stylish bathroom comprises WC, Basin and a bath with an overhead shower, providing both practicality and comfort. Further benefits include a tiled floor and part tiled walls.

Exterior & Additional Features: Residents benefit from a communal garden, perfect for outdoor relaxation, and first come, first served parking.

Tenure & Charges:

- Tenure: Share of Freehold
- Lease: 236 years remaining
- Service Charge: £121.50 per month
- Council Tax Band: B
- EPC Rating: D

Location: Situated on Bath Road, this property enjoys a prime location close to an array of shops, restaurants, and amenities, while also being within easy reach of the town centre.

A viewing is highly recommended to fully appreciate the character and convenience this property has to offer.

All information regarding the property details, including its position on Share of Freehold is to be confirmed between vendor and purchaser solicitors. All measurements are approximate and for guidance purposes only.

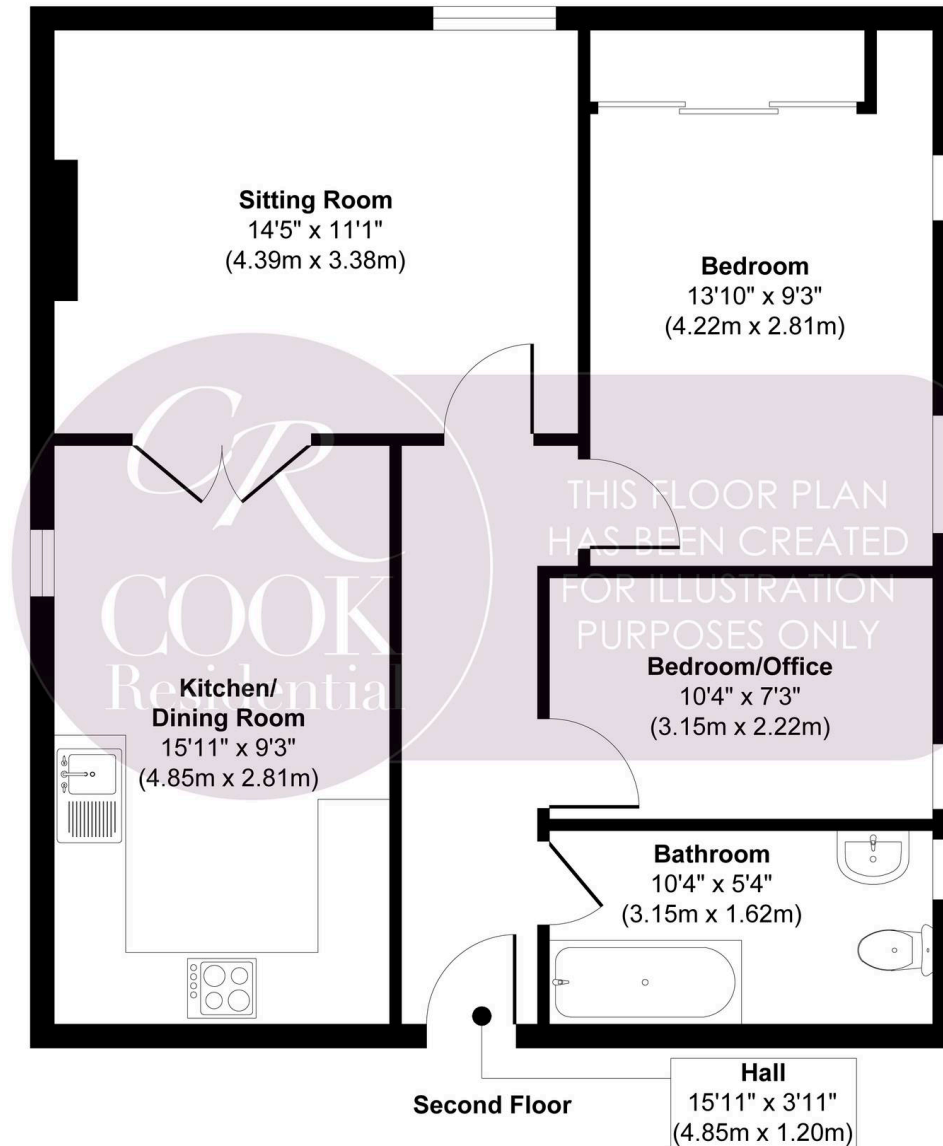
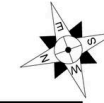

Approx. Gross Internal Floor Area 659 sq. ft / 61.30 sq. m
Produced by Elements Property





Cook Residential

Cook Residential, 4 Tebbit Mews Winchcombe Street – GL52 2NF

01242 500259 • enquiries@cookresidential.co.uk • cookresidential.co.uk

For more detailed information please refer to the Cook Residential website. All information regarding the property details, including its position on Freehold, will be confirmed between vendor and purchaser solicitors. All measurements are approximate and for guidance purposes only.