



Newcastle Drive, Nottingham
£1,005 pcm



Flat 2

Newcastle Drive, Nottingham

Beautiful One-Bedroom Apartment with Balcony – Newcastle Drive, The Park Estate

Comfort Estates are proud to present this charming and fully furnished one-bedroom apartment, located in the prestigious and highly sought-after Park Estate. Situated on the first floor of a well-maintained building on Newcastle Drive, this property offers elegant living in one of Nottingham's most desirable neighbourhoods.

Property Features:

- Spacious double bedroom with ample storage
- Modern en-suite bathroom with white three-piece suite and shower over the bath
- Kitchen with integrated appliances including fridge, freezer, oven, hob, and dishwasher
- Washing machine and tumble dryer conveniently located in the entrance hall
- Comfortable sitting room with French doors leading to a lovely sunroom
- Private south-facing balcony – ideal for enjoying the sunshine
- Offered fully furnished throughout
- Park Estate rates included in the rent
- Free permitted parking available

Located within walking distance of Nottingham City Centre, tram and bus routes, and Nottingham Train Station, this apartment also offers excellent access to the A52 – perfect for professionals commuting in and out of the city.

Please note: Due to licensing restrictions, this property is only suitable for single occupancy. Unfortunately, couples cannot be accepted.





Flat 2

Newcastle Drive, Nottingham

| Park Estate Living | One Double Bedroom | Fully Furnished | Sun Room & Balcony | Free Permit Parking | Available 12th September 25 |
Council Tax band: B

EPC Energy Efficiency Rating: D

EPC Environmental Impact Rating: D

- One Double Bedroom
- Three Piece Bathroom
- First Floor Apartment
- Private Balcony Overlooking The Park Estate and Nottingham Castle
- Sought After Location
- Walking Distance To The City Centre
- White Goods Included
- Free Permit Parking
- Available 12th September 2025



You can include any text here. The text can be modified upon generating your brochure.





Approximate Gross Internal Area
560 sq ft - 52 sq m

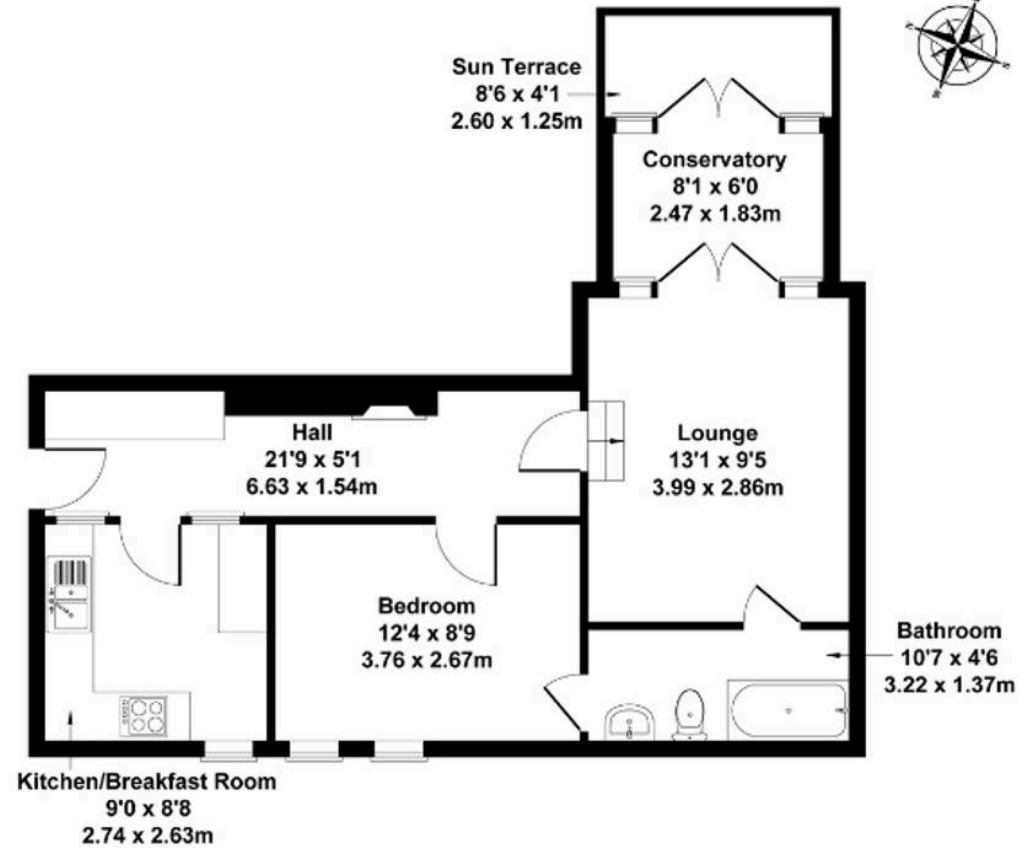

Not to Scale. Produced by The Plan Portal 2025
For Illustrative Purposes Only.

Comfort Estates

Comfort Estates, 47 Derby Road - NG1 5AW

0115 9338997 • info@comfortestates.co.uk • www.comfortestates.co.uk