



Leopold Villa, Roberts Street, Harrogate
Harrogate

Guide Price **£675,000**



MYRINGS



Leopold Villa, Roberts Street

Harrogate

NO CHAIN SALE - A RARE INVESTMENT
OPPORTUNITY - FREEHOLD BLOCK OF 5 FLATS -
IDEAL FOR AIR BNB - PRIVATE LIFT ACCESS TO
ALL FLATS - TOWN CENTRE LOCATION -
COMMUNAL COURTYARD GARDEN

Council Tax band: TBD

Tenure: Freehold

- NO CHAIN SALE
- RARE INVESTMENT OPPORTUNITY
- FREEHOLD BLOCK OF 5 FLATS
- IDEAL FOR AIR BNB
- PRIVATE LIFT ACCESS TO ALL FLATS
- COMMUNAL COURTYARD GARDEN
- TOWN CENTRE LOCATION

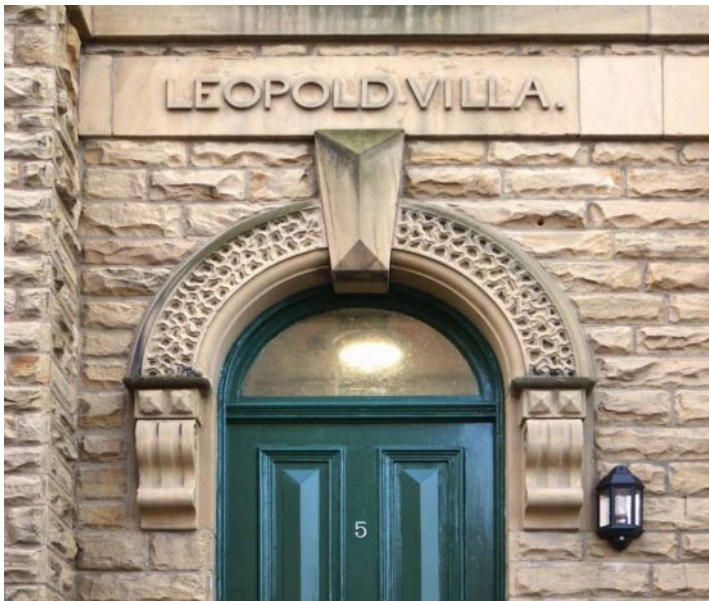

MYRINGS



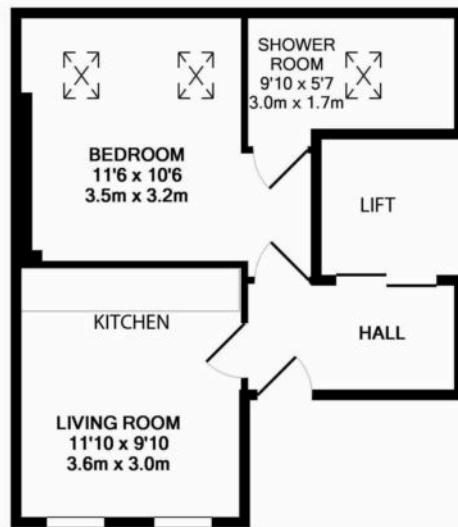

TOTAL APPROX. FLOOR AREA 366 SQ.FT. (34.0 SQ.M.)

Whilst every attempt has been made to ensure the accuracy of the floor plan contained here, measurements of doors, windows, rooms and any other items are approximate and no responsibility is taken for any error, omission, or mis-statement. This plan is for illustrative purposes only and should be used as such by any prospective purchaser. The services, systems and appliances shown have not been tested and no guarantee as to their operability or efficiency can be given
Made with Metropix ©2015

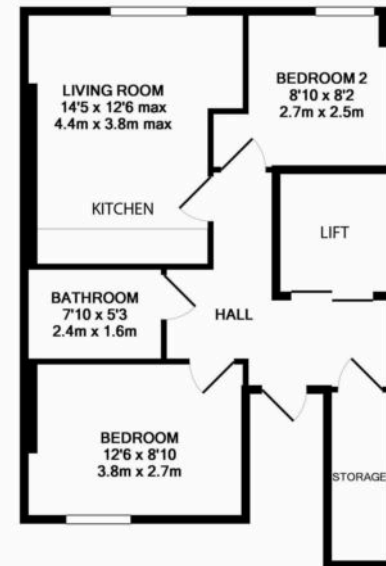

TOTAL APPROX. FLOOR AREA 505 SQ.FT. (47.0 SQ.M.)

Whilst every attempt has been made to ensure the accuracy of the floor plan contained here, measurements of doors, windows, rooms and any other items are approximate and no responsibility is taken for any error, omission, or mis-statement. This plan is for illustrative purposes only and should be used as such by any prospective purchaser. The services, systems and appliances shown have not been tested and no guarantee as to their operability or efficiency can be given
Made with Metropix ©2015

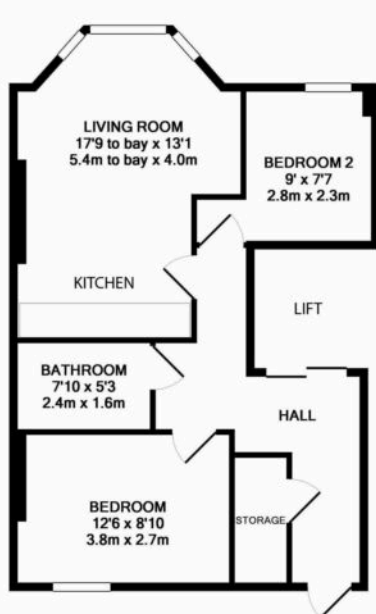

TOTAL APPROX. FLOOR AREA 548 SQ.FT. (50.9 SQ.M.)

Whilst every attempt has been made to ensure the accuracy of the floor plan contained here, measurements of doors, windows, rooms and any other items are approximate and no responsibility is taken for any error, omission, or mis-statement. This plan is for illustrative purposes only and should be used as such by any prospective purchaser. The services, systems and appliances shown have not been tested and no guarantee as to their operability or efficiency can be given
Made with Metropix ©2015



TOTAL APPROX. FLOOR AREA 447 SQ.FT. (41.5 SQ.M.)

Whilst every attempt has been made to ensure the accuracy of the floor plan contained here, measurements of doors, windows, rooms and any other items are approximate and no responsibility is taken for any error, omission, or mis-statement. This plan is for illustrative purposes only and should be used as such by any prospective purchaser. The services, systems and appliances shown have not been tested and no guarantee as to their operability or efficiency can be given
Made with Metropix ©2015

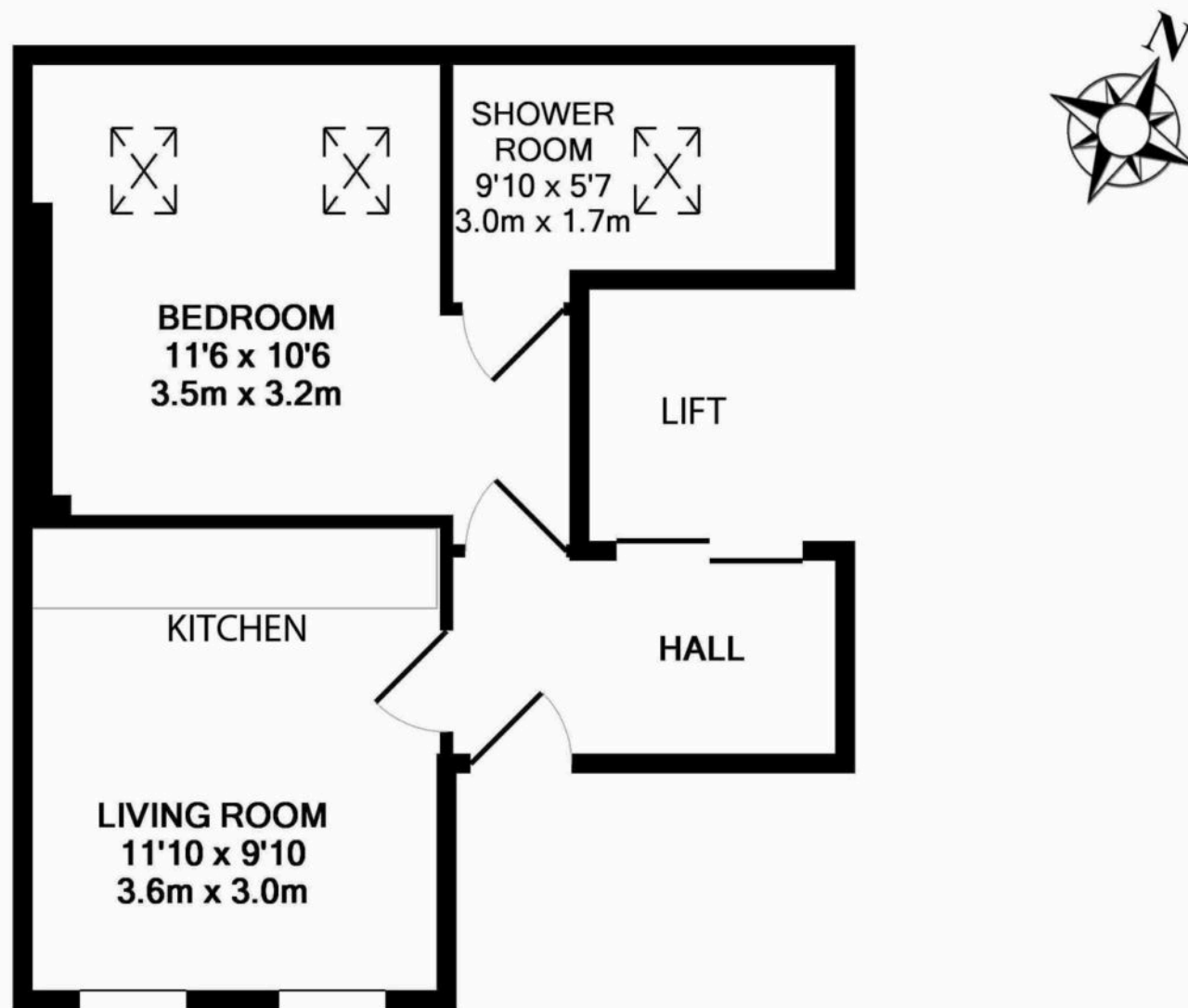

TOTAL APPROX. FLOOR AREA 366 SQ.FT. (34.0 SQ.M.)

Whilst every attempt has been made to ensure the accuracy of the floor plan contained here, measurements of doors, windows, rooms and any other items are approximate and no responsibility is taken for any error, omission, or mis-statement. This plan is for illustrative purposes only and should be used as such by any prospective purchaser. The services, systems and appliances shown have not been tested and no guarantee as to their operability or efficiency can be given

Made with Metropix ©2015





Myrings Estate Agents

Myrings Estate Agents Ltd, 10 Princes Square - HG1 1LX

01423

566400

▪ enquiries@myringsestateagents.com ▪ <http://myringsestateagents.com/>

