



30 Romulus Way, Nuneaton
£235,000

bayzos.



30 Romulus Way

Nuneaton, Nuneaton

Sought After Location Of Nuneaton | Open Plan
Kitchen/Dining Room | Driveway Offering Off Road
Parking | Downstairs W/C | South Facing Low
Maintenance Garden With Shed | Immaculately
Presented Throughout | EPC Current: B Potential: A |
Approx Floor Area 63 Sqm
Council Tax band: B

Tenure: Freehold

EPC Energy Efficiency Rating: B

EPC Environmental Impact Rating: B



Ground Floor

Approx. 33.2 sq. metres (357.9 sq. feet)

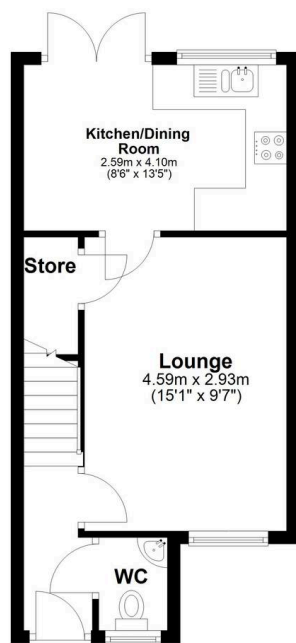

First Floor

Approx. 29.9 sq. metres (321.9 sq. feet)

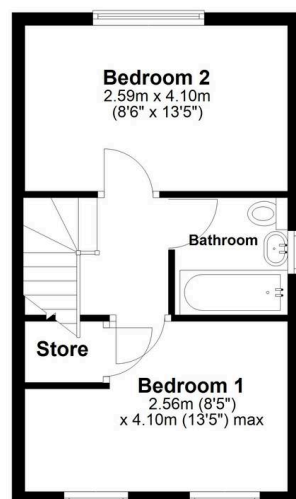

Total area: approx. 63.1 sq. metres (679.7 sq. feet)



Bayzos Estate Agents

9 The Square, Kenilworth - CV8 1EF

0330 124 6533 • info@bayzos.co.uk • bayzos.co.uk/

bayzos.