



**Birnam Road, N4 3LQ**  
**£2,850 pcm**

**DAVID  
ANDREW**

your  
most  
valuable  
asset



A charming and spacious three-bedroom split-level apartment, set across the top floors of a handsome Victorian conversion, ideally located in the heart of Stroud Green and just a short walk from Finsbury Park Station.

The property boasts a bright and generously sized reception room, three well-proportioned double bedrooms, a modern kitchen, and a stylish three-piece bathroom. Neutral décor throughout, gas central heating, double-glazed windows, and ample storage space further enhance the appeal, making it an ideal home for professional sharers or a family.

Perfectly positioned, Birnam Road offers easy access to Finsbury Park Station (Victoria & Piccadilly Lines, National Rail), while benefiting from the array of independent cafés, restaurants, and amenities of Stroud Green. Offered furnished and available from 11th October.

Council Tax band: D / EPC Energy Efficiency Rating: D

- Spacious Three-Bedroom Apartment
- Split Level
- Comprising 742 sqft / 69 sqm
- Separate Kitchen
- Ample Natural Light
- Ample Storage
- Walking Distance to Amenities
- Walking Distance to Finsbury Park Station
- Available 11th of October
- Offered Furnished







Birnam Road, London, N4 3LQ

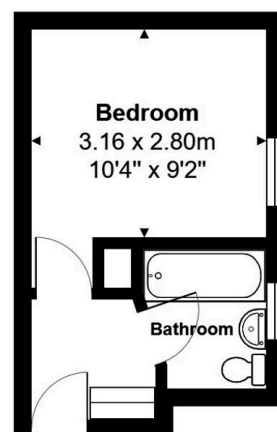

First Floor

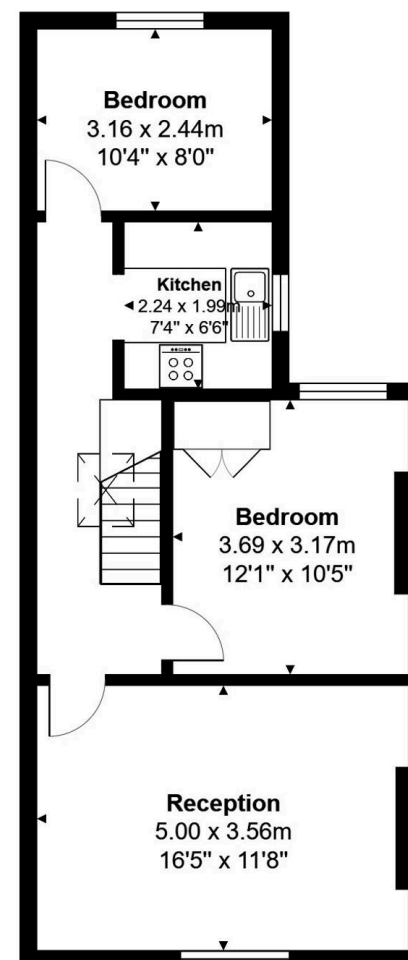

Second Floor

Total Area: 68.9 m<sup>2</sup> ... 742 ft<sup>2</sup>

All measurements are approximate and for display purposes only.

scan to book  
a viewing



#### Archway Office

671 Holloway Road  
London, N19 5SE

T (0)20 7619 3750

#### Highbury Office

90 Highbury Park  
London, N5 2XE

T (0)20 7354 9111

#### Finsbury Park Office

167 Stroud Green Road  
London, N4 3PZ

T (0)20 7281 2000

#### Property Management Office

235 Blackstock Road  
London, N5 2LL

T (0)20 7354 9222

has been exercised in the  
of these particulars,  
bout the property must not be  
as representations of  
r fact. Prospective applicants  
and rely upon their own  
nd those of professional  
es. David Andrew Estates  
ability for any error contained  
in these particulars.

