

CR



Flat 5, Viceroy Corner, 2 Brookbank Close - GL50 3NA

Cheltenham

Guide Price £160,000





## Flat 5

Viceroy Corner, Cheltenham

Modern 1-bed apartment in Cheltenham, with open-plan layout, long lease, allocated parking. Ideal for first-time buyers/investors. Close to town centre and transport links.

Council Tax Band A.

Council Tax band: A

Tenure: Leasehold

EPC Energy Efficiency Rating: C

EPC Environmental Impact Rating: B

- No Onward Chain
- One Bedroom First Floor Apartment
- Situated Close to The Town Centre & Montpellier
- Open Plan Kitchen / Living / Dining Area
- Well Presented Throughout
- Allocated Parking Space







You can include any text here. The text can be modified upon generating your brochure.



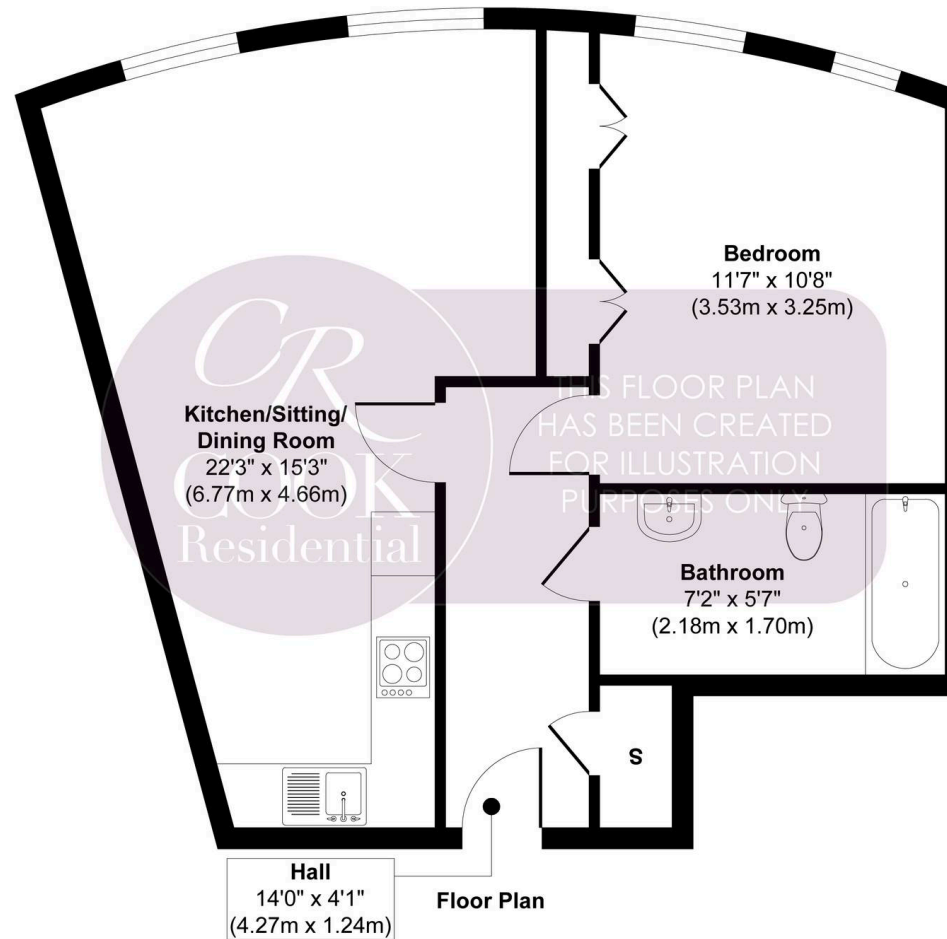

Approx. Gross Internal Floor Area 559 sq. ft / 52.00 sq. m  
Produced by Elements Property







## Cook Residential

Cook Residential, 4 Tebbit Mews Winchcombe Street – GL52 2NF

01242 500259 • [enquiries@cookresidential.co.uk](mailto:enquiries@cookresidential.co.uk) • [cookresidential.co.uk](http://cookresidential.co.uk)

For more detailed information please refer to the Cook Residential website. All information regarding the property details, including its position on Freehold, will be confirmed between vendor and purchaser solicitors. All measurements are approximate and for guidance purposes only.