



Bartlams.

4 St. Cuthberts Crescent, Albrighton - WV7 3HW

Offers in Region of £297,000



4 St. Cuthberts Crescent

Albrighton, Wolverhampton

A charming three-bedroom semi-detached home in a sought-after Albrighton location.

Set within a quiet residential area of Albrighton, this attractive semi-detached home offers spacious accommodation, a bright and welcoming layout, and a low-maintenance garden — perfect for families or first-time buyers alike.

As you step inside, a generous entrance hall provides a warm welcome and gives access to all ground floor rooms as well as the staircase to the first floor. To the front of the property, the lounge is light and inviting, with a large picture window flooding the space with natural light. To the rear, the kitchen and dining area offer an excellent space for both everyday living and entertaining, with direct access into the rear garden and Conservatory to the side.

The garden itself is level and easy to maintain, with plenty of room for outdoor seating, play, or gardening — making it a versatile and enjoyable extension of the home.

B.



4 St. Cuthberts Crescent

Albrighton, Wolverhampton

On the first floor, there are three well-proportioned bedrooms and a neatly presented family bathroom with modern fittings. Throughout, the property has been well cared for and benefits from a bright, airy feel.

Buyer's information: -

As part of our legal obligations as an estate agent and in line with UK anti-money laundering regulations, successful purchasers must complete an Anti-Money Laundering (AML) check. We use a specialist third-party service to verify your identity. The cost of these checks is £60 (including VAT). This fee is paid in advance when an offer is agreed, and prior to the issuance of a sales memorandum. Please note that this charge is non-refundable.



B.

Approx Gross Internal Area
92 sq m / 985 sq ft



Ground Floor
Approx 52 sq m / 561 sq ft

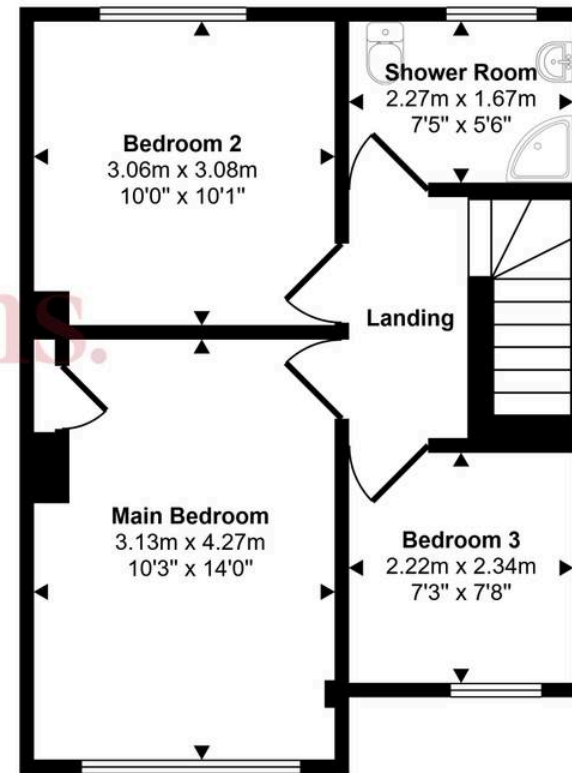

First Floor
Approx 39 sq m / 424 sq ft

Bartlams Albrighton

66 High Street, Albrighton - WV7 3JA

01902 374532

albrighton@bartlams.co.uk

www.bartlams.co.uk/

NOTICE: These particulars, although believed to be correct, do not constitute any part of an offer or contract. All statements contained in these particulars as to this property are made without responsibility and are not to be relied upon as statements or representations of warranty whatsoever in relation to property. Any intending purchaser must satisfy themselves by inspection or otherwise as to the correctness each of the statements contained in these particulars. All measurements are approximate and for illustrative purposes only. Photographs are produced for general information and it must not be inferred that any item shown is included in the sale. DISCLOSURE: As a professional Estate Agency our clients employ us to look after their best interests. This includes providing them with full details of offers made to purchase their property. To ensure our obligations to our clients are met we need to check the status of all potential purchasers. If you make an offer on this property we will ask a member of The Finance Family to contact you to verify your status. They are a leading firm of Independent Financial Advisers and Mortgage Brokers. Should they transact any business resulting from our introduction then we may receive a commission.

