

## 72 Broadmeads, Ware

£230,000 Leasehold

Two Bedroom Flat • Requires Modernisation • Long Lease • Garage En-bloc • Chain Free • Gated Riverside Development





#### Entrance Hall

#### Lounge

15' 11" x 12' 6" (4.85m x 3.81m)

#### Kitchen

9' 7" x 8' 1" (2.92m x 2.46m)

#### Bedroom

16' 0" x 12' 6" (4.88m x 3.81m)

#### Bedroom

12' 7" x 11' 10" (3.84m x 3.61m)

#### Bathroom





Council Tax band: C

Tenure: Leasehold



Ground Floor  
760 sq.ft. (70.6 sq.m.) approx.

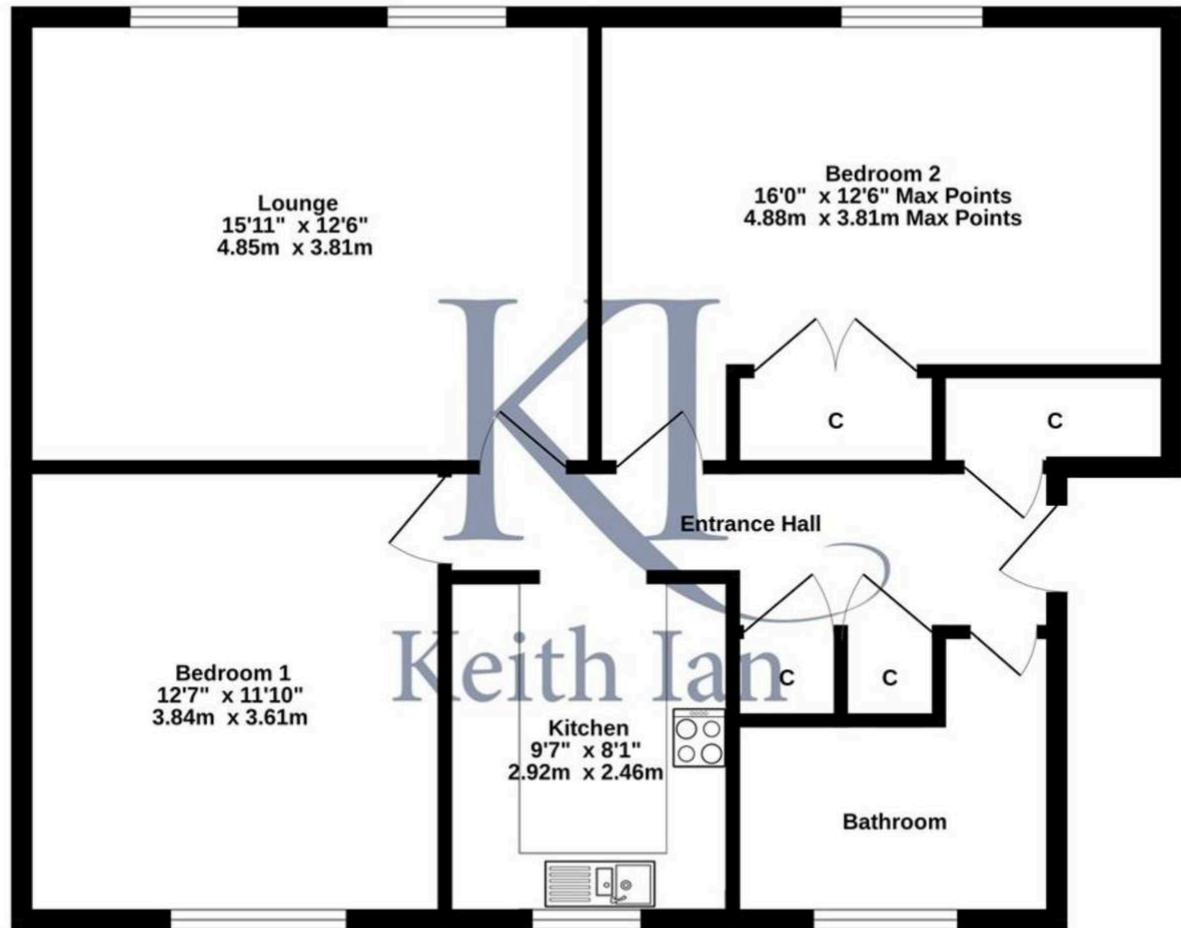

TOTAL FLOOR AREA : 760 sq.ft. (70.6 sq.m.) approx.

Whilst every attempt has been made to ensure the accuracy of the floorplan contained here, measurements of doors, windows, rooms and any other items are approximate and no responsibility is taken for any error, omission or mis-statement. This plan is for illustrative purposes only and should be used as such by any prospective purchaser. The services, systems and appliances shown have not been tested and no guarantee as to their operability or efficiency can be given.

Made with Metropix ©2025