

ATHERTONS
ESTATE & LETTING AGENTS

EST. 1985

5 Diamond Place, Bournemouth

Bournemouth

Guide Price **£400,000**

ATHERTONS
ESTATE & LETTING AGENTS

EST. 1985



5 Diamond Place

Bournemouth, Bournemouth

A modern, three bedroom DETACHED family home, situated in a CUL-DE-SAC location. Offered with a COMPLETE CHAIN, as well as a single GARAGE, KITCHEN/DINER and a southerly aspect rear garden.

Council Tax band: D

Tenure: Freehold

EPC Energy Efficiency Rating: C

EPC Environmental Impact Rating:

- Modern Family Home
- Complete Chain
- En-Suite To Master Bedroom
- Driveway & Garage
- Southerly Aspect Rear Garden
- Great Access Routes To Royal Bournemouth Hospital & JP Morgan



GROUND FLOOR
583 sq.ft. (54.2 sq.m.) approx.

1ST FLOOR
392 sq.ft. (36.4 sq.m.) approx.

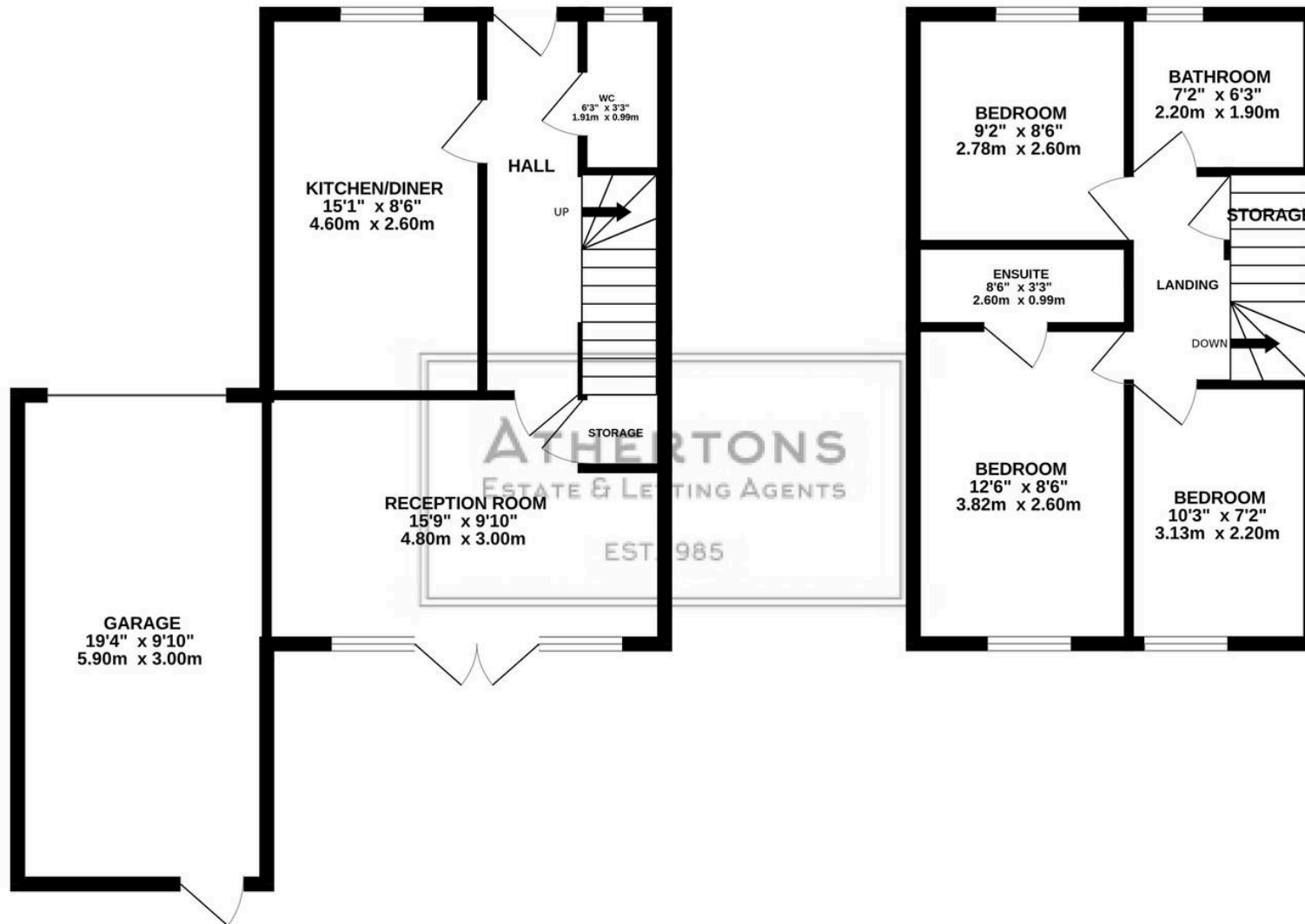

TOTAL FLOOR AREA : 975 sq.ft. (90.6 sq.m.) approx.

Whilst every attempt has been made to ensure the accuracy of the floorplan contained here, measurements of doors, windows, rooms and any other items are approximate and no responsibility is taken for any error, omission or mis-statement. This plan is for illustrative purposes only and should be used as such by any prospective purchaser. The services, systems and appliances shown have not been tested and no guarantee as to their operability or efficiency can be given.
Made with Metropix ©2025



Athertons Estate & Letting Agents

Athertons, 508 Wimborne Road - BH9 2EX

01202 512348 • bournemouth@athertonssea.com • www.athertonsestateagents.com