



6 Tree Walk, Stretford

Manchester

Guide Price **£150,000**

6 Tree Walk

Stretford, Manchester

Council Tax band: A

Tenure: Leasehold

EPC Energy Efficiency Rating: C

EPC Environmental Impact Rating: C

- No Chain
- Spacious Bedrooms
- Second Floor
- Separate Storage Room









GROUND FLOOR

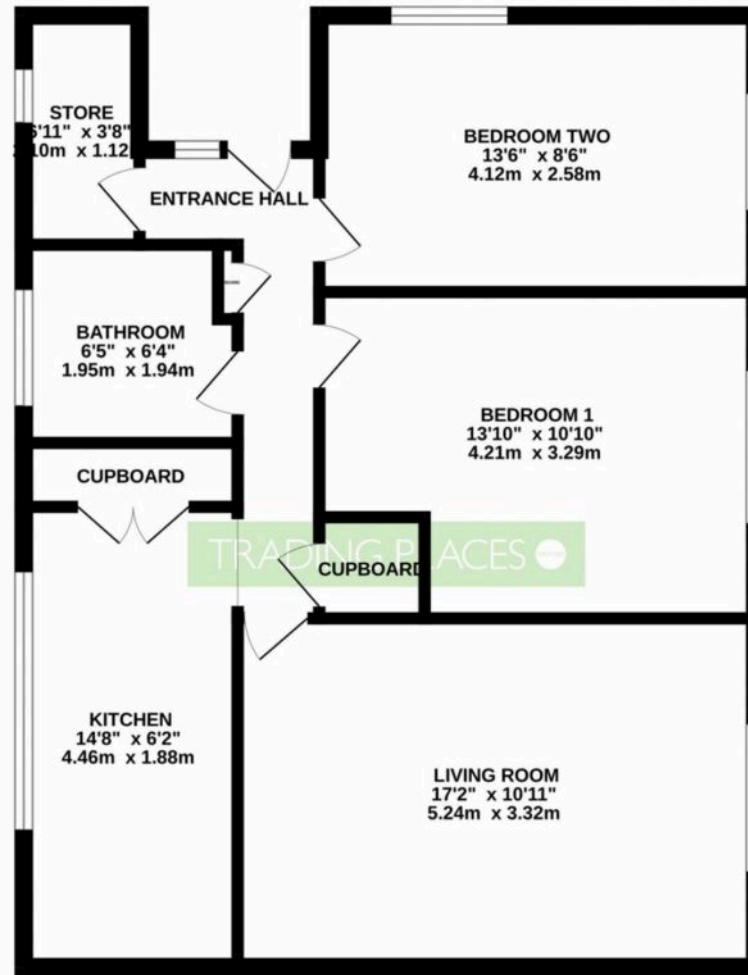

6 TREE WALK, STRET FORD, MANCHESTER, M32 9AL

Whilst every attempt has been made to ensure the accuracy of the floorplan contained here, measurements of doors, windows, rooms and any other items are approximate and no responsibility is taken for any error, omission or mis-statement. This plan is for illustrative purposes only and should be used as such by any prospective purchaser. The services, systems and appliances shown have not been tested and no guarantee as to their operability or efficiency can be given.
Made with Metropix ©2024



Trading Places

Trading Places, 133 Barton Road, Stretford - M32 8DN

01618659220 • stretford@tradingplaces.co.uk • www.tradingplaces.co.uk/