



Park Lodge, Park Drive, Nottingham
£900 pcm



Park Lodge

Park Drive, Nottingham

Comfort Estates are delighted to present this spacious one-bedroom ground floor apartment located on Park Drive in the highly sought-after Park Estate.

The apartment comprises an entrance hallway, a bright lounge/dining room with access to a private patio, a generously sized double bedroom, and a modern bathroom featuring a large shower cubicle. The private patio also leads directly into the well-maintained communal garden. Free on-street permit parking is available.

The Park Estate is a prestigious residential area renowned for its beautiful Victorian architecture. Ideally positioned just a short walk from Nottingham City Centre, residents can enjoy easy access to a wide range of shops, cafés, restaurants, bars and amenities. Nottingham Train Station is also within walking distance, with excellent transport links in and out of the city close by.

Available now and offered fully furnished, with kitchen appliances included.





Bedroom

10' 10" x 9' 7" (3.30m x 2.91m)

Spacious double bedroom, neutrally decorated and fully furnished with a bed and mattress, bedside tables, chest of drawers and a wardrobe.

Lounge/Diner

14' 6" x 10' 10" (4.41m x 3.30m)

Bright and airy living/dining area, offered fully furnished with a sofa, coffee table, shelving unit, and dining table with chairs. With large windows and a door leading out to the patio, this room enjoys an abundance of natural light, creating a warm and welcoming space.

Kitchen

11' 6" x 5' 10" (3.51m x 1.79m)

Fully fitted kitchen featuring white wall and base units, grey flooring and tiled splashbacks, complemented by sleek black worktops. The kitchen comes complete with all essential appliances, including a washing machine, gas hob, oven, extractor fan and fridge/freezer.

Bathroom

9' 4" x 5' 0" (2.84m x 1.52m)

Spacious bathroom with neutral décor and grey tiled flooring, featuring a large double-door shower cubicle, heated towel rail, toilet, wash basin and mirrored cabinet.

Hallway

19' 2" x 5' 0" (5.83m x 1.53m)

Upon entering the apartment there is a spacious hallway complete with storage cabinet. The hallway leads to all rooms.



Approximate Gross Internal Area
484 sq ft - 45 sq m

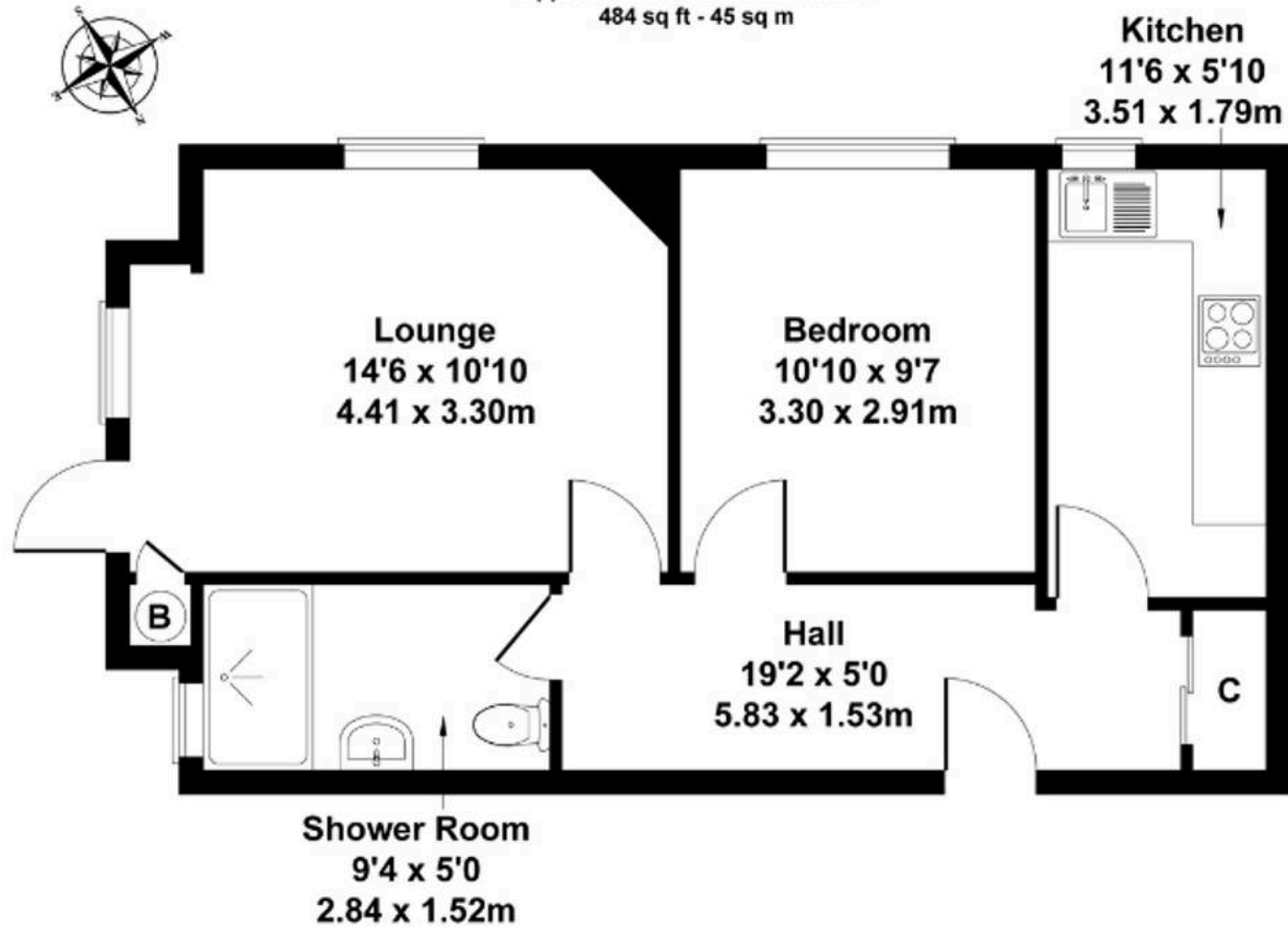

Not to Scale. Produced by The Plan Portal 2025
For Illustrative Purposes Only.



Comfort Estates

Comfort Estates, 47 Derby Road - NG1 5AW

0115 9338997 • info@comfortestates.co.uk • www.comfortestates.co.uk