



Portland Square, Portland Road, Nottingham
£1,000 pcm



Portland Square

Portland Road, Nottingham

Comfort Estates are pleased to present this spacious two-bedroom apartment located in the popular Portland Square building on Portland Street.

The apartment comprises two double bedrooms, a bathroom with shower over the bath, and a bright open-plan lounge, dining and kitchen area with all kitchen appliances included. The property has been repainted throughout and is offered fully furnished.

Additional benefits include one allocated parking space.

Portland Square is ideally situated within walking distance of Nottingham City Centre, offering a wide range of shops, cafés, bars and restaurants. Further local amenities can be found along Alfreton Road, with excellent access to the M1 also nearby.

Available now – contact Comfort Estates today to arrange a viewing.





Living/Dining Room – 28' 5" x 19' 6" (8.66m x 5.95m)

The property benefits from a spacious open-plan living and dining area, fully furnished with a sofa, coffee table, TV unit, additional side tables, and a dining table with chairs. Two large windows allow plenty of natural light to flood the space, creating a bright and welcoming atmosphere. There is also a handy storage cupboard located in the living area.

Kitchen – 28' 5" x 19' 6" (8.66m x 5.95m)

This well-equipped kitchen offers everything you need, including a breakfast bar for casual dining. Appliances include a free-standing fridge/freezer, washing machine, dishwasher, microwave, gas hob and oven. The kitchen also benefits from ample worktop space and a range of wall and base units providing plenty of storage.

Bedroom 1 – 17' 4" x 9' 4" (5.28m x 2.85m)

Large double bedroom furnished with a bed and mattress, wardrobe, desk with chair, chest of drawers and mirror. The room benefits from a large window and wall light pendants, creating a bright and inviting space.

Bedroom 2 – 14' 2" x 9' 1" (4.32m x 2.76m)

A further double bedroom furnished with a bed and mattress, wardrobe, chest of drawers, desk with chair and shelving unit. The room benefits from a large window and wall pendant lights, making it bright and welcoming.

Bathroom – 7' 3" x 6' 11" (2.21m x 2.11m)

Spacious bathroom with shower over bath, wall mounted mirrors, sink with cabinet, and toilet.





Approximate Gross Internal Area
700 sq ft - 65 sq m

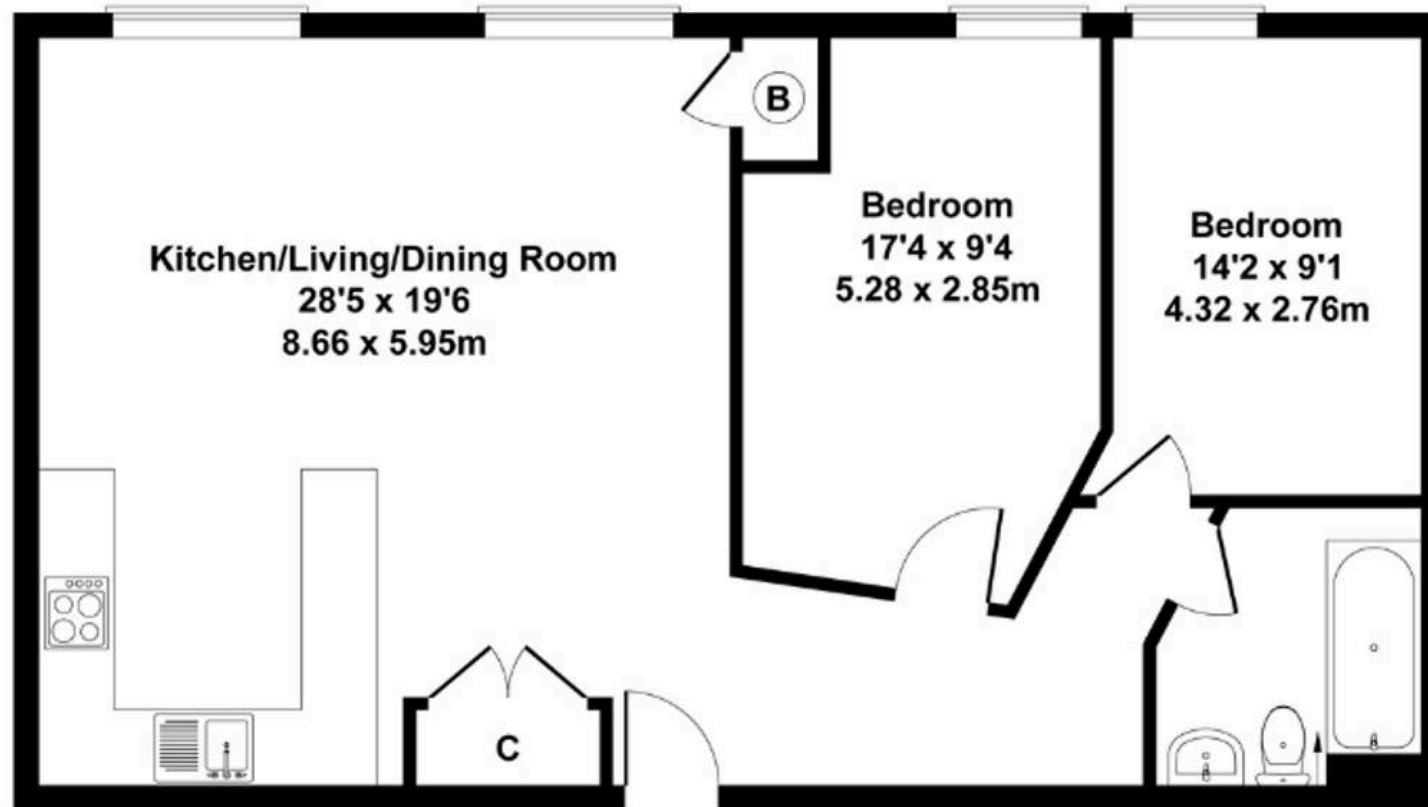

Not to Scale. Produced by The Plan Portal 2025
For Illustrative Purposes Only.



Comfort Estates

Comfort Estates, 47 Derby Road - NG1 5AW

0115 9338997 • info@comfortestates.co.uk • www.comfortestates.co.uk