



FINDING YOU A HOME
SINCE 1972

B

Apt 128, Block 3, Spectrum, Gloucester Street, St. Helier
£275,000

BROADLANDS

FINDING YOU A HOME SINCE 1972

Apt 128, Block 3, Spectrum, Gloucester Street

St. Helier, Jersey

- Secure external store cupboard
- Great first home or ideal buy to let
- Lift access to all floors
- Communal roof terrace
- Purpose built 1 bedroom apartment
- Third floor
- Walk to work
- Possible rental of £1,050 pcm
- Please call Doug on 077007 02585
- Please contact James on 07829835076 or james@broadlandsjersey.com



Apt 128, Block 3, Spectrum, Gloucester Street

St. Helier, Jersey

- Secure external store cupboard
- Great first home or ideal buy to let
- Lift access to all floors
- Communal roof terrace
- Purpose built 1 bedroom apartment
- Third floor
- Walk to work
- Possible rental of £1,050 pcm
- Please call Doug on 077007 02585
- Please contact James on 07829835076 or james@broadlandsjersey.com



Apt 128, Block 3, Spectrum, Gloucester Street

St. Helier, Jersey

Fantastic one bedroom purpose built apartment in the Spectrum development. Offering one double bedroom, living room/kitchen and modern bathroom, plus utility cupboard and good storage space in the basement. Although no onsite parking, there are several public car parks close by. Located on the third floor this is great value for money.





Living

Open plan living area with kitchen units to one end. Kitchen complete with fridge/freezer, oven and brand new hob. Recently laid Amtico flooring

Sleeping

Double bedroom. Bathroom comprising bath with shower over, wash hand basin and W.C.

Service charge

All mains except gas. Fully double glazed. Electric panel heaters. Building service charge of £117 per month includes Parish rate, management fees, communal cleaning, communal lighting, lift maintenance, caretaker and building insurance.

Services

Mains services, electric heating. Separate store cupboard in the garage below plus bike storage facilities.



GROUND FLOOR
355 sq.ft. (32.9 sq.m.) approx.

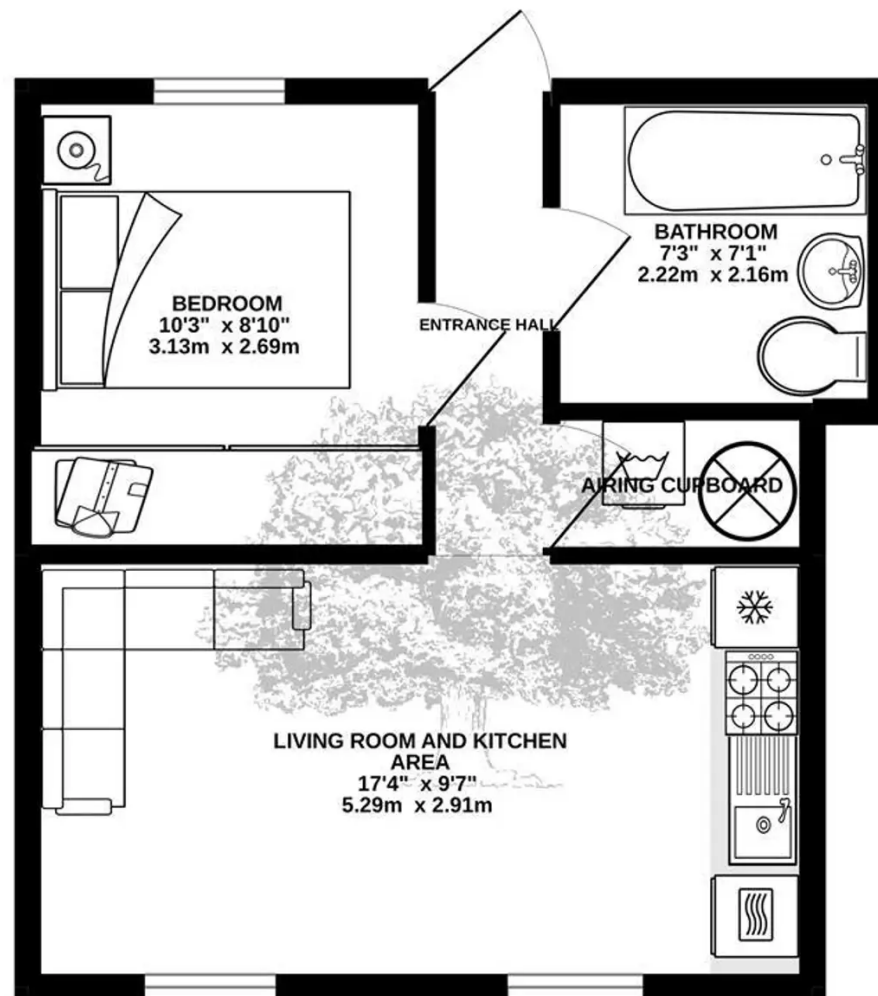

TOTAL FLOOR AREA : 355 sq.ft. (32.9 sq.m.) approx.

Whilst every attempt has been made to ensure the accuracy of the floorplan contained here, measurements of doors, windows, rooms and any other items are approximate and no responsibility is taken for any error, omission or mis-statement. This plan is for illustrative purposes only and should be used as such by any prospective purchaser. The services, systems and appliances shown have not been tested and no guarantee as to their operability or efficiency can be given.
Made with Metropix ©2022



Broadlands

Broadlands Estates, Library Place - JE2 3NL

01534 880 770 • enquiries@broadlandsjersey.com • www.broadlandsjersey.com/

BROADLANDS

FINDING YOU A HOME SINCE 1972