



Queens Drive, Wavertree
Liverpool

£700,000



- Magnificent Four Bedroom Detached Residence
- Envious Location On Sought-After Queens Drive
- Generously Proportioned & Bursting With Charm
- Entrance Hall, Two Living Rooms & Dining Area
- Sizable Kitchen Diner, Utility & Ground Floor WC
- Four Bright & Generously Sized Double Bedrooms
- Ensuite To Master & Three-Piece Bathroom Suite
- Landscaped Garden, Driveway & Integral Garage

Council Tax band: F

Tenure: Freehold

EPC Energy Efficiency Rating: D

EPC Environmental Impact Rating: D

Queens Drive

Wavertree, Liverpool

Standing proudly on the sought-after Queens Drive, L15, is this magnificent four bedroom detached residence, showcased to the sales market courtesy of appointed agents Move Residential. The property boasts an imposing double frontage and offers a wealth of beautifully maintained living space within. Retaining many characterful original features, this residence is bursting with charm and offers exciting scope for modernisation throughout, presenting an opportunity not to be missed for those searching for a forever family home they can put their own stamp on, in one of South Liverpool's most desirable locations.

Entering via the porch, you are greeted into the property by a grand entrance hall which leads through to two spacious reception rooms on either side, both awash with natural light courtesy of bay-windows, providing welcoming spaces for relaxation and entertaining. The sitting room to the right flows seamlessly through to a formal dining area which enjoys a set of french doors out to the rear garden, and continuing through you will find a generously sized kitchen diner which offers a social setting for casual dining and cooking in company. Concluding the ground floor is a convenient WC and a utility room located within the integral garage.



Queens Drive

Wavertree, Liverpool

Ascending to the first floor, you will discover four well-proportioned double bedrooms, each receiving an abundance of daylight. The master room enjoys the added luxury of a dressing room and a contemporary style ensuite shower room, and serving the remaining sleeping accommodation is a deluxe three-piece family bathroom suite.

Externally, the residence is further enhanced by a meticulously landscaped rear garden which provides a fantastic outdoor space for the whole household to enjoy, surrounded by established greenery borders which offer privacy and seclusion. A lawn provides plenty of room for recreational activities, whilst a raised patio area presents a serene spot for al-fresco dining and entertaining. To the front, a substantial driveway provides ample off-road parking and the garage offers additional storage space.

A viewing is highly recommended to fully appreciate the versatile proportions and potential that this remarkable residence has to offer, promising to make a truly incomparable future home for a very lucky family.















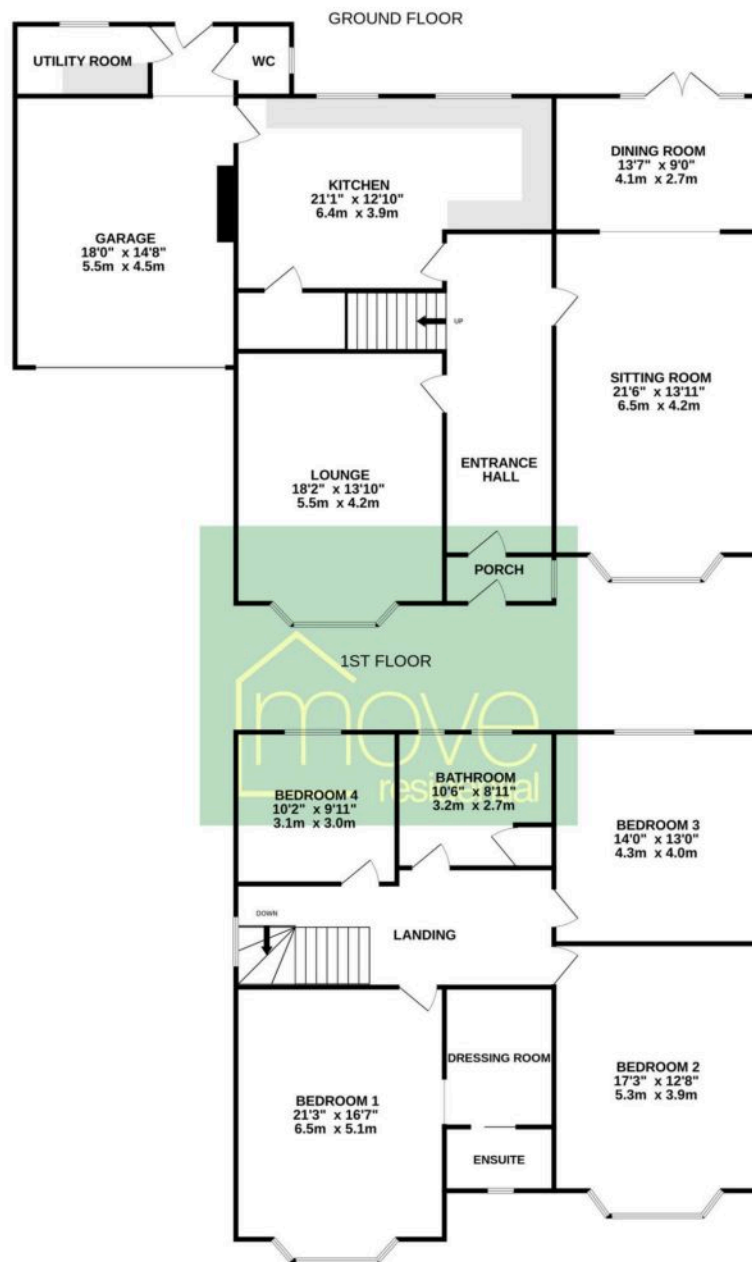

TOTAL FLOOR AREA : 2634sq.ft. (244.7 sq.m.) approx.

Whilst every attempt has been made to ensure the accuracy of the floorplan contained here, measurements of doors, windows, rooms and any other items are approximate and no responsibility is taken for any error, omission or mis-statement. This plan is for illustrative purposes only and should be used as such by any prospective purchaser. The services, systems and appliances shown have not been tested and no guarantee as to their operability or efficiency can be given.

Made with Metropix ©2026