



3 Pinfold Court, Whitefield
Manchester

In Excess of £125,000

cliveanthony
sales & lettings

3 Pinfold Court

Whitefield, Manchester

Clive Anthony are pleased to offer for sale this one double bedroom ground floor apartment which is located in one of Whitefield's most sought after locations. The apartment is within a lift assisted development and is offered with no onward chain. Council Tax band: A

Tenure: Leasehold

- One Double Bedroom Ground Floor Apartment
- Highly Sought After Location
- Well Kept Communal Gardens
- Communal Parking
- In Need Of Modernisation
- Priced to Attract Early Interest
- Ground Floor Access
- No Onward Chain







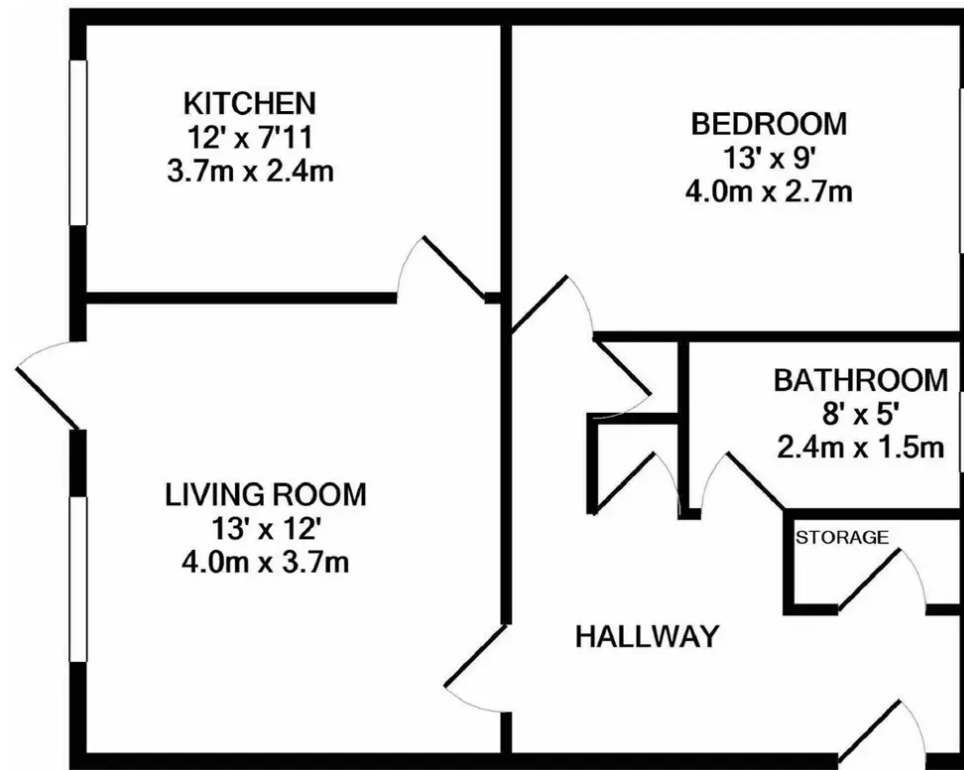

TOTAL APPROX. FLOOR AREA 524 SQ.FT. (48.7 SQ.M.)

Whilst every attempt has been made to ensure the accuracy of the floor plan contained here, measurements of doors, windows, rooms and any other items are approximate and no responsibility is taken for any error, omission, or mis-statement. This plan is for illustrative purposes only and should be used as such by any prospective purchaser. The services, systems and appliances shown have not been tested and no guarantee as to their operability or efficiency can be given

Made with Metropix ©2021

Clive Anthony Sales

487 Bury New Road, Prestwich - M25 1AD

0161 773 1111

prestwich@cliveanthony.co.uk

www.cliveanthony.co.uk

