



16 Ernest Street, Prestwich
Manchester

£975 pcm

cliveanthony
sales & lettings

16 Ernest Street

Prestwich, Manchester

Clive Anthony are pleased to offer for rental this well presented three bedroom mid terrace property positioned within easy walking distance of the popular Prestwich Village. This period terrace is in move in condition.

Council Tax band: B

Tenure: Freehold

- Three Bedroom Mid Terrace
- Highly Sought After Location
- Well Presented Throughout
- Close to Prestwich Village
- Spacious Lounge
- Large Kitchen/Diner









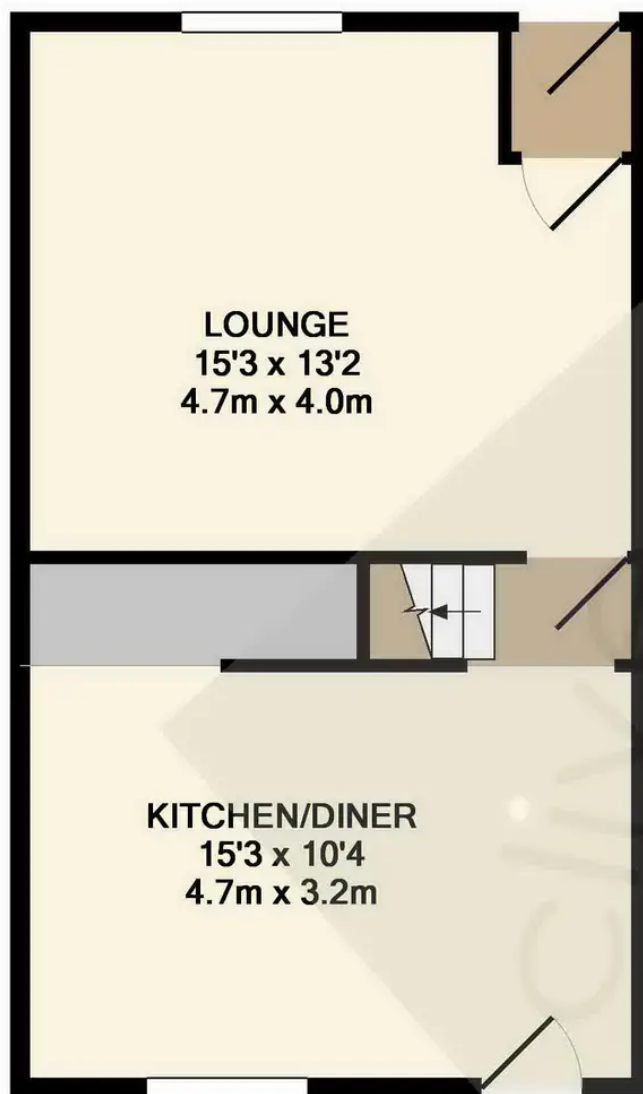

GROUND FLOOR
APPROX. FLOOR
AREA 37.1 SQ.M.
(399 SQ.FT.)

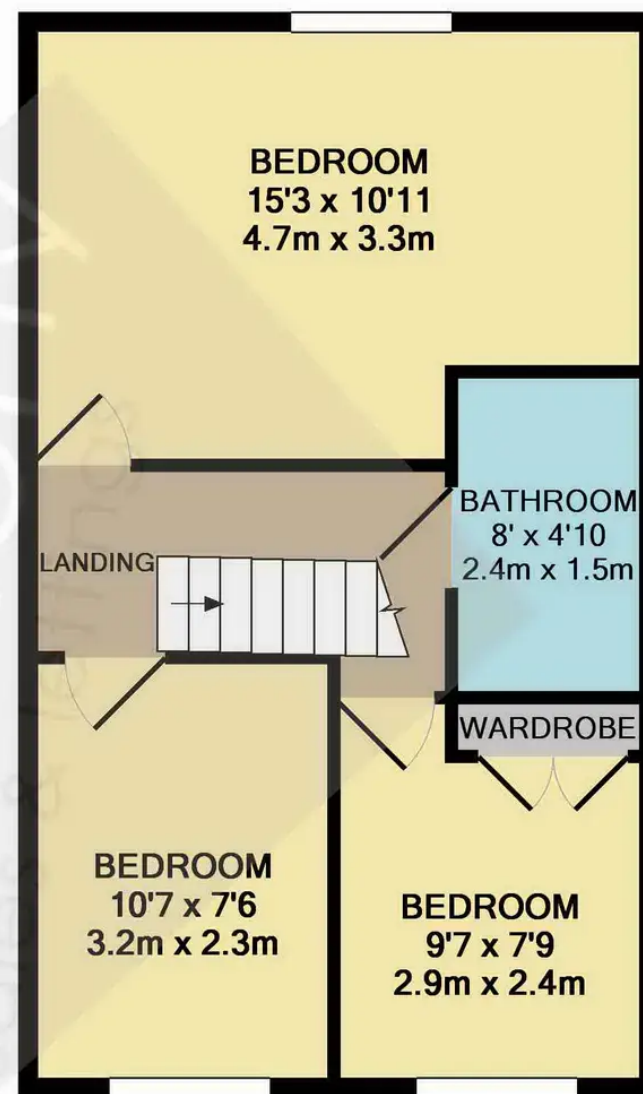

1ST FLOOR
APPROX. FLOOR
AREA 37.1 SQ.M.
(399 SQ.FT.)

TOTAL APPROX. FLOOR AREA 74.2 SQ.M. (799 SQ.FT.)

Made with Metropix ©2015



Clive Anthony Lettings

487 Bury New Road, Prestwich - M25 1AD

0161 796 1000

whitefield@cliveanthony.co.uk

www.cliveanthony.co.uk/

cliveanthony
sales & lettings