



Denning Drive, Irby, Wirral

Offers Over £250,000





Denning Drive, Irby, Wirral CH61 4YH

- Traditional Three Bedroom Semi Detached Home
- Beautifully Maintained Living Accommodation
- Offered to the Sales Market with No Onward Chain
- Porch, Lounge with Fireplace and Well Fitted Kitchen Diner
- Three Bedrooms and a Modern Shower Room
- Low Maintenance Gardens to the Front and Rear
- Driveway Providing Ample Parking and Detached Garage
- Prime Irby Location Within Easy Reach of Amenities

This beautifully maintained three bedroom semi detached home presents an exceptional opportunity in the heart of Irby, offered to the sales market with no onward chain an early inspection is strongly recommended. Welcoming you with a practical porch, the property opens into a spacious lounge featuring a charming fireplace. The well fitted kitchen diner is designed for both style and functionality, providing ample space for family meals and gatherings. Upstairs, three well proportioned bedrooms offer comfortable accommodation along with a modern shower room. Located in a prime Irby position, this home is ideally situated within easy reach of excellent local amenities, schools and transport links, making it an ideal choice for families and professionals alike. With its blend of traditional charm and modern convenience, this residence promises a lifestyle of ease and quality in one of the area's most sought after neighbourhoods.

Council Tax band: C

Tenure: Freehold







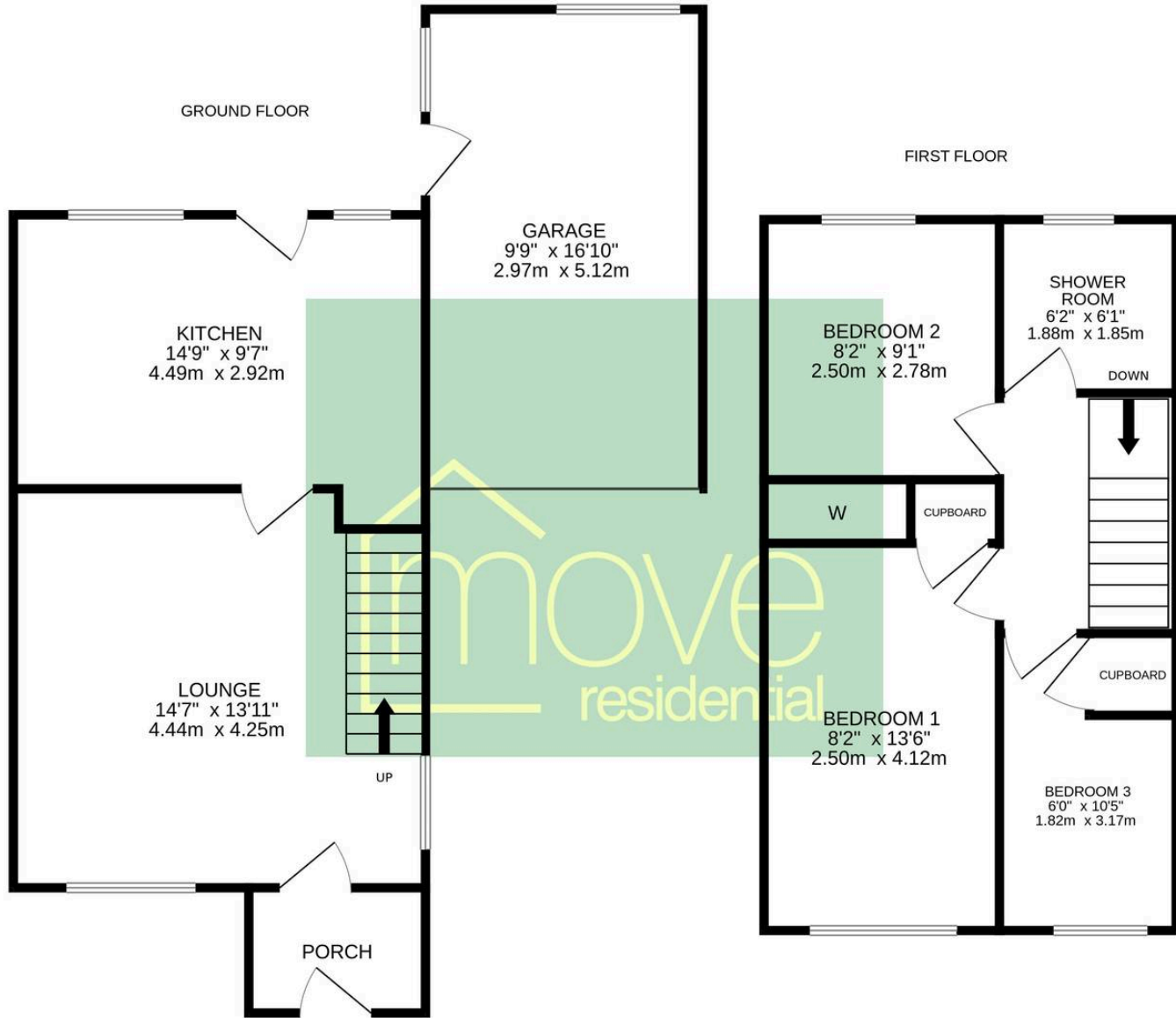

TOTAL FLOOR AREA : 887 sq.ft. (82.4 sq.m.) approx.

Whilst every attempt has been made to ensure the accuracy of the floorplan contained here, measurements of doors, windows, rooms and any other items are approximate and no responsibility is taken for any error, omission or mis-statement. This plan is for illustrative purposes only and should be used as such by any prospective purchaser. The services, systems and appliances shown have not been tested and no guarantee as to their operability or efficiency can be given.

Made with Metropix ©2026

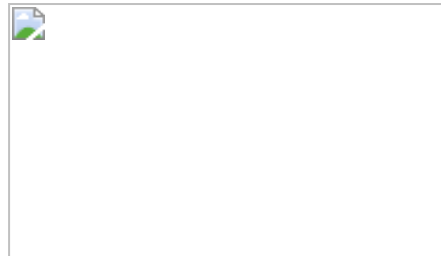

You can include any text here. The text can be modified upon generating your brochure.

Additional Information:

These particulars are thought to be materially correct though their accuracy is not guaranteed and they do not form part of any contract. All measurements are approximate and we have not tested any fitted appliances, electrical or plumbing installation or central heating systems. Floor plans are for illustration purposes only and their accuracy is not guaranteed.