



Flat 2, Greystone Lodge Sussex Gardens, Hucclecote
£124,950



Flat 2

Greystone Lodge Sussex Gardens,
Gloucester

IMMACULATELY PRESENTED, GROUND FLOOR, 1
BEDROOMED APARTMENT FOR OVER 55's WITH NO
ONWARD CHAIN.

Benefits include a fitted kitchen, spacious
loung/diner and fitted shower room, along with
underfloor heating and direct access onto patio and
communal gardens.

Greystone Lodge is situated in a very desirable
location close to a wide variety of local amenities,
including shops, dentist, doctors, community centre
and library. Several large supermarkets are within
easy reach and bus routes to both Cheltenham and
Gloucester run frequently with the bus stop situated
very close to the property.

Within the communal grounds are beautifully
tended gardens, a secluded washing and drying
area.

Council Tax band: TBD

Tenure: Leasehold





Entrance

Door to communal stairwell. Wooden glazed door to:-

Living Room

Dimensions: 27' 9" x 10' 1" (8.45m x 3.08m). Carpet flooring. Double glazed window to front. Coal effect electric fireplace with wooden surround. TV point. Sliding double glazed doors onto small patio area and beautifully maintained communal gardens.

Kitchen

Dimensions: 6' 9" x 7' 10" (2.05m x 2.39m). Vinyl flooring. Space for washing machine. Range of wall and base units with laminate worktop over and matching splashback. Stainless steel sink with drainer and mixer tap. Double glazed window to front. Space for fridge freezer. Electric Neff hob and extractor hood. Larder cupboard housing electric water heater.

Bedroom

Dimensions: 10' 0" x 9' 11" (3.04m x 3.01m). Carpet flooring. Cupboard. Double glazed window with views to communal garden.

Shower Room

Vinyl flooring. Low level WC. Wash hand basin. Mirror cabinet. Shower cubicle with Mira shower. Handrails.

Communal Gardens

Communal garden both front and rear. Very well maintained and private. To the rear is an enclosed drying area for washing. Bin store.

More Information

EPC: C Council Tax: A Management Fee: £1020 per year, payable to CMG. As part of the application process for purchasing a flat in this retirement community, prospective buyers are required to attend a meeting with the property management team. This meeting is designed to ensure that the buyer is suitable for the property and to provide an opportunity for any questions regarding the community's rules, services, and living arrangements.





Entrance

Door to communal stairwell. Wooden glazed door to:-

Living Room

Dimensions: 27' 9" x 10' 1" (8.45m x 3.08m). Carpet flooring. Double glazed window to front. Coal effect electric fireplace with wooden surround. TV point. Sliding double glazed doors onto small patio area and beautifully maintained communal gardens.

Kitchen

Dimensions: 6' 9" x 7' 10" (2.05m x 2.39m). Vinyl flooring. Space for washing machine. Range of wall and base units with laminate worktop over and matching splashback. Stainless steel sink with drainer and mixer tap. Double glazed window to front. Space for fridge freezer. Electric Neff hob and extractor hood. Larder cupboard housing electric water heater.

Bedroom

Dimensions: 10' 0" x 9' 11" (3.04m x 3.01m). Carpet flooring. Cupboard. Double glazed window with views to communal garden.

Shower Room

Vinyl flooring. Low level WC. Wash hand basin. Mirror cabinet. Shower cubicle with Mira shower. Handrails.

Communal Gardens

Communal garden both front and rear. Very well maintained and private. To the rear is an enclosed drying area for washing. Bin store.

More Information

EPC: C Council Tax: A Management Fee: £1020 per year, payable to CMG. As part of the application process for purchasing a flat in this retirement community, prospective buyers are required to attend a meeting with the property management team. This meeting is designed to ensure that the buyer is suitable for the property and to provide an opportunity for any questions regarding the community's rules, services, and living arrangements.



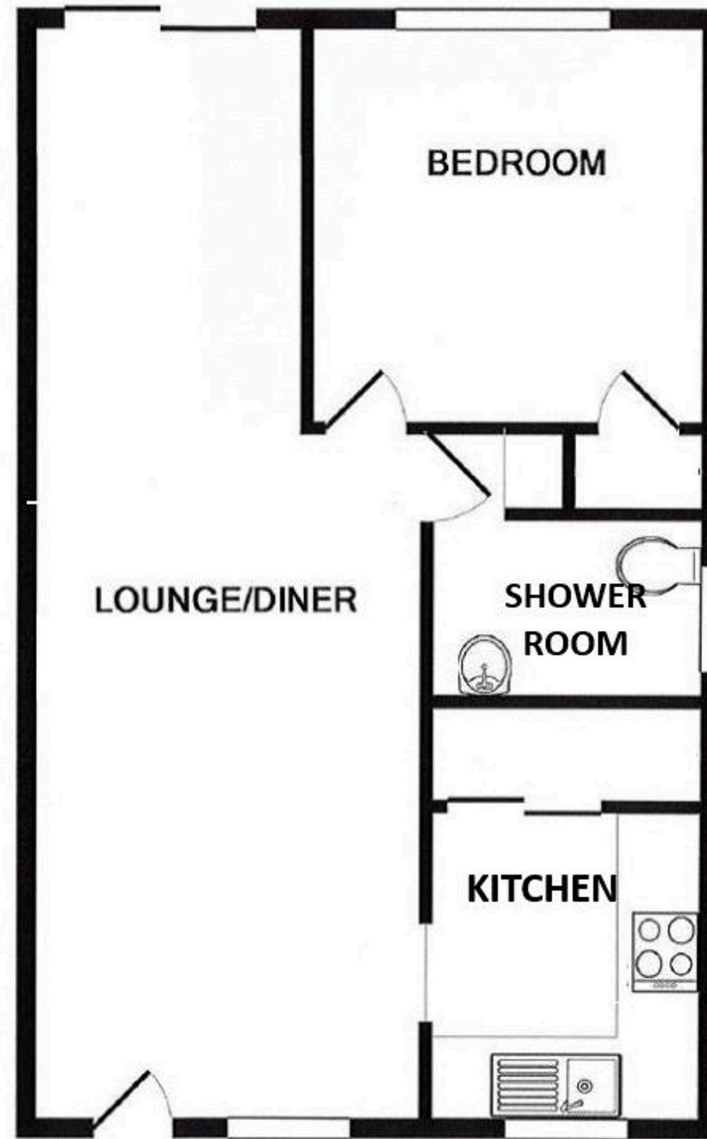

Farr and Farr Hucclecote

Farr & Farr, 50 Hucclecote Road - GL3 3RT

01452613355 • hucclecote@farrandfarr.co.uk •

