



  
**Holdens**  
ESTATE AGENTS

**Windmill Farmhouse, Windmill Lane, PRESTON**

**£1,295 pcm**

  
**Holdens**  
ESTATE AGENTS



## Windmill Farmhouse, Windmill Lane

PRESTON

Recently refurbished detached house with 2 double bedrooms (en-suite to master), modern kitchen, wrap-around gardens, countryside views, and great transport links near Hoghton and Brindle.

Council Tax band: TBD

EPC Energy Efficiency Rating: E

EPC Environmental Impact Rating:

- Charming detached property, in a serene semi-rural location with stunning views
- Recently Refurbished Throughout Providing a Modern Aesthetic
- Two Spacious Double Bedrooms - One of Which Boasts En-Suite Facilities
- Large Main Reception Room with Dual Aspect Windows
- Modern Fitted Kitchen with Ample Dining Space
- Wrap Around Gardens Offering Sensational Countryside Views
- Viewings Essential to Fully Appreciate This Incredible Home
- EPC Rating - Pending



**Holdens**  
ESTATE AGENTS

**Holdens**  
ESTATE AGENTS

**Holdens**  
ESTATE AGENTS





GROUND FLOOR  
43.6 sq.m. (469 sq.ft.) approx.

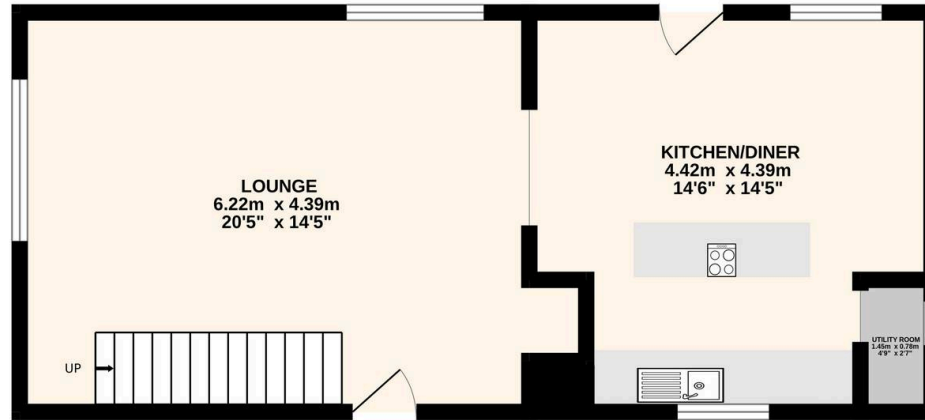

1ST FLOOR  
43.9 sq.m. (473 sq.ft.) approx.

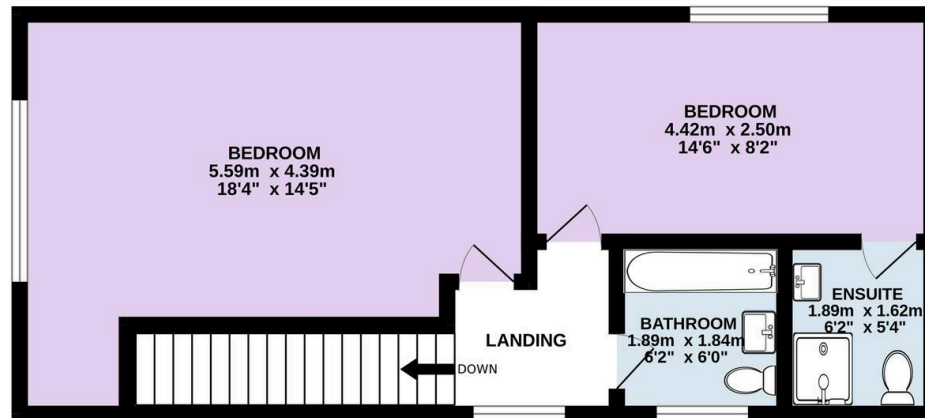



## Holdens Lostock Hall

Holdens Estate Agents, 6 Watkin Lane - PR5 5RD

01772 698888

lostockhall@holdens.co.uk

[www.holdens.co.uk/](http://www.holdens.co.uk/)

Disclaimer: All information such as plans, dimensions, and details about the property's condition or suitability is provided in good faith and believed to be accurate, but should not be relied upon without independent verification. Buyers or tenants must carry out their own checks. Appliances and systems haven't been tested. It's strongly advised to get professional inspections before making any commitments. No employee or agent of Holdens Estate Agents is authorised to make promises or guarantees about the property. These details are for general guidance only and do not form part of any contract. All discussions with Holdens Estate Agents are subject to contract.