

128 Robert Street, Milford Haven

£415 pcm

Centrally located retail unit on Robert Street with modern open plan space, prominent frontage, long lease. Available July 2026. Ideal for various businesses. Early viewing advised.



Council Tax band: TBD

- Long lease available
- Good window frontage
- Central Milford Haven location
- Open plan retail area

Accommodation

The unit provides approximately 41.72 sq. m. (450 sq.ft.) of internal space, comprising: - Open plan sales area - WC

Tenure

The property is available to let by way of a new Internal Repairing and Insuring (IRI) lease, on terms to be agreed.

Service Charge

A service charge will be payable to cover the cost of building insurance together with the maintenance and repair of the external and common parts of the property, apportioned to 2/28ths of the maintenance costs.

Business Rates

Rateable Value (from 1 April 2026) £2,650

Commercial EPC

Rating: B - 43 Certificate available on request.

Use

The premises are suitable for a range of commercial uses, subject to planning consent where required. Interested parties should rely on their own enquiries with the local planning authority.

Legal Costs

Tenant is responsible for their own legal costs incurred in the transaction and half the cost of lease cost.

Available

This retail unit is available from end of June 2026

Ground Floor

Approx. 53.5 sq. metres (575.8 sq. feet)

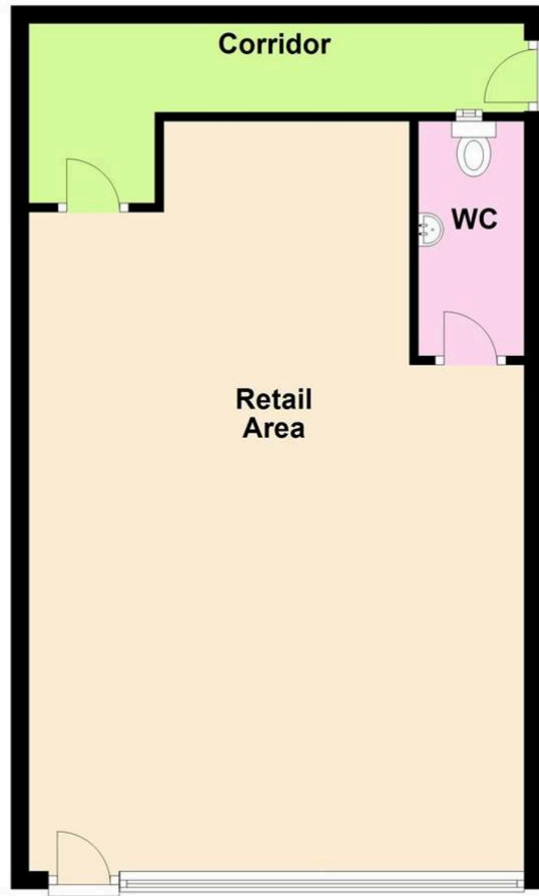

Total area: approx. 53.5 sq. metres (575.8 sq. feet)

128 Robert Street

