



Bishopgate Street, Wavertree
Liverpool

£125,000

Bishopgate Street

Wavertree, Liverpool

- Brilliant Two Bedroom Mid Terrace Home
- Located In The Popular Area Of Wavertree
- Available For Sale With No Onward Chain
- Finished To A High Standard Throughout
- Entrance Hall & Spacious Family Lounge
- Recently Installed Modern Fitted Kitchen
- Two Bright & Generously Sized Bedrooms
- New Contemporary Style Bathroom Suite

Located on Bishopgate Street in the popular residential area of Wavertree, L15, is this brilliant two bedroom mid terrace property, welcomed to the sales market courtesy of appointed agents Move Residential. Available with no onward chain, this property has been finished to an excellent standard throughout, presenting an opportunity not to be missed for both investors and first-time buyers.

An entrance hall greets you into the property, leading through to a bright and spacious family lounge, which boasts an eye-catching marble fireplace, followed by a new modern kitchen complete with a range of fitted units which feature soft close doors and drawers.

Continuing up to the first floor you will find two generously sized bedrooms, each finished in a fresh neutral décor featuring plush carpeting, accompanied by a recently installed contemporary style family bathroom suite.

Council Tax band: A

Tenure: Freehold









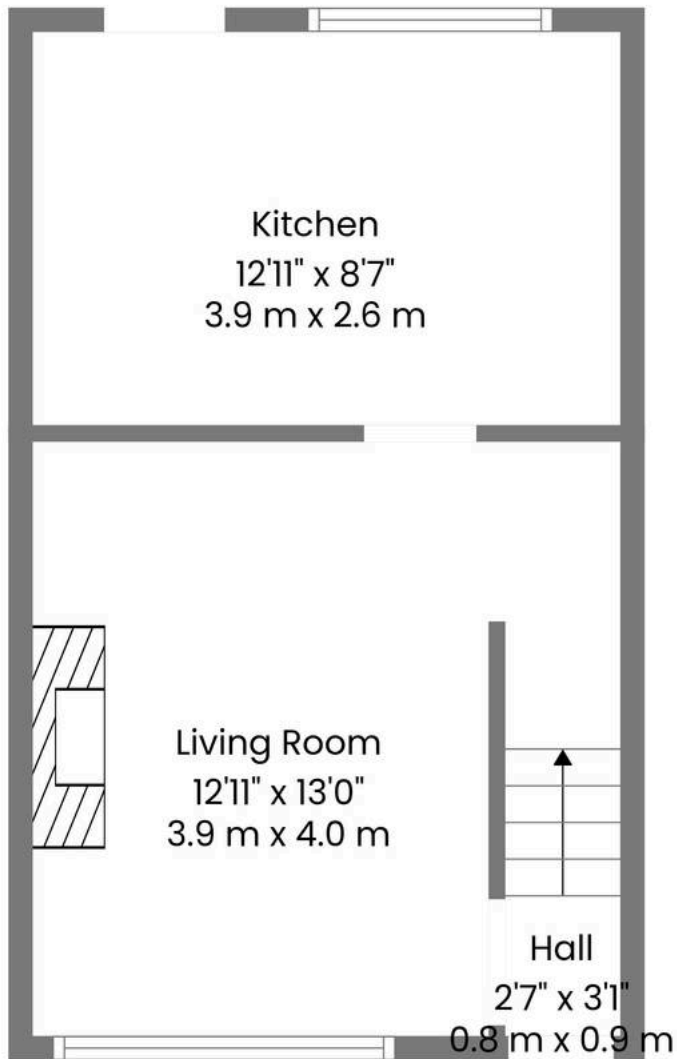

1st Floor

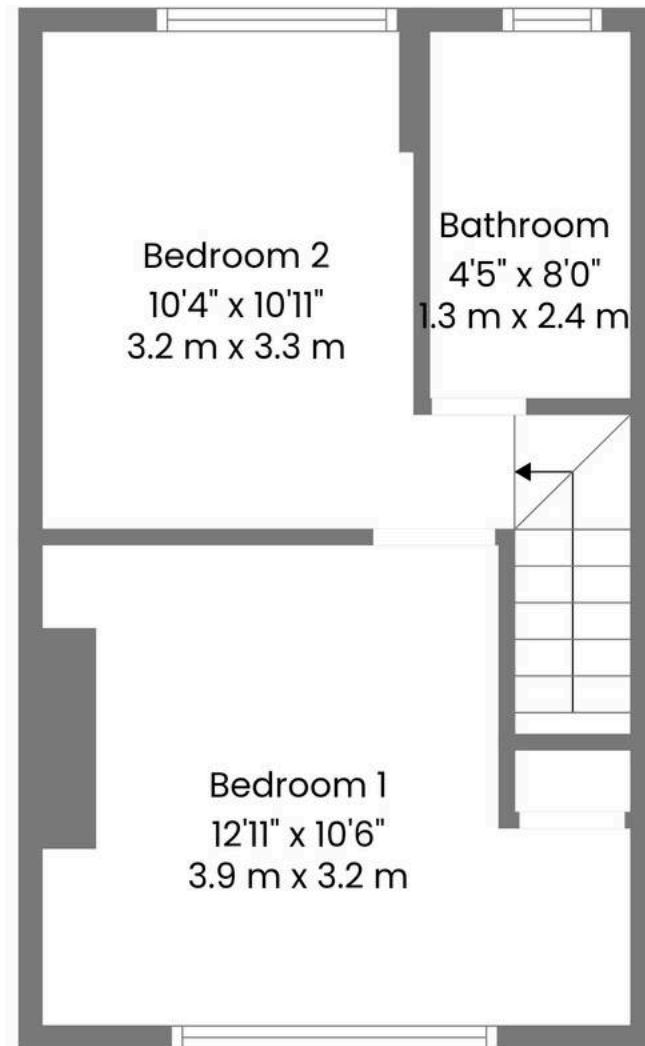

2nd Floor

TOTAL: 563 sq. ft, 52 m2

1st floor: 283 sq. ft, 26 m2, 2nd floor: 280 sq. ft, 26 m2

EXCLUDED AREAS: WALLS: 72 sq. ft, 7 m2