

PS

3b Glengariff Road, Lower Parkstone, Poole, BH14 9LQ

£649,950



3b Glengariff Road

Lower Parkstone, Poole

Nestled in a serene, leafy neighbourhood, this charming red-brick property beautifully merges traditional architectural elegance with modern comforts. Its timeless façade, enhanced by mature trees and lush hedges, creates a sense of privacy and tranquillity, offering a peaceful retreat from the hustle and bustle. The classic red-brick exterior is complemented by a distinctive curved bay window, which adds character to the structure while flooding the living spaces with natural light. A paved driveway offers convenient off-street parking, leading up to the main entrance for a welcoming first impression.

- Spacious living room with high ceilings
- Stylish bathrooms with contemporary finishes
- Close to Sandbanks Beach, shops and cafes
- 4 bedrooms, 3 bedrooms
- Private garden
- Front garden and off road parking
- Bright bedrooms
- Modern Kitchen breakfast room
- Freehold
- Over 1500 sq ft
- Council Tax Band E: £2,933.31
- EPC Rating: C



Inside, this home reveals a spacious, light-filled interior that combines the charm of traditional design with thoughtful modern updates. The entrance hall is tastefully finished with neutral décor and soft carpeting, setting the tone for the rest of the home. The main living room is a highlight, featuring large windows that frame the surrounding greenery, allowing sunlight to pour in. High ceilings, plush carpeting, and a stylish chandelier enhance the sense of space and comfort, making this room ideal for both relaxation and hosting gatherings. The open-plan kitchen and dining area is designed for contemporary living, featuring sleek white cabinetry, integrated appliances, and polished granite countertops that blend style and functionality. A central island serves as a social hub and extra workspace, perfect for casual dining or meal preparation. Large bi-folding doors open out onto a private deck, seamlessly connecting indoor and outdoor spaces. This transition makes it ideal for al fresco dining, weekend barbecues, or simply enjoying garden views, creating an inviting space for entertaining. The property offers several generously sized bedrooms, each designed as a peaceful retreat. Large windows and neutral tones create a calming atmosphere, while the main bedroom stands out with ample space for a king-sized bed and additional furnishings. An attic bedroom on the top floor, with its charming sloped ceiling and skylight, provides a cosy hideaway, making it perfect for guests or as a secluded space for work or hobbies. The bathrooms are modern and finished to a high standard, featuring neutral tiling, contemporary fittings, and a skylight in the upstairs bathroom, which ensures a bright, refreshing space.

Outside, the rear garden offers a tranquil escape with a mix of well-maintained greenery and a decked area for outdoor relaxation. Mature trees and shrubs frame the garden, providing a natural backdrop and a sense of seclusion. A paved pathway and raised brick borders add structure and charm to the space, making it suitable for both leisure and low-maintenance gardening, ensuring year-round enjoyment.



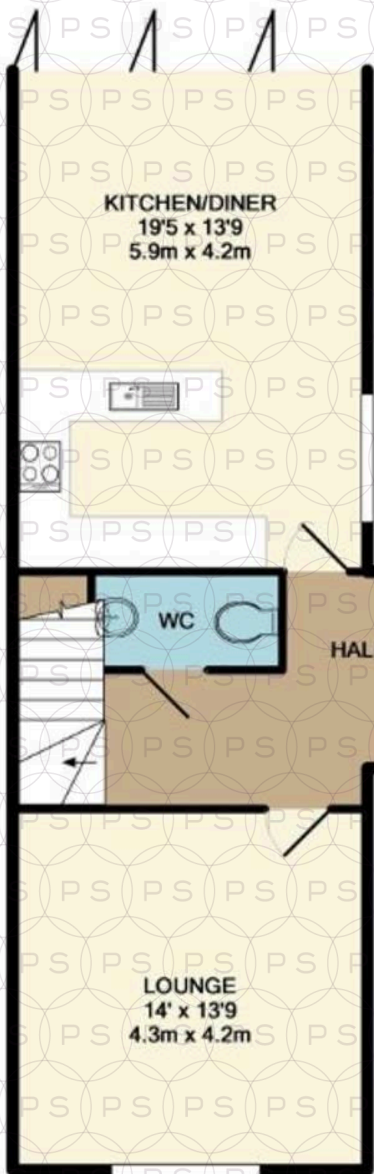

KITCHEN/DINER
19'5" x 13'9"
5.9m x 4.2m

LOUNGE
14' x 13'9"
4.3m x 4.2m

GROUND FLOOR
APPROX. FLOOR
AREA 621 SQ.FT.
(57.7 SQ.M.)

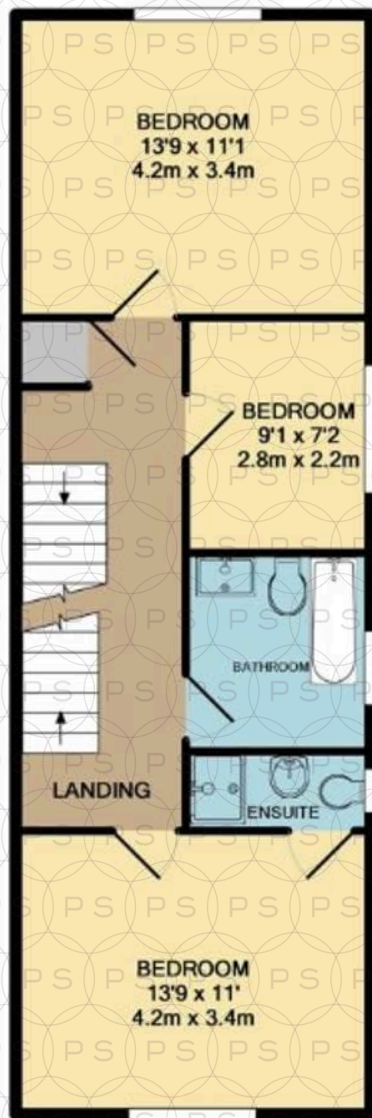

BEDROOM
13'9" x 11'1"
4.2m x 3.4m

BEDROOM
9'1" x 7'2"
2.8m x 2.2m

BEDROOM
13'9" x 11'1"
4.2m x 3.4m

1ST FLOOR
APPROX. FLOOR
AREA 586 SQ.FT.
(54.4 SQ.M.)

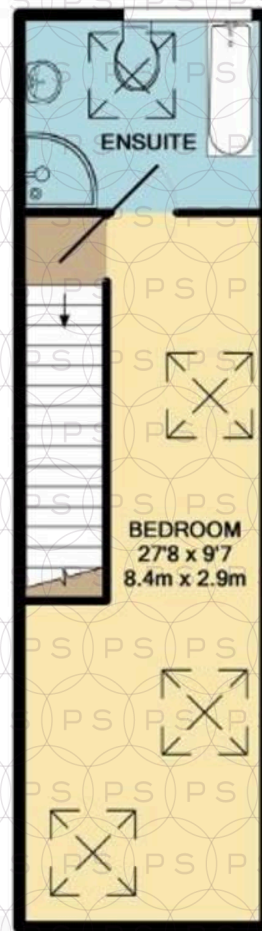

ENSUITE

BEDROOM
27'8" x 9'7"
8.4m x 2.9m

2ND FLOOR
APPROX. FLOOR
AREA 338 SQ.FT.
(31.4 SQ.M.)

TOTAL APPROX. FLOOR AREA 1544 SQ.FT. (143.5 SQ.M.)

Whilst every attempt has been made to ensure the accuracy of the floor plan contained here, measurements of doors, windows, rooms and any other items are approximate and no responsibility is taken for any error, omission, or mis-statement. This plan is for illustrative purposes only and should be used as such by any prospective purchaser. The services, systems and appliances shown have not been tested and no guarantee as to their operability or efficiency can be given.
Made with Metropix ©2017



Philippa Sole Ltd

Philippa Sole 3A Springfield Road, Ashley Cross - BH14 0LG

01202 747999 • enquiries@philippasole.co.uk • www.philippasole.co.uk

All statements in these particulars are made without responsibility on the part of Philippa Sole Ltd or the vendor. Neither Philippa Sole Ltd nor anyone in its employment or acting on its behalf has the authority to make any representation or warranty in relation to this property, detailed survey or tested services and fittings. Room sizes are approximate.