



19 Ferndale Close, Burntwood - WS7 4US

Offers in Region of **£240,000**





19 Ferndale Close

Burntwood, Burntwood

This well presented semi detached dormer bungalow offers an excellent opportunity for buyers seeking a spacious and versatile home, available with no upward chain. Located in a popular residential area, this bungalow is well placed for access to local amenities, schools, and transport links, making it an attractive choice for a variety of purchasers. With its combination of generous living space, practical features, and the added advantage of being offered with no upward chain, this property represents a fantastic opportunity for those looking to secure a comfortable and well maintained home. Early viewing is highly recommended to fully appreciate all that this impressive bungalow has to offer.

THE PROPERTY....

Upon entering, the inviting hallway leads to a good sized lounge with patio doors to the rear garden that fills the room with natural light, complemented by a feature fireplace, creating a warm and welcoming ambience. The heart of the home is the stunning refitted extended kitchen/breakfast room which has been thoughtfully designed, with an array of natural light and offering plenty of workspace and storage, as well as a dedicated area for informal dining.

The inner hallway leads to two generously proportioned bedrooms, each offering a peaceful retreat for rest and relaxation. The shower room is appointed with contemporary fixtures and fittings, epitomising style and comfort.

On the first floor is a good sized room that can be used as a bedroom or games room or anything you'd desire.





19 Ferndale Close

Burntwood, Burntwood

This well presented semi detached dormer bungalow offers an excellent opportunity for buyers seeking a spacious and versatile home, available with no upward chain. Located in a popular residential area, this bungalow is well placed for access to local amenities, schools, and transport links, making it an attractive choice for a variety of purchasers. With its combination of generous living space, practical features, and the added advantage of being offered with no upward chain, this property represents a fantastic opportunity for those looking to secure a comfortable and well maintained home. Early viewing is highly recommended to fully appreciate all that this impressive bungalow has to offer.

THE PROPERTY....

Upon entering, the inviting hallway leads to a good sized lounge with patio doors to the rear garden that fills the room with natural light, complemented by a feature fireplace, creating a warm and welcoming ambience. The heart of the home is the stunning refitted extended kitchen/breakfast room which has been thoughtfully designed, with an array of natural light and offering plenty of workspace and storage, as well as a dedicated area for informal dining.

The inner hallway leads to two generously proportioned bedrooms, each offering a peaceful retreat for rest and relaxation. The shower room is appointed with contemporary fixtures and fittings, epitomising style and comfort.

On the first floor is a good sized room that can be used as a bedroom or games room or anything you'd desire.





You can include any text here. The text can be modified upon generating your brochure.



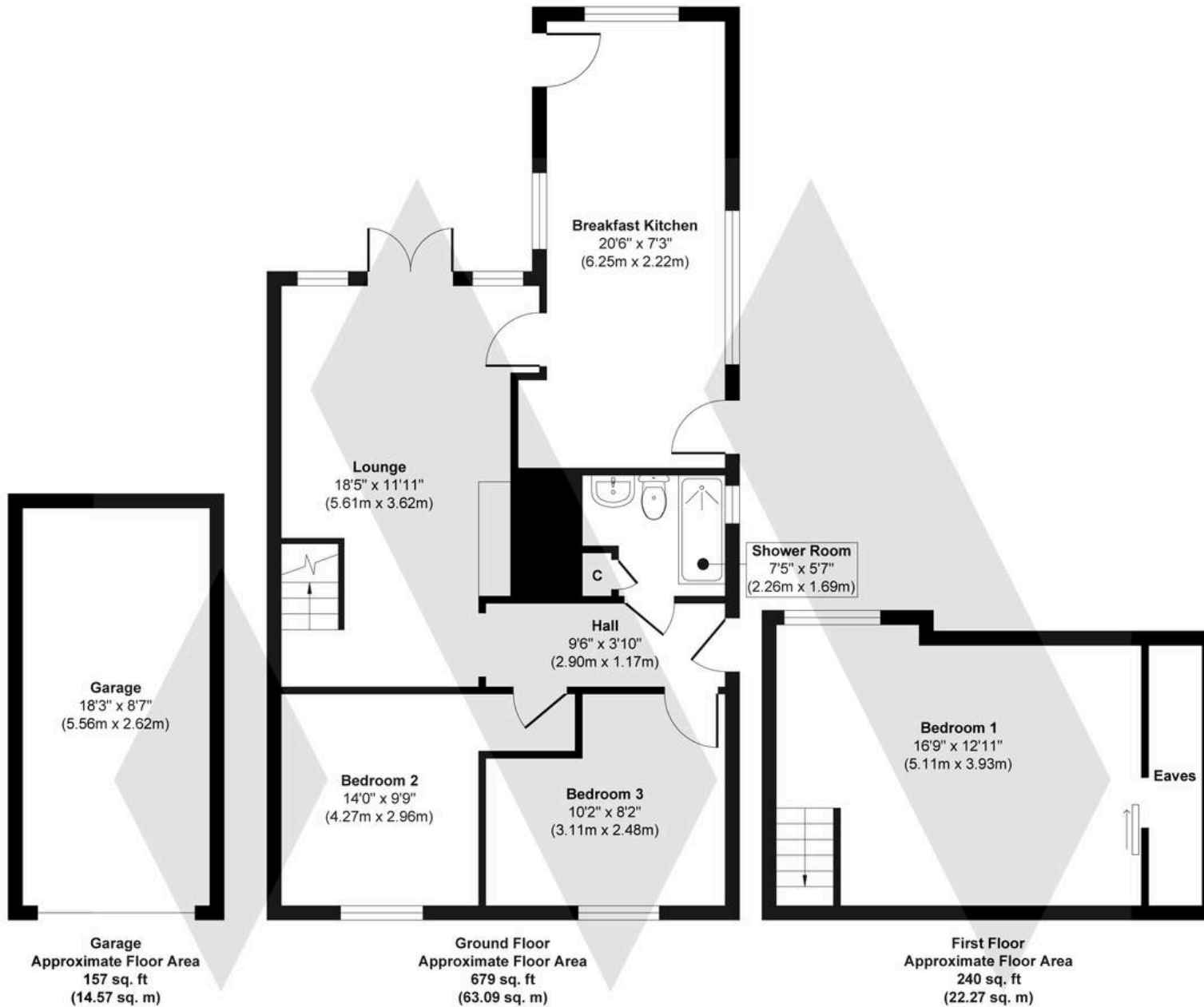

Approx. Gross Internal Floor Area 1076 sq. ft / 99.93 sq. m (Including Garage)

Illustration for identification purposes only, measurements are approximate, not to scale.

Produced by Elements Property

MOORHOUSE

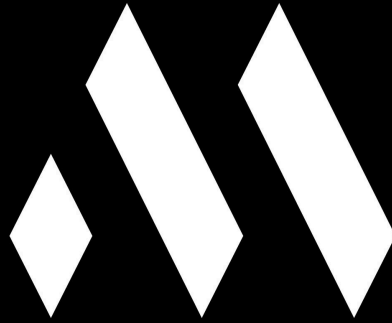

You can include any text here. The text can be modified upon generating your brochure.