



## North Road, Torworth, Retford, DN22 8NP

£120,000 Freehold

- Modern Commercial Premises Ideal for a Retail Outlet or Boutique • Ample Parking to the Frontage • Versatile, Fully Enclosed Outdoor Space to the Rear • Scenically Situated in Torworth with a Great Prominence for Passing Trade between Bawtry & Retford • Business Rates: We have been advised that this commercial space falls under the threshold for business rates relief



A great opportunity to acquire a modern commercial premises with A1 status measuring 39 sq m., ideal for a retail outlet or boutique. A private driveway caters for multiple customers, whilst a versatile outdoor space resides to the rear. Scenically situated in the village of Torworth, the premises has a great prominence for potential passing trade between the local market towns of Bawtry and Retford via the A638.

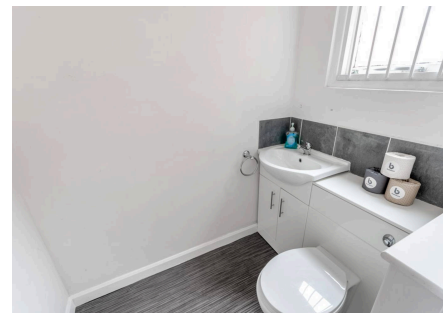

Council Tax band: TBD

Tenure: Freehold

EPC Energy Efficiency Rating: C

EPC Environmental Impact Rating:



Ground Floor  
39 sq m/419.79 sq ft  
Approx.

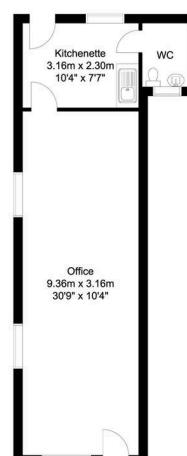

Whilst every attempt has been made to ensure the accuracy of the floor plan contained herein, no responsibility is taken for incorrect measurements of doors, windows, appliances and rooms or any error, omission or misstatement. Exterior and interior walls are drawn to scale based on interior measurements. Any figure given is for initial guidance only and should not be relied on as a basis of valuation. The plans are for marketing purposes only and should only be used as such. No guarantee is given on the accuracy of the total square footage/metreage if quoted on this plan. © Property Services ©2024