



## Whitehall Court, Retford, DN22 6JQ

£140,000 Freehold

• **\*\*NO UPWARD CHAIN\*\*** • **\*\*The Title for 17A, B & C Whitehall Court is Currently Being Divided Between the Three Properties, & the Official Boundaries for Each Property Will Follow\*\*** • Modern TWO BEDROOM End Terrace • Ideal for First-Time Buyers & Investors • Single Allocated Parking Space • Laid to Lawn Front & Rear Gardens • Enjoying a Quiet Cul De Sac Location in the Georgian Market Town of Retford



We are pleased to welcome this modern TWO BEDROOM end terrace to the market. Set over two storeys, the well-balanced living accommodation briefly comprises an entrance hall, spacious lounge, sunny, southerly aspect kitchen diner, handy ground floor WC, two bedrooms, and a well-appointed bathroom. The Title for 17A, B & C Whitehall Court is currently being divided between the three properties. Once finalised, each property will enjoy a single allocated parking space, and laid to lawn front and rear gardens. Enjoying a quiet cul de sac location, 17C Whitehall Court is just a brief walk from Retford's town centre, and enjoys a wealth of everyday conveniences, recreational facilities, boutiques, bars, restaurants, and excellent road and rail links in its locality. Thrumpton Lane Academy, having most recently received a good Ofsted rating, is also within easy reach on foot. Early viewing is considered essential to fully appreciate the ideal first home/ investment opportunity, and prime town setting being offered for sale.



Council Tax band: A

Tenure: Freehold

EPC Energy Efficiency Rating: C

EPC Environmental Impact Rating: C



Ground Floor  
33 sq m/355.20 sq ft  
Approx.

First Floor  
29 sq m/312.15 sq ft  
Approx.

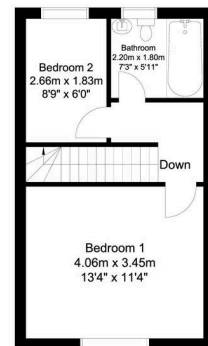
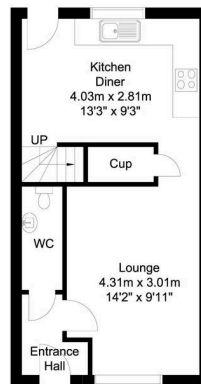

Whilst every attempt has been made to ensure the accuracy of the floor plan contained here, no responsibility is taken for incorrect measurements of doors, windows, appliances and rooms or any error, omission or misstatement. Exterior and interior walls are drawn to scale based on interior measurements. Any figure given is for initial guidance only and should not be relied on as a basis of valuation. The plans are for marketing purposes only and should only be used as such. No guarantee is given on the accuracy of the total square footage/ metrage if quoted on this plan. CP Property Services @2020