



12 Walkers Road, Longwick - HP27 9SS
£575,000





- Quiet cul-de-sac village setting
- Flexible three/four-bedroom layout
- Spacious dual-aspect principal bedroom
- West-facing rear garden with awning
- Views across neighbouring paddock
- Large garage and driveway
- Potential to modernise and extend
- No onward chain offered

Longwick is a well-regarded Buckinghamshire village, located a short distance from Princes Risborough. It offers a strong community atmosphere with a village pub, local store with post office, and a well-used playing field, alongside access to scenic rural footpaths and bridleways through the surrounding farmland and Chiltern landscape. More comprehensive shopping and rail services are available in nearby Princes Risborough and Thame. The property is within walking distance of Longwick Primary School, making it an appealing choice for families seeking village life with everyday conveniences close by.



A three/four-bedroom detached family home, quietly positioned within a cul-de-sac in the sought-after village of Longwick.

Originally constructed as a four-bedroom property, the home has been thoughtfully reconfigured to provide an impressive dual-aspect principal bedroom, with the flexibility to reinstate a fourth bedroom if desired.

The accommodation comprises an entrance hall, cloakroom, dual-aspect sitting room with French doors opening onto the garden, dining room, and a kitchen/breakfast room. To the first floor are three bedrooms and a family bathroom.

The property has been maintained over the years and offers excellent potential for modernisation and extension, subject to the necessary planning consents. Additional benefits include a large garage, driveway parking, and a private west-facing rear garden overlooking a neighbouring paddock. A remote-controlled awning provides sheltered outdoor seating over the patio area and there is an area of lawn and gated side access.

Offered to the market with no onward chain.

Council Tax band: F

Tenure: Freehold

EPC Energy Efficiency Rating: D



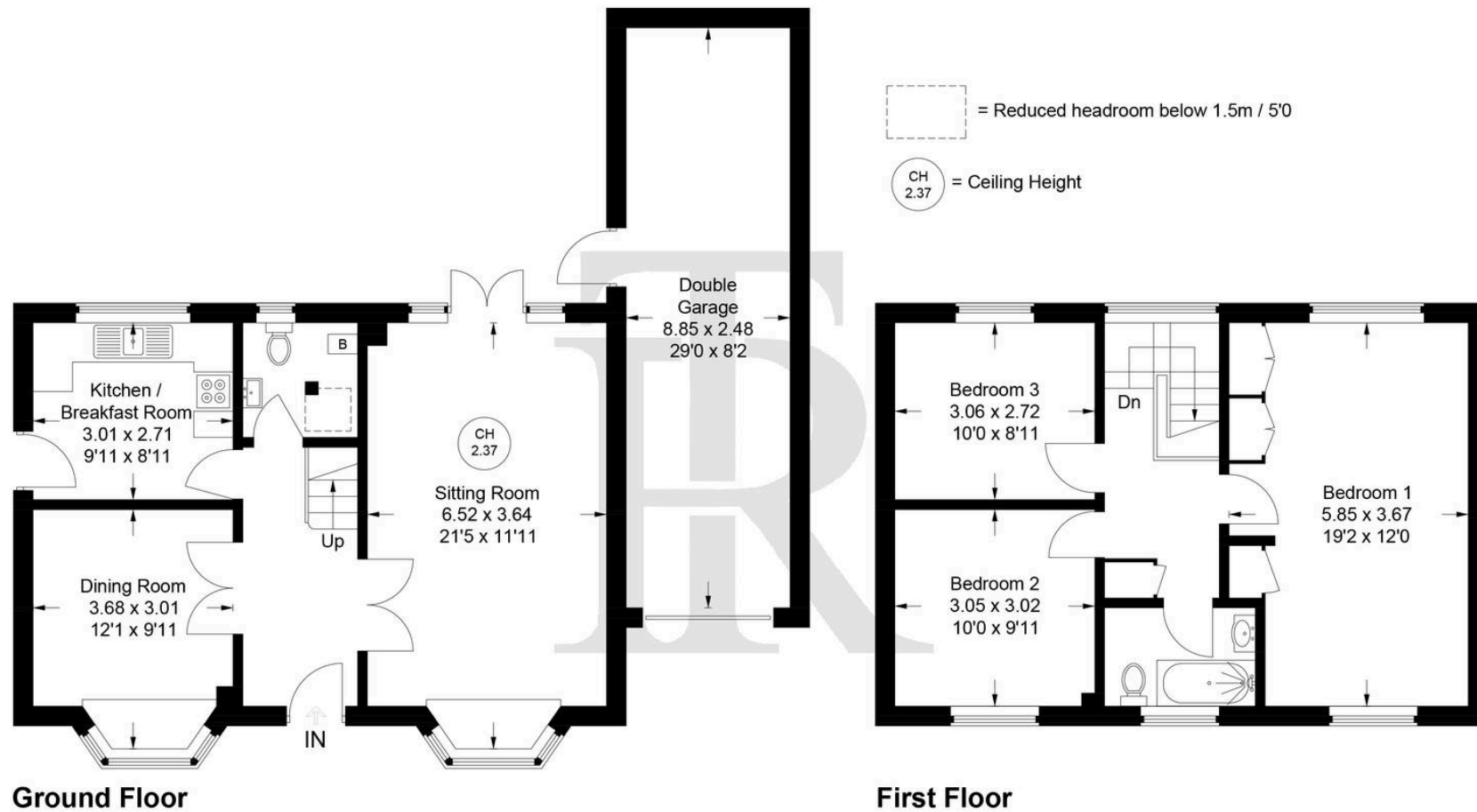

12 Walkers Road, HP27 9SS

Approximate Gross Internal Area

Ground Floor = 53.7 sq m / 578 sq ft

First Floor = 51.2 sq m / 551 sq ft

Double Garage = 22.3 sq m / 240 sq ft

Total = 127.2 sq m / 1369 sq ft

Floor Plan produced for Tim Russ & Company by Media Arcade Ltd ©.

Illustration for identification purposes only. Window and door openings are approximate. Whilst every attempt is made to assure accuracy in the preparation of this plan, please check all dimensions, shapes and compass bearings before making any decisions reliant upon them.



Tim Russ and Company

Tim Russ Ltd, 1 High Street - HP27 0AE

01844 275522 • p.risborough@timruss.co.uk • timruss.co.uk/

By law we must verify every seller and buyer for anti-money laundering purposes.

Checks are carried out by our partners at Lifetime Legal for a non-refundable £65 (incl. VAT) fee, paid directly to them.

For more information please visit our website.



Particulars described on our website and in marketing materials are for indicative purposes only; their complete accuracy cannot be guaranteed. Details such as boundary lines, rights of way, or property condition should not be treated as fact. Interested parties are advised to consult their own surveyor, solicitor, or other professional before committing to any expenditure or legal obligations.