



  
**Holdens**  
ESTATE AGENTS

**16 Inglewood, Whittingham**  
**£235,000**

  
**Holdens**  
ESTATE AGENTS



## 16 Inglewood

Whittingham, Preston

Charming two-bed semi-detached bungalow with open plan living, modern kitchen, utility, driveway, low-maintenance gardens, and great village location near shops and motorway links. Council Tax band: B

Tenure: Freehold

EPC Energy Efficiency Rating: B

EPC Environmental Impact Rating: B

- Semi detached true bungalow
- Open plan living/kitchen/dining room
- Patio doors to the rear garden
- Utility Room
- Two bedrooms & bathroom
- Low maintenance good size paved rear garden
- Driveway parking & gravelled area
- Pleasant residential location
- Handy for village facilities
- Excellent motorway connections







GROUND FLOOR  
54.7 sq.m. (589 sq.ft.) approx.

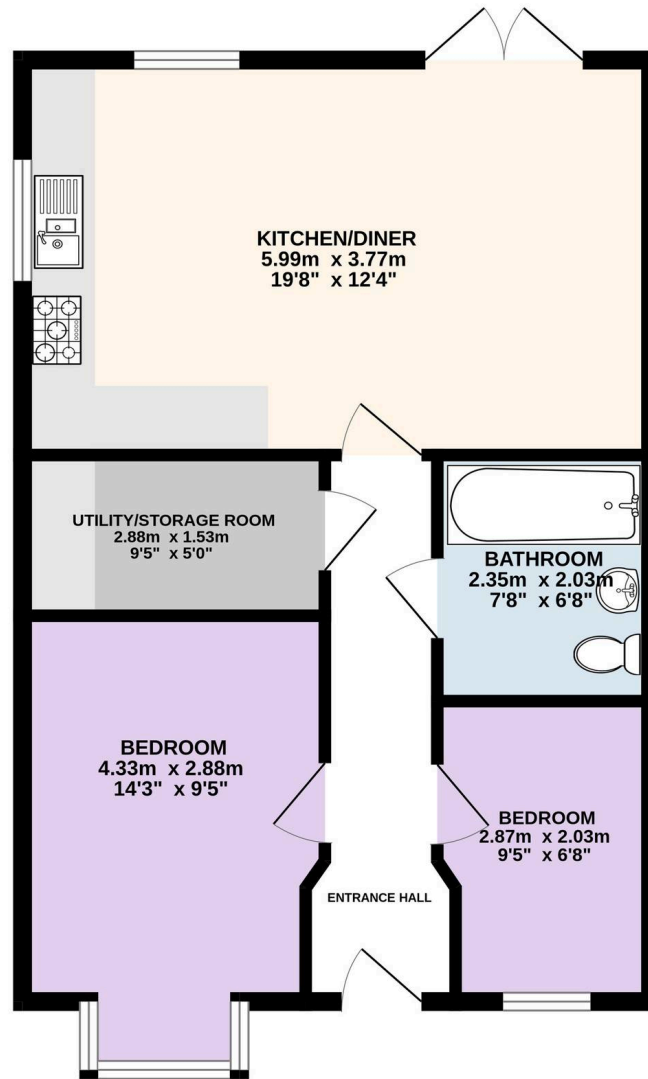

TOTAL FLOOR AREA : 54.7 sq.m. (589 sq.ft.) approx.

Every attempt is made to ensure accuracy, however all measurements are approximate. This plan is for illustrative purposes only and is not to scale.  
Made with Metropix ©2026



## Holdens Longridge

66 Derby Road, Longridge – PR3 3FE

01772 233380

[longridge@holdens.co.uk](mailto:longridge@holdens.co.uk)

[www.holdens.co.uk/](http://www.holdens.co.uk/)

Disclaimer: All information such as plans, dimensions, and details about the property's condition or suitability is provided in good faith and believed to be accurate, but should not be relied upon without independent verification. Buyers or tenants must carry out their own checks. Appliances and systems haven't been tested. It's strongly advised to get professional inspections before making any commitments. No employee or agent of Holdens Estate Agents is authorised to make promises or guarantees about the property. These details are for general guidance only and do not form part of any contract. All discussions with Holdens Estate Agents are subject to contract.