

21 Cei Tir Y Castell, Barry

£155,000 Leasehold

SECOND FLOOR APARTMENT • JULIET BALCONY WITH STUNNING VIEWS OF THE DOCK • OPEN PLAN KITCHEN/LOUNGE/DINER, PERFECT FOR ENTERTAINING • TWO DOUBLE BEDROOMS, EN-SUITE SHOWER ROOM TO THE MASTER BEDROOM PLUS A SEPARATE BATHROOM • ALLOCATED PARKING SPACE • CLOSE PROXIMITY (0.8 MILES) TO BARRY DOCKS TRAIN STATION AND THE NEW BARRY TRANSPORT INTERCHANGE • CLOSE TO BARRY ISLAND AND GOODSHEDS FOR DINING/ENTERTAINMENT • A SHORT WALK TO BARRY WATERFRONT RETAIL PARK • CATCHMENT FOR YSC SAINT BARUC (NEW WELSH MEDIUM PRIMARY SCHOOL ON THE WATERFRONT) • NO ONWARD CHAIN; EPC B84



blackbear



This fantastic two bedroom flat located in the heart of vibrant Barry Waterfront offers an excellent opportunity for those seeking modern living with convenience at its core.

Boasting a desirable 'no onward chain' status, this property presents two generously sized double bedrooms, ideal for a growing family or professionals alike. The master bedroom comes complete with an en-suite shower room, offering privacy and luxury, while a separate bathroom caters to the needs of residents and guests.

The highlight of this home is the open plan kitchen/lounge/diner layout, creating a sociable space perfect for entertaining friends and family. A Juliet balcony offers a stunning view of the dock, creating a tranquil atmosphere.

With an allocated parking space, accessibility is a breeze, making day-to-day life effortless.

Residents of this property can relish in the proximity to a range of amenities and attractions. Positioned just a short distance (0.8 miles) from Barry Docks Train Station and the new Barry Transport Interchange, commuting is convenient and stress-free. Additionally, the property is a stones throw away from Barry Waterfront Retail Park, ensuring that shopping trips and leisurely strolls are within easy reach.

Families will appreciate the catchment area for Ysgol Sant Baruc, a new Welsh medium primary school located on the waterfront, providing educational opportunities close to home.

For recreational activities and dining options, residents can explore Barry Island and Goodsheds, known for its diverse dining scene and entertainment offerings. Whether you seek a tranquil evening at home or an adventure out exploring local hotspots, this property offers the perfect blend of modern living and accessibility, making it an ideal choice for those looking to immerse themselves in the thriving community of Barry.

Council Tax band: B

Tenure: Leasehold



Hallway

Entrance via a fire door with a thumb twist lock, peep hole and chain lock for added security. Smooth walls, a smooth ceiling and vinyl wood effect flooring. A wall mounted intercom system and doors leading off to the bathroom, two bedrooms, the kitchen/lounge.

Hallway

Entrance via a fire door with a thumb twist lock, peep hole and chain lock for added security. Smooth walls, a smooth ceiling and vinyl wood effect flooring. A wall mounted intercom system and doors leading off to the bathroom, two bedrooms, the kitchen/lounge.

Hallway

Entrance via a fire door with a thumb twist lock, peep hole and chain lock for added security. Smooth walls, a smooth ceiling and vinyl wood effect flooring. A wall mounted intercom system and doors leading off to the bathroom, two bedrooms, the kitchen/lounge.

Kitchen/Diner/Lounge

20' 4" x 9' 8" (6.20m x 2.95m)

A continuation of the vinyl wood effect flooring from the hallway, smooth walls and a smooth ceiling. The kitchen has white gloss matching eye and base level units with a beautifully complementing grey worktop which has a stainless steel sink inset with a stainless steel mixer tap on a stainless steel grated appliances include a fridge/freezer, a stainless steel four ring gas hob, stainless steel hood and a washing machine. There is a stainless steel splashback behind the kitchen area and an aspect window above the kitchen sink. The worktop



blackbear

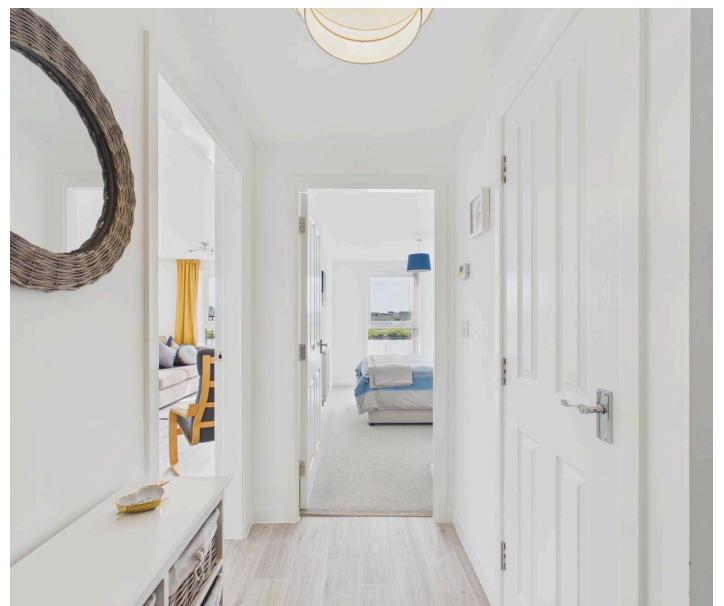



blackbear



21 Cei Tir Y Castell

Approximate Gross Internal Area
549 sq ft - 51 sq m

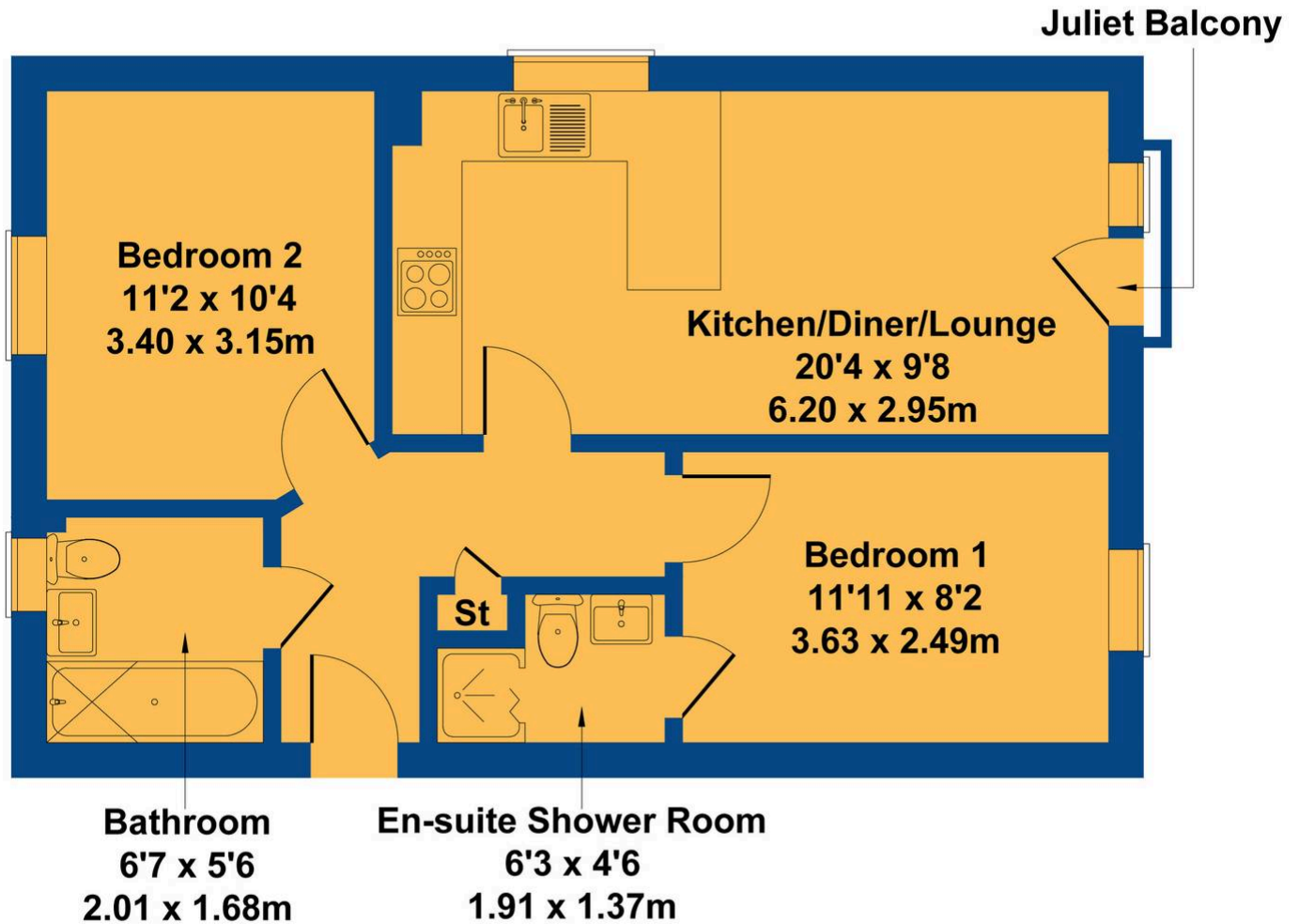

Not to Scale. Produced by The Plan Portal 2024
For Illustrative Purposes Only.



You can include any text here. The text can be modified upon generating your brochure.