



**10 Lindholme Way, Sutton-In-Ashfield - NG17 4DW**

Guide Price **£200,000**





## 10 Lindholme Way

Sutton-In-Ashfield

NO CHAIN! 2 bed detached bungalow ideal for those seeking the benefits of single-storey living! Good-sized lounge, fitted kitchen, bathroom and a southerly-facing low-maintenance garden plus driveway!

Council Tax band: B

Tenure: Freehold

- Detached bungalow
- Offered to the market with no upward chain
- Ideal for those seeking the benefits of single-storey living
- Within easy reach of Sutton-in-Ashfield's amenities and buses
- Bright and spacious lounge
- Fitted kitchen with integrated cooking appliances
- Two well-proportioned bedrooms (main bedroom with fitted wardrobes)
- Three-piece bathroom with potential to modernise
- South-facing low-maintenance rear garden
- Driveway providing convenient off-street parking





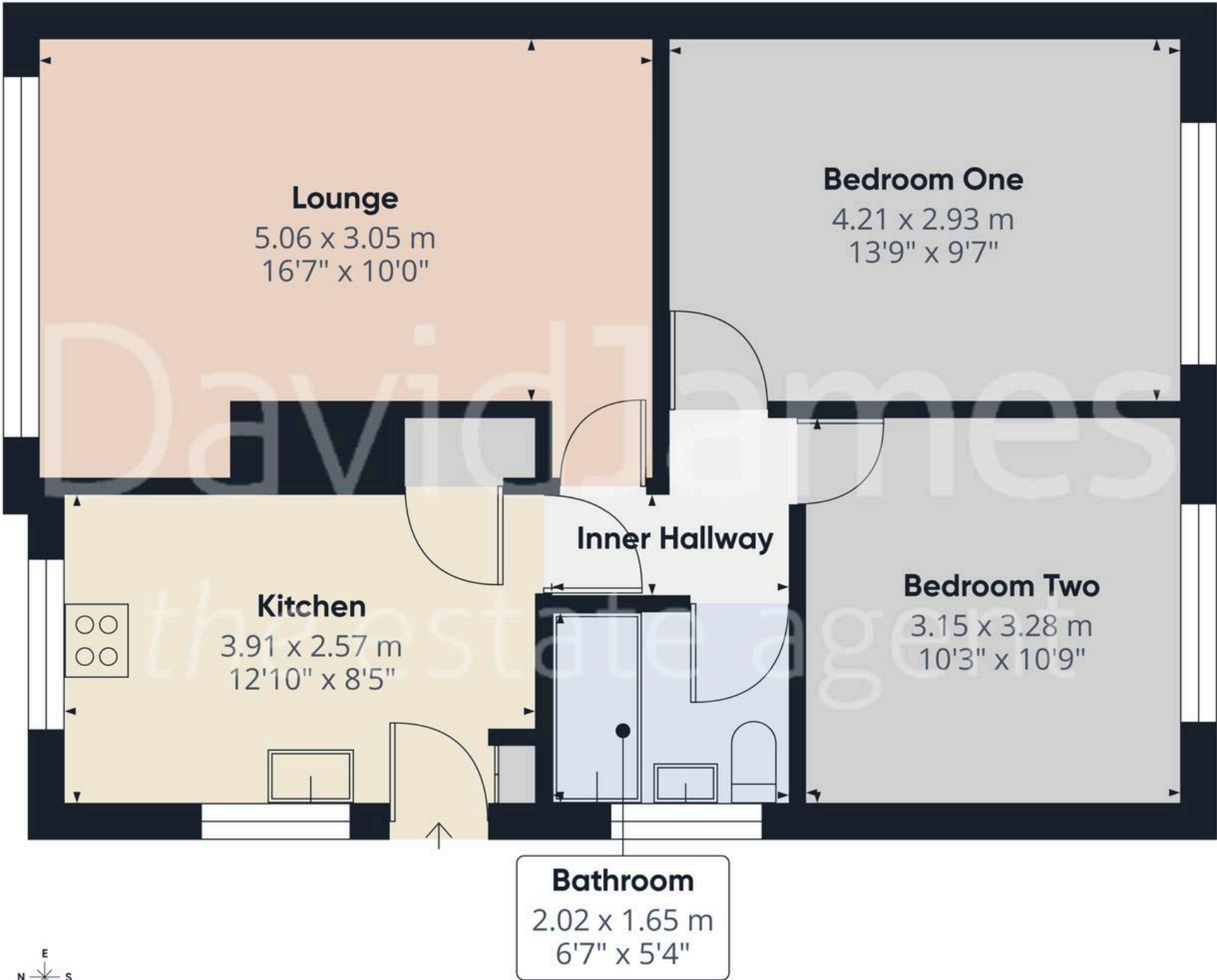

Approximate total area<sup>(1)</sup>

56.6 m<sup>2</sup>  
610 ft<sup>2</sup>

(1) Excluding balconies and terraces

Calculations reference the RICS IPMS 3C standard. Measurements are approximate and not to scale. This floor plan is intended for illustration only.

GIRAFFE360





## David James Estate Agents

43 Forest Street, Sutton-in-Ashfield - NG17 1DA

01623 554084 • [sutton@david-james.com](mailto:sutton@david-james.com) • [www.david-james.com](http://www.david-james.com)

These particulars are produced in good faith and are set out as a general guide only. Measurements are approximate and floor plans are for illustrative purposes only. Services have not been tested. We have established professional relationships with third-party suppliers for the provision of services to Clients, details of which can be found on the property listing page on our website.